

IMPORTANT:

Manufacturer is not responsible for negligent use of vehicle with mud flaps installed, including over-tightening of screws and bolts causing damage to vehicle or mud flaps.

NO-DRILL SYSTEM

TOOLS REQUIRED-



Phillips Screw Driver

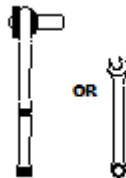

5/16" Open Wrench or
Socket Wrench

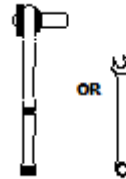

7/16" Open Wrench or
Socket Wrench

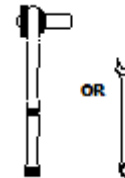

3/8" Open Wrench or
Socket Wrench

FLAPS AND BRACES

(1) Brace
Rear, DS
Part #766854

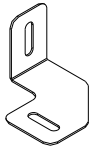

(1) Brace
Rear, PS
Part #766855

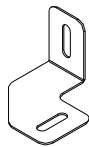

(1) Flap Assembly,
Front, DS
Part #766856

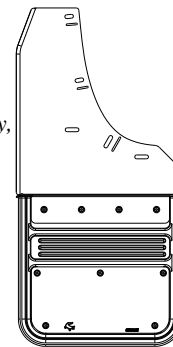

(1) Flap Assembly
Front, PS
Part #766857

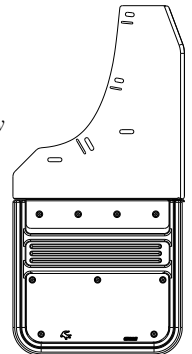

PARTS BAG #766858

a) (4) Screw, Mach.
#10 x 1", SS
Part #012022



b) (6) Capscrew
1/4"-20UNC x 1", SS
Part #014007



c) (4) Washer, Lock
18-8SS, #10 Helicoil
Part #024001



d) (4) Nut, Hex
#10, SS
Part #025003



d) (6) Washer, Flat
0.281" x 1", SS
Part #018028



e) (6) Washer, Flat
0.318" x 1", Nylon.
Part #054061



f) (8) Washer, Nylon
0.318" x 1" Black
Part #054071



g) (10) Washer, Flat
0.203" x 0.781", SS
Part #018018



i) (3) Mount Clip
Driver Side
Part #750582

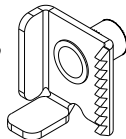

j) (3) Mount Clip
Passenger Side
Part #750584

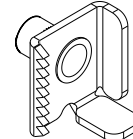

INSTALLATION (For ease of installation it is suggested that the wheel be removed)

1. Before you install your Mud Flap Set, see the diagram and parts list for all necessary parts. If applicable, cut the protective plastic and peel away from the stainless steel. Start on the driver's side.
2. Loosely install the brace through hole #6 to the inside of the flap through hole #5 using a machine screw (012036), a stainless steel flat washer (018018), and a black nylon washer (054071) and secure it with a black nylon washer (054071), stainless steel washer (018018) lock washer (024001), and hex nut (025003).



3. Install the mud flap clips to the rear side of the flap through holes #1 to #3 using a capscrew (014007), stainless steel washer (018028) and white nylon washer (054061).
4. Remove the factory screw located on the inner wheel well hole #8, as well as the factory push pin located on the under side of the plastic flare #9.
5. Place clips behind the lip of the plastic flare and pull into place.
6. Reinstall the factory screw with added stainless steel washer (018018) and black nylon washer (054071) through mud flap hole #4 into factory hole #8
7. Using a bubble level or square, ensure that the mud flap is level. Viewing the vehicle from the back, the outer edge of the mud flap should appear parallel to the tires.
8. Carefully tighten all fasteners. Ensure the flap has remained level.
9. Install the bracket to the underside of the fender flare through hole #9 using a machine screw (012022), stainless steel washer (018018), nylon washer (054071) and secure with stainless steel washer (018018), lock washer (024001) and hex nut (025003).
10. Repeat procedure on passenger side.

