

IMPORTANT:

Manufacturer is not responsible for negligent use of vehicle with mud flaps installed, including over-tightening of screws and bolts causing damage to vehicle or mud flaps.

TOOLS REQUIRED-

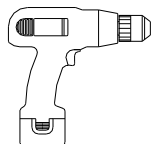

Electric or Rechargeable
Drill

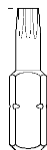

T15 Torx
Bit

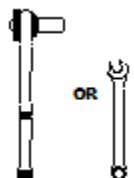

7/16" Open Wrench or
Socket Wrench

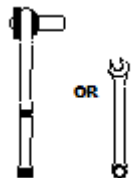

1/4" Open Wrench or
Socket Wrench

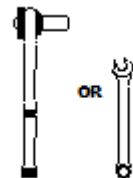

5/16" Open Wrench or
Socket Wrench

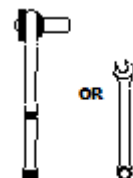

3/8" Open Wrench or
Socket Wrench

FLAPS AND BRACKETS

(1) Flap Assy
Rear, DS

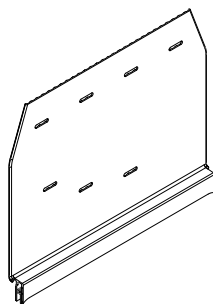

(1) Flap Assy
Rear, PS

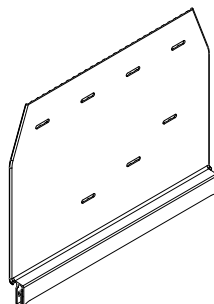

(2) Rubber Mud Flap Assembly
Universal

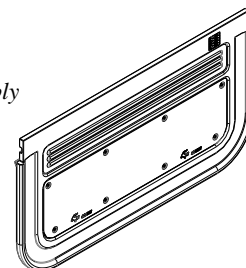

(1) Bracket
Rear, DS
Part #769324

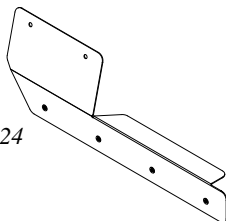

(1) Bracket
Rear, PS
Part #769325

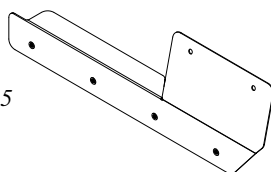

(2) Nylon Cap
Driver's Side
Part #080642

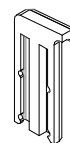

(2) Nylon Cap
Passenger Side
Part #080643

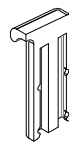

PARTS BAG # 769326

a) (8) Capscrew, SS Blk Ox.
1/4"-20UNC x 5/8"
Part #014071



b) (6) Screw, Sheet Metal, SS Blk Ox.
1/4" Hex Washer Head, #8-18x1"
Part # 016055



c) (4) Screw, Mach.
#10 x 1", SS
Part #012022

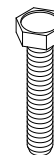

d) (8) Washer, Flat
0.281" x 1.5" 18g., SS Blk Ox.
Part #018079

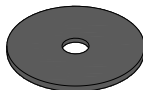

e) (8) Washer, Flat
0.203" x 1", 18g, SS, Blk Ox.
Part #018070

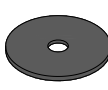

f) (6) Washer, Offset
0.203" x 1.5" x 18g, SS Blk Ox.
Part #018080



g) (4) Washer, Lock
18-8 SS
Part #024001



h) (4) Nut, Hex
#10-24, SS
Part #025003



ASSEMBLY OF MUD FLAPS:

1. Remove and discard the 2 plastic strips inside the track at the bottom of the nylon upper mount. (See Diagram #1).
2. Slide rubber guide into track of nylon upper mount.
3. Install included caps on bottom of nylon upper mount. To fully lock this cap into place, you should hear two clicks, and cap will be even with the offset part of the upper mount. (See Diagram #1).
4. Repeat Procedure for second mud flap.

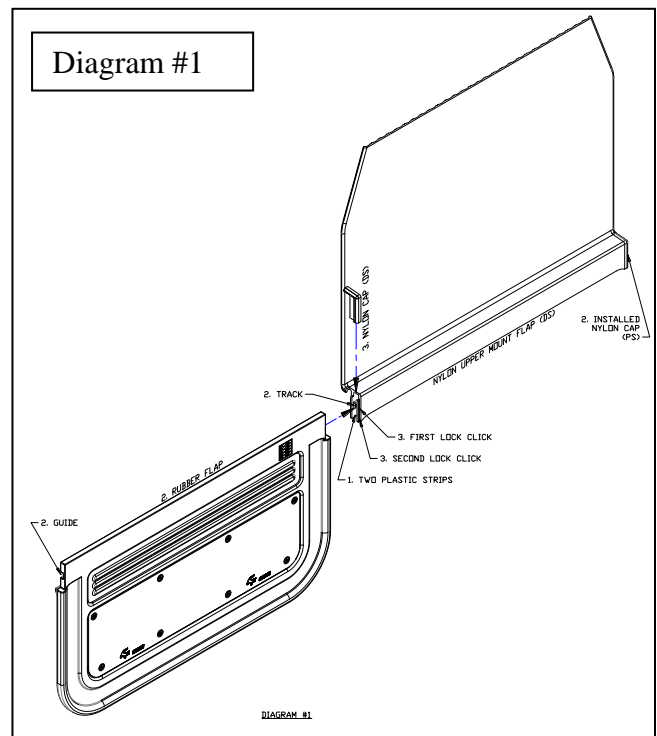

INSTALLATION *(For ease of installation it is suggested that the wheel be removed)*

1. Before you install your Mud Flap Set, see the diagram and parts list for all necessary parts. Start on the driver's side.
2. Remove the 3 factory screws from holes #14 to #16 and discard.
3. Install the bracket between the wheel lip and the flare and loosely secure bracket holes #12 & #13 to factory holes #17 & #18 using a #10 bolt (c) and flat washer (e) and secure using a flat washer (e), lock washer (g), and hex nut (h).
4. Loosely install mud flap holes #1 to #4 to bracket holes #8 to #11 using a capscrew (a) and flat washer (d).
5. Loosely install center mud flap holes #6 & #7 into factory hole #15 & #16 using a sheet metal screw (b) and offset flat washer (f) install through center hole.
6. Loosely install outside mud flap hole #5 into factory hole #14 using a sheet metal screw (b) and offset washer (f) installed through the outside hole with the rest of the washer facing the outside edge of the flap.
7. Using a square or other levelling tool, ensure that the flap is level
8. Carefully tighten all fasteners without over tightening. Ensure that the mud flap is still level.
9. Repeat on passenger side.

Please check out our YouTube channel to see an install video for this application.



Diagram #2

