

**IMPORTANT:**

*Manufacturer is not responsible for negligent use of vehicle with mud flaps installed, including over-tightening of screws and bolts causing damage to vehicle or mud flaps.*

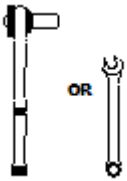

**TOOLS REQUIRED-**



5/16" Open Wrench  
or Socket Wrench

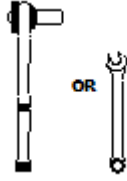

3/8" Open Wrench  
or Socket Wrench



T15 Torx  
Bit



1/4" Socket Driver



1/4" Drill  
Bit

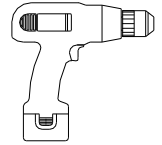

Electric or Rechargeable  
Drill

**FLAPS**

(1) Flap Assy  
Front, DS

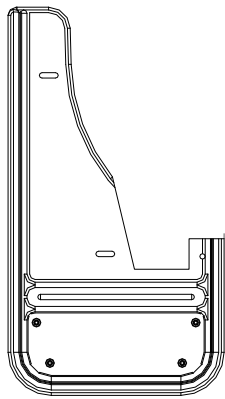

(1) Flap Assy  
Front, PS

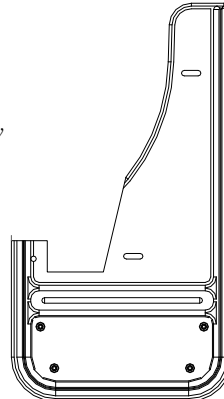

**PARTS BAG # 770198**

**a)** (4) Sht Metal Screw Blk Ox.  
1/4" Hex Head, #8-18 x 1.5"  
Part #016063



**b)** (2) Machine Screw  
18-8, 10-24 x 1", SS  
Part #012022

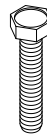

**c)** (4) Washer, Offset  
0.203" x 1.5", 18g, SS, Blk. Oxid.  
Part #018080



**d)** (4) Washer, Spacer  
1/8" Nylon  
Part #054076

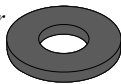

**e)** (4) Washer Flat  
0.203" x 0.781" SS  
Part #018018

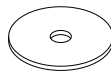

**f)** (2) Washer, Lock  
18-8 SS, 10  
Part #024001



**g)** (2) Hex Nut  
#10-24  
Part #025003



## INSTALLATION:

1. Before you install your Mud Flap Set, see the diagram and parts list for all necessary parts. Start on the driver's side.
2. Remove the two factory screws from wheel well holes #4 & #5 and discard.
3. Ensuring that the mud flap ear is tucked behind the factory liner, loosely install mud flap hole #2 to factory hole #5 using sheet metal screw (a) and offset washer (c) with the screw installed through the center hole and placing a spacer washer (d) between the rubber and the factory hole.
4. Loosely install mud flap hole #1 to factory hole #4 using a sheet metal screw (a) and offset washer (c) with the screw installed through the center hole and placing a spacer washer (d) between the rubber and the factory hole.
5. Using a bubble level or square, ensure that the mud flap is level, then tighten all fasteners.
6. Drill a 1/4" hole through mud flap hole #3 into the factory liner.
7. Install mud flap hole #3 to newly drilled hole in the liner using a machine screw (b) and flat washer (e), and secure using a flat washer (e), lock washer (f) and hex nut (g).
8. Repeat the procedure for the passenger side.

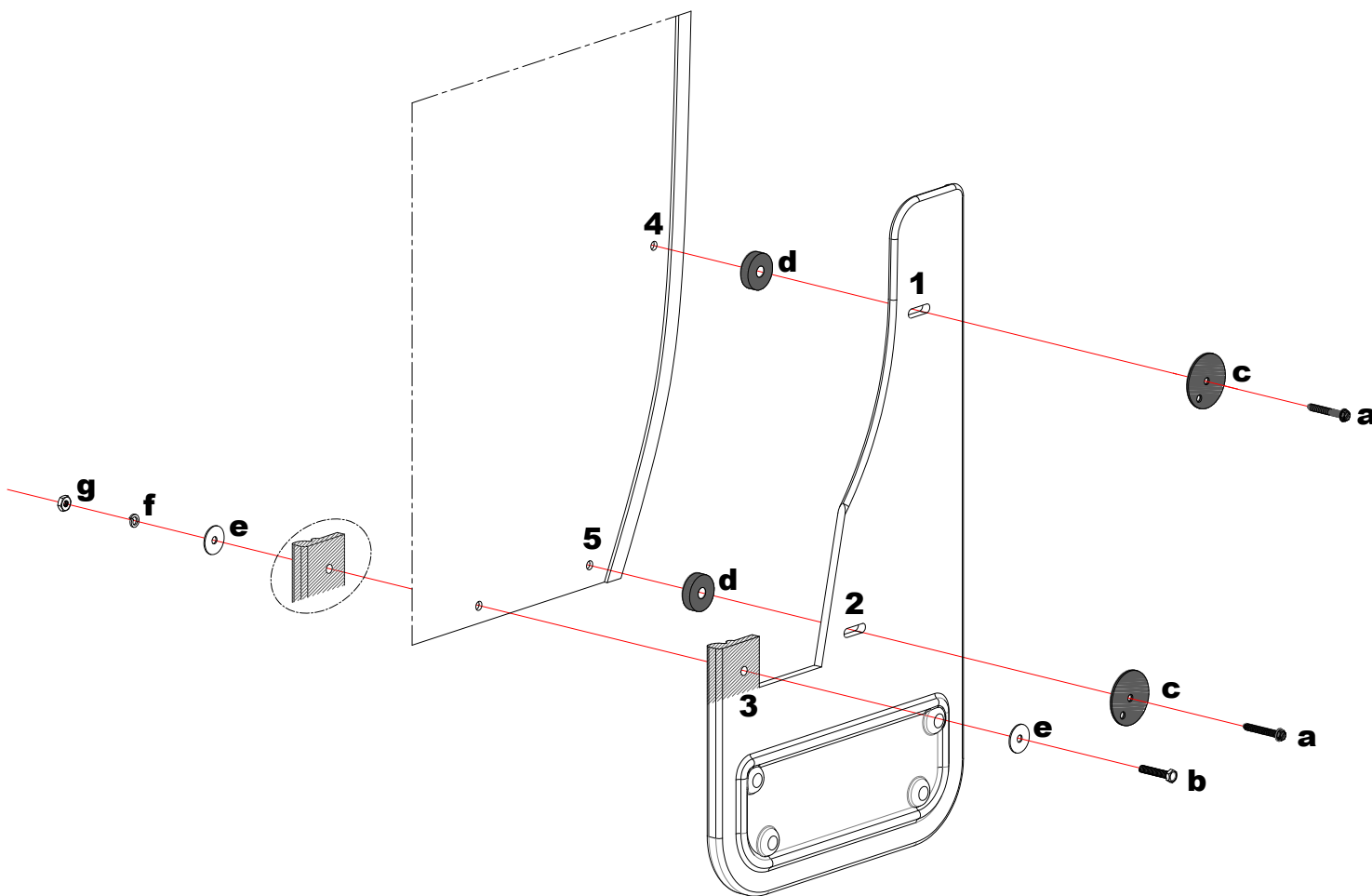

Please check out our YouTube channel to see an install video for this application.



**IMPORTANT:**

*Manufacturer is not responsible for negligent use of vehicle with mud flaps installed, including over-tightening of screws and bolts causing damage to vehicle or mud flaps.*



**TOOLS REQUIRED-**

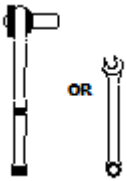

5/16" Open Wrench  
or Socket Wrench

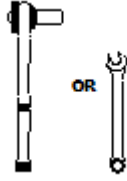

3/8" Open Wrench  
or Socket Wrench



T15 Torx  
Bit



1/4" Socket Driver

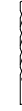

1/4" Drill  
Bit

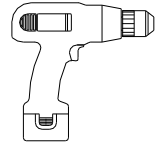

Electric or Rechargeable  
Drill

**FLAPS**

(1) Flap Assy  
Front, DS

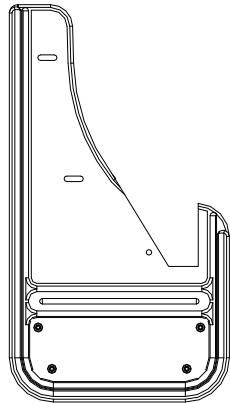

(1) Flap Assy  
Front, PS

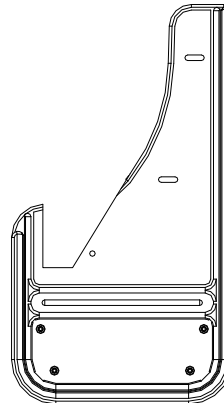

**PARTS BAG # 770199**

a) (4) Sht Metal Screw Blk Ox.  
1/4" Hex Head, #8-18 x 1.5"  
Part #016063



b) (2) Machine Screw  
18-8, 10-24 x 1", SS  
Part #012022

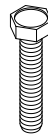

c) (4) Washer, Offset  
0.203" x 1.5", 18g, SS, Blk. Oxid.  
Part #018080



d) (4) Spacer, Nylon  
1/2" Nylon  
Part #054063



e) (8) Washer Flat  
0.203" x 0.781" SS  
Part #018018

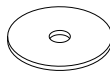

f) (2) Washer, Lock  
18-8 SS, 10  
Part #024001



g) (2) Hex Nut  
#10-24  
Part #025003



## INSTALLATION:

2. Before you install your Mud Flap Set, see the diagram and parts list for all necessary parts. Start on the driver's side.
2. Remove the two factory screws from wheel well holes #4 & #5 and discard.
3. Loosely install mud flap hole #2 to factory hole #5 using sheet metal screw (a) and offset washer (c) with the screw installed through the center hole and placing a flat washer (e), and a nylon spacer (d) between the rubber and the factory hole.
4. Tuck the ear of the mud flap behind the liner.
5. Loosely install mud flap hole #1 to factory hole #4 using a sheet metal screw (a) and offset washer (c) with the screw installed through the outside hole and placing flat washer (e), and a spacer nylon spacer (d) between the rubber and the factory hole.
6. Position the offset washer on hole #1 so that the largest portion of the washer is angled toward the top of the mud flap, and tighten the screw.
7. Using a bubble level or square, ensure that the mud flap is level, then tighten all fasteners.
8. Drill a 1/4" hole through mud flap hole #3 into the factory liner.
9. Install mud flap hole #3 to newly drilled hole in the liner using a machine screw (b) and flat washer (e), and secure using a flat washer (e), lock washer (f) and hex nut (g).
10. Repeat the procedure for the passenger side.

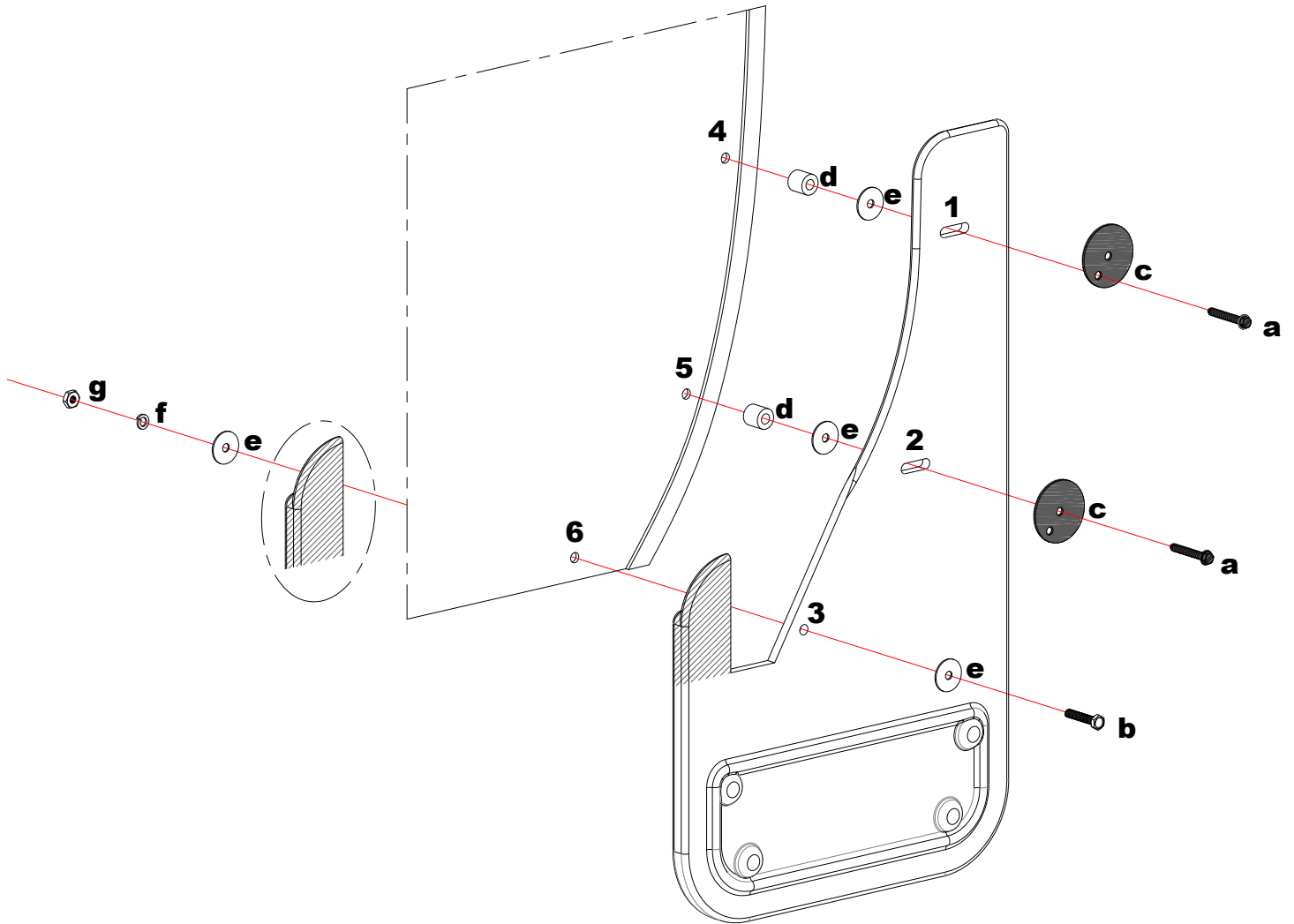

Please check out our YouTube channel to see an install video for this application.

