

IMPORTANT:

Manufacturer is not responsible for negligent use of vehicle with mud flaps installed, including over-tightening of screws and bolts causing damage to vehicle or mud flaps.

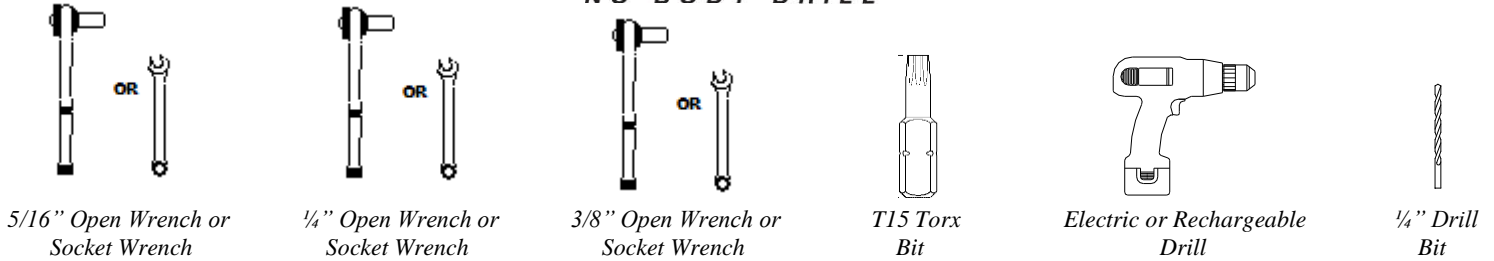

TOOLS REQUIRED-



FLAPS

(1) Flap Assembly, Front, DS

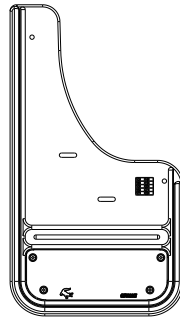

(1) Flap Assembly Front, PS

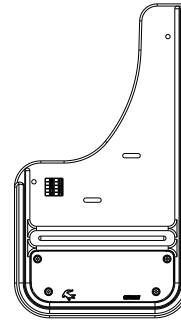

PARTS BAG # 766663

a) (4) Washer, Flat
0.203" x 1.5", 18GA, SS
Part #018066

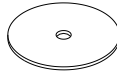

b) (4) Washer, Flat, SS
0.203" ID x 1" OD, 18ga
Part #018081



c) (2) Washer, Lock
18-8SS, Helicoil
Part #024001



d) (4) Washer, Rubber
1/4" ID x 1" OD x 1/4" Thk
Part #080677



e) (2) Screw, Mach.
18-8SS, 10-24x1, Hex Hd
Part # 012022



f) (2) Nut, Hex
#10-24, SS
Part # 025003

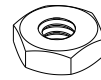

g) (4) Screw, Sht Metal
#8-18 x 1.5", 1/4" Hex Head
Part #016047



h) (2) Fender Clip
Front
Part #766662

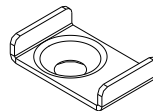

i) (4) Spring Nut
#8, 9/16" Reach
Part #028004

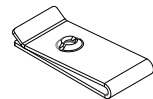

INSTALLATION (For ease of installation it is suggested that the wheel be removed)

1. Before you install your Mud Flap Set, see the diagram and parts list for all necessary parts. Start on the driver's side.
2. Remove the 2 factory screws from the fender and discard the plastic guard. Then remove the factory spring nuts from behind holes #5 & #6 and replace with provided spring nut (028004).

3. Install a factory screw through the top hole #1 of the mud flap, onto the fender clip (766662).
4. Using two supplied screws (016047), two flat washers (018066), and two rubber washers (080677) install mud flap through holes #2 & #3 into existing factory holes #5 & #6
5. Slide the Fender clip behind the fender lip. (See diagram).
6. Using a bubble level or square, ensure that the mud flap is level. Viewing the vehicle from the back, the outer Edge of the mud flap should appear parallel to the tires.
7. Drill a ¼" hole through mud flap hole #4 into the fender liner, creating hole #7
8. Install one machine screw (012022), and one flat washer (#018081) through hole #4 into hole #7 and secure with one flat washer (018081), one lock washer (024001) and one hex nut (025003)
9. Carefully tighten all fasteners and ensure that the flap has remained level.
6. Repeat procedure for the passenger side.

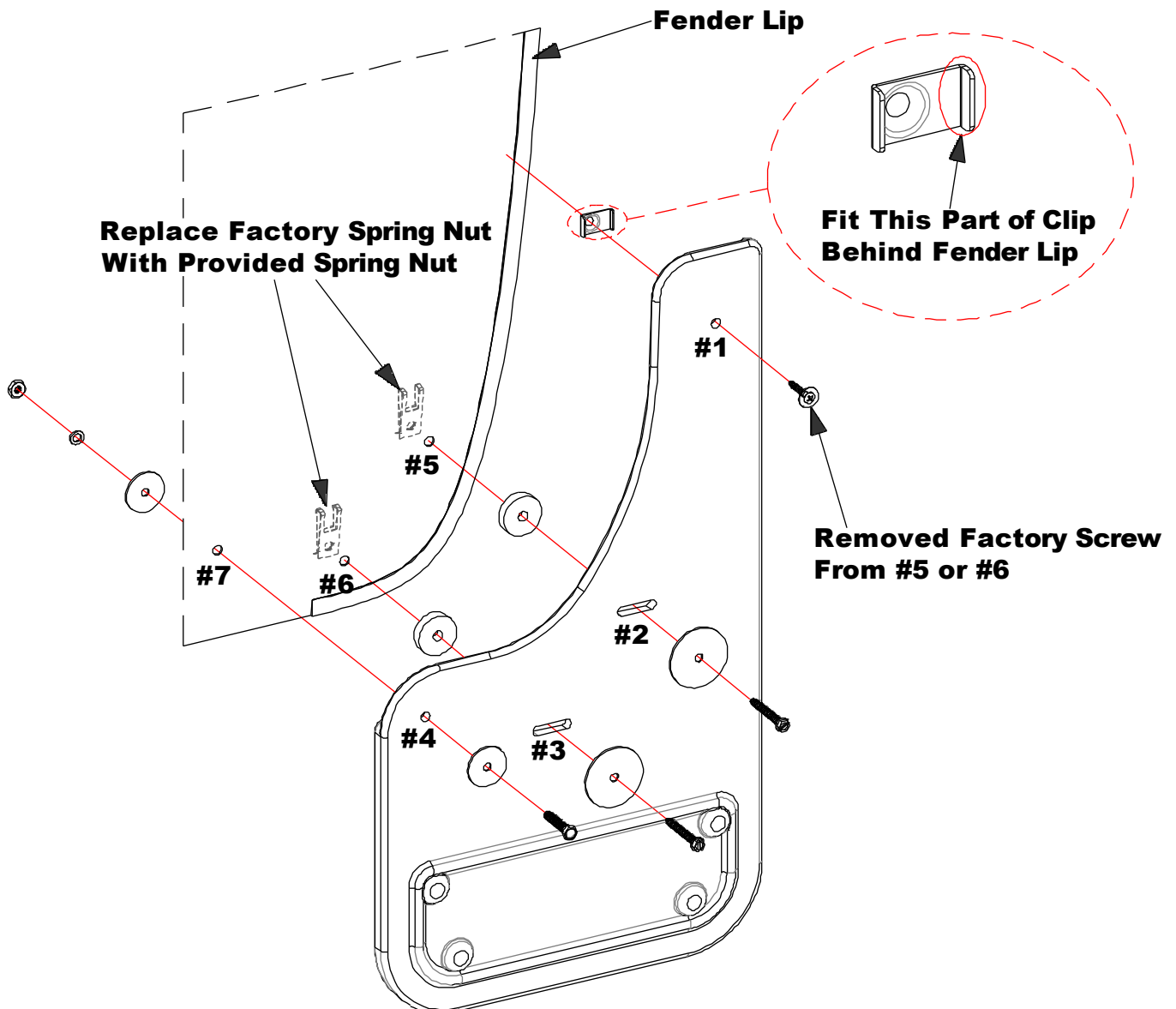

Please check out our YouTube channel to see an install video for this application.





2018-24 Buick Enclave
Mud Flap Set, Rear
Mounting Diagram & Instructions
Kit # GRC22R
 766668/766679

IMPORTANT:

Manufacturer is not responsible for negligent use of vehicle with mud flaps installed, including over-tightening of screws and bolts causing damage to vehicle or mud flaps.



TOOLS REQUIRED-

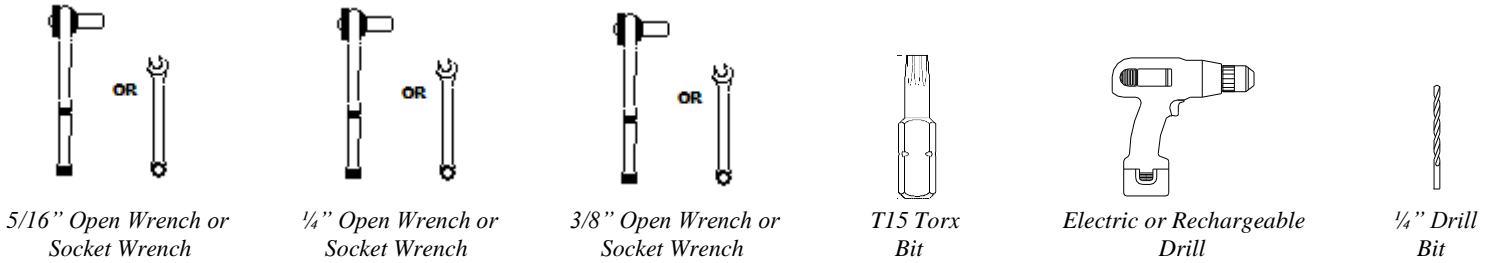

FLAPS

(1) Flap Assembly, Front, DS

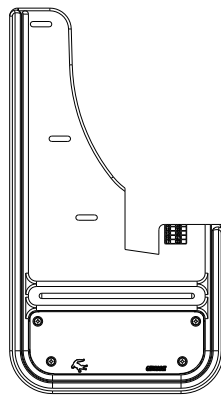

(1) Flap Assembly Front, PS

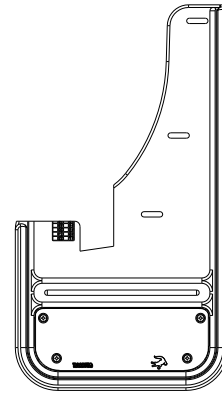

PARTS BAG # 766673

a) (8) Spacer, Nylon
 1/2" OD x 0.257" ID x 0.50" Thick
 Part #054063



b) (16) Washer, Flat, SS
 0.203" ID x 1" OD, 18ga
 Part #018081



c) (2) Washer, Lock
 18-8SS, Helicoil
 Part #024001



e) (2) Screw, Mach.
 #10-24 x 1-1/2", Hex Hd
 Part # 012027



f) (2) Nut, Hex
 #10-24, SS
 Part # 025003



g) (6) Screw, Sht Metal
 #8-18 x 1.5", 1/4" Hex Head
 Part #016047



h) (6) Spring Nut
 #8, 9/16" Reach
 Part #028004

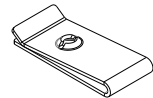

INSTALLATION (For ease of installation it is suggested that the wheel be removed)

- Before you install your Mud Flap Set, see the diagram and parts list for all necessary parts. Start on the driver's side.
- Remove the 3 factory screws from the fender. Remove the factory spring nuts from behind holes #5 to #7 and replace with supplied spring nuts (028004).
- Loosely install mud flap through hole #3 into hole #7 using a sheet metal screws (#016047), two flat washers (#018081), and a nylon spacer (#054063).



4. Ensure that the innermost part of the flap tucks behind the liner as shown in Diagram "B".
5. Repeat Step 3 for hole #2, and then for hole #1.
6. Using a bubble level or square, ensure that the mud flap is level. Viewing the vehicle from the back, the outer Edge of the mud flap should appear parallel to the tires. *Note: You may be required to cut the liner in order to allow for proper levelling of the flap*
7. Carefully tighten all fasteners and ensure that the flap has remained level.
8. Drill a ¼" hole through the mud flap (#4) and the liner (#8).
9. Secure mud flap to liner using a machine screw (#012027), two flat washers (#018081), one nylon spacer (#054063), one lock washer (#024001), and one hex nut (#025003).
10. Repeat procedure for the passenger side.

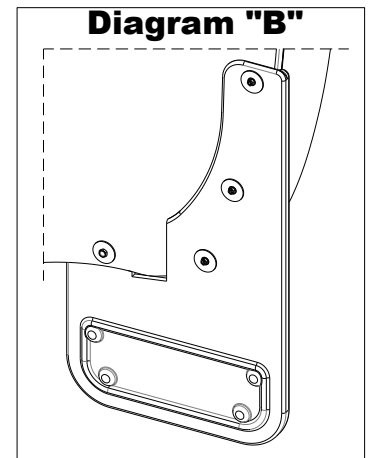
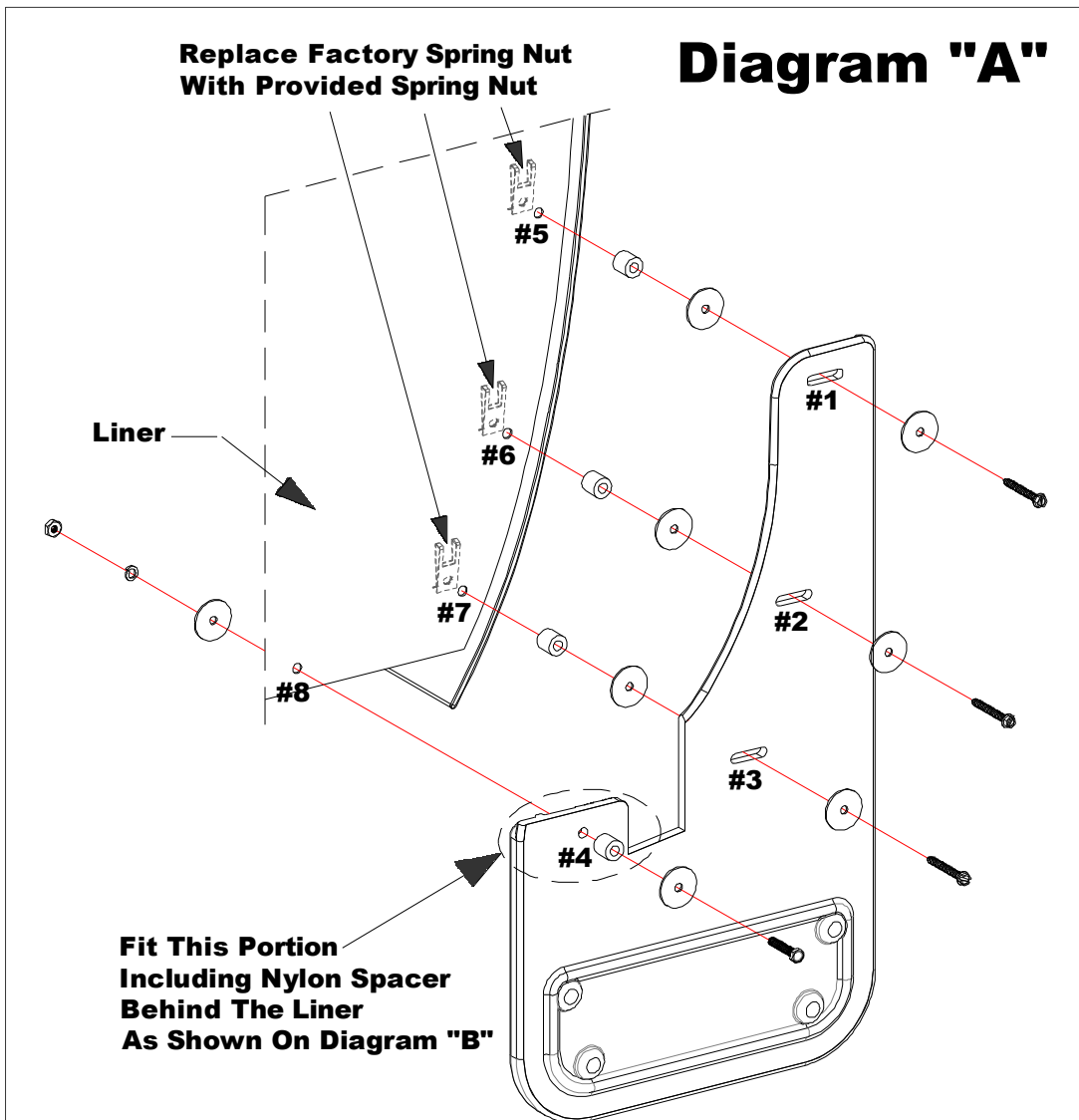

Please check out our YouTube channel to see an install video for this application.

