

IMPORTANT:

The manufacturer is not responsible for negligent use of vehicle with mud flaps installed, including over-tightening of screws and bolts causing damage to vehicle or mud flaps.

TOOLS REQUIRED:

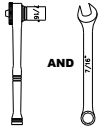

1/4" open wrench
and socket wrench

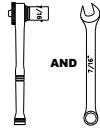

7/16" open wrench
and socket wrench



1/4" Drill Bit

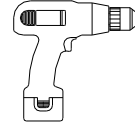

Electric or
Rechargeable Drill

BRACKETS AND FLAPS

(1) Flap Assembly
Driver's Side

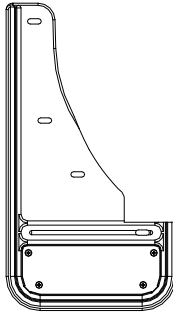

(1) Flap Assembly
Passenger Side

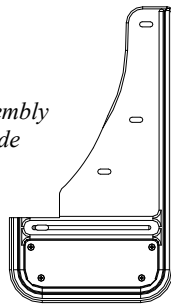

(2) Bracket,
Universal
Part #770271

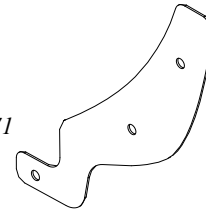

PARTS BAG #770276

A) (2) Screw, Sheet Metal
#8-18 x 1", SS Blk Ox.
Part #016055



B) (4) Screw, Sheet Metal
#8-18 x 1.25", SS Blk Ox
Part #016061



C) (4) Capscrew, Blk Oxid
SS, 1/4"-20UNC x 1"
Part #014073

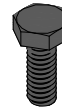

D) (2) Washer, Offset
0.203" x 1.5" SS, Blk Ox.
Part #018080

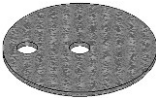

E) (2) Washer, Flat
0.203" x 1" SS Blk Ox.
Part #018070

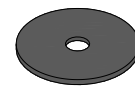

F) (2) Washer, Nylon
0.203" x 1"
Part #054080



G) (4) Washer, Nylon
0.281" x 0.885"
Part #054089

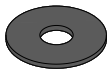

H) (2) Washer, Flat
0.281" x 1", SS
Part #018068

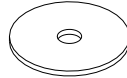

I) (2) Washer, Lock
SS, 1/4" Helicoil Spring
Part #024000



J) (2) Nut, Hex
SS, 1-4" x 20UNC
Part #025000



K) (2) Spring Nut
1/4"-20 UNC 27/32" Reach
Part #028010



L) (2) Z Bracket
Part #770272

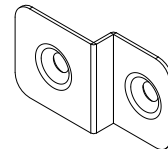

M) (2) J Bracket
Part #770273

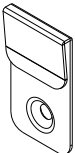

INSTALLATION

For ease of installation, it is suggested that the wheel be removed.

1. Before you install your Mud Flap set, see the diagram and parts list for all necessary parts. Start on the driver's side.
2. Remove 3 lowest push pins from factory holes and pull back the liner to expose factory holes.
3. Install "j" bracket (m) on bottom factory hole, with the long end behind the fender (See Diagram # 1)
4. Install spring nut (k) on middle factory hole (See Diagram #2)

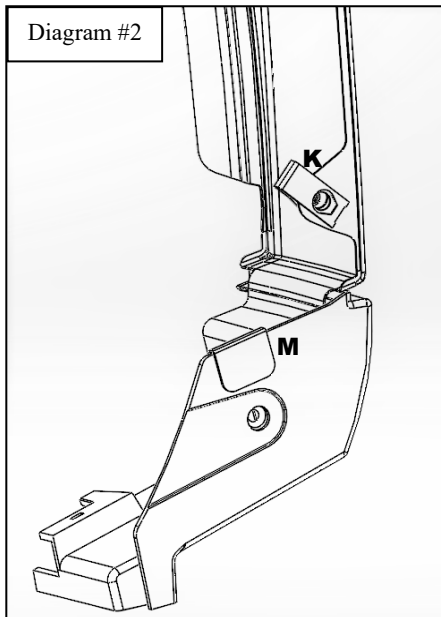
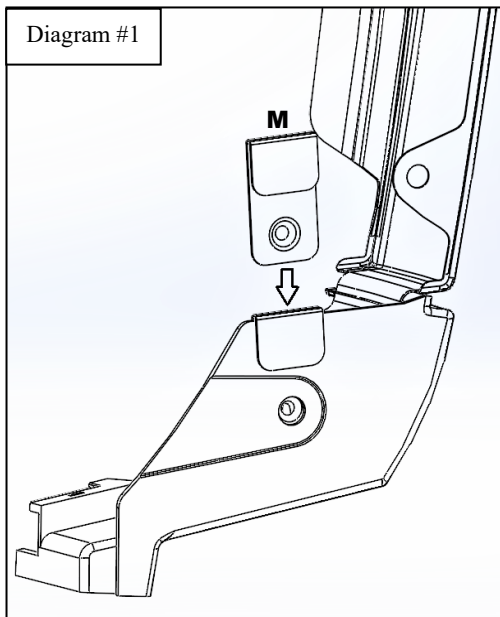

5. Install "z" bracket (l) through hole L-1 behind upper factory hole using a screw (a) and flat washer (e). (See Diagram #3)

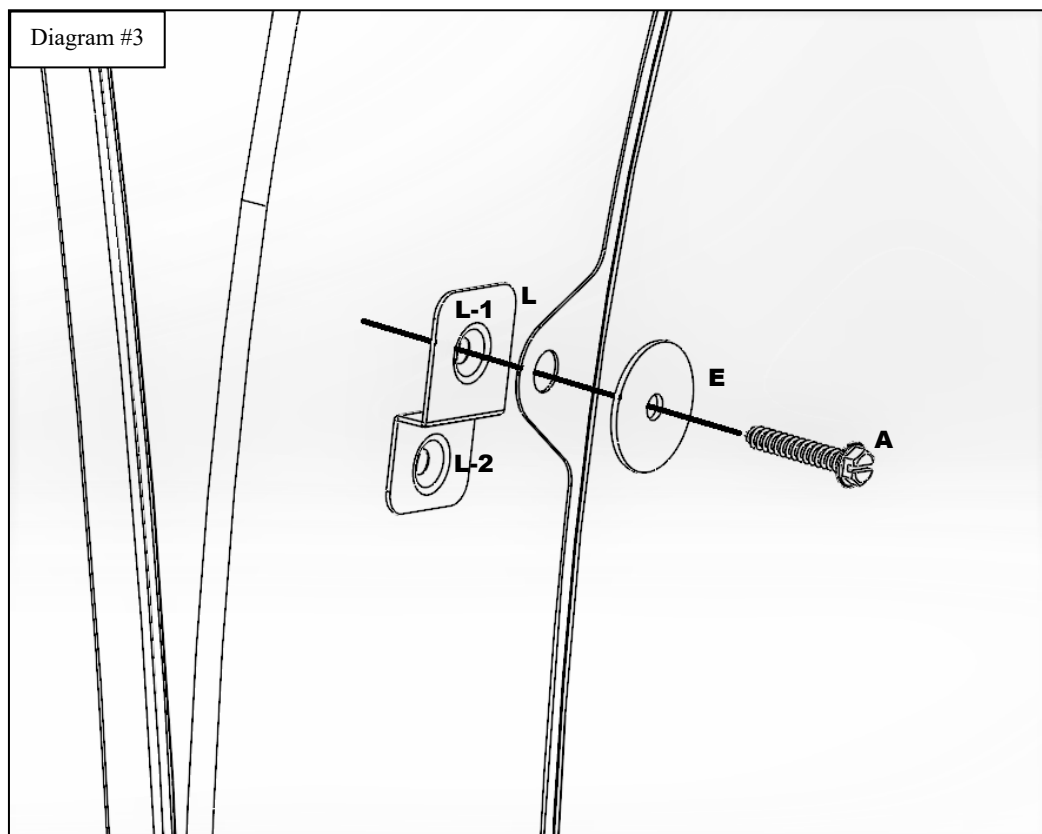

6. Measure the distance between the holes on the “z” bracket (l). Once this measurement is confirmed, measure that same distance down from the existing hole in the factory liner and mark using a felt marker. Drill a 1/4” hole in the factory liner where you’ve marked it. Place the factory liner back over the clip. The factory hole in the liner should align with the sheet metal screw (a) installed on hole L-1 of the “z” clip (l) in the previous step.
7. Install bracket hole #5 through mud flap hole #2 into spring nut (k) using a capscrew (c) and nylon washer (g). (See Diagram #4)
8. Install bracket hole #6 through mud flap hole #3 into “j” bracket (m) using a sheet metal screw (b) and nylon washer (f). (See Diagram #4)
9. Install mud flap hole #1 through the hole drilled in the liner in step 6 and into hole L-2 of “z” bracket (n) using a sheet metal screw (b) and offset washer (d). (See Diagram #4)
10. Install bracket hole #7 to mud flap hole #4 using a capscrew (c) and nylon washer (g) and secure using a flat washer (h), lock washer (i), and hex nut (j). (See Diagram #4)
11. Using a square or other leveling tool, ensure that the mud flap is level.
12. Tighten all fasteners.
13. Repeat procedure for passenger side.

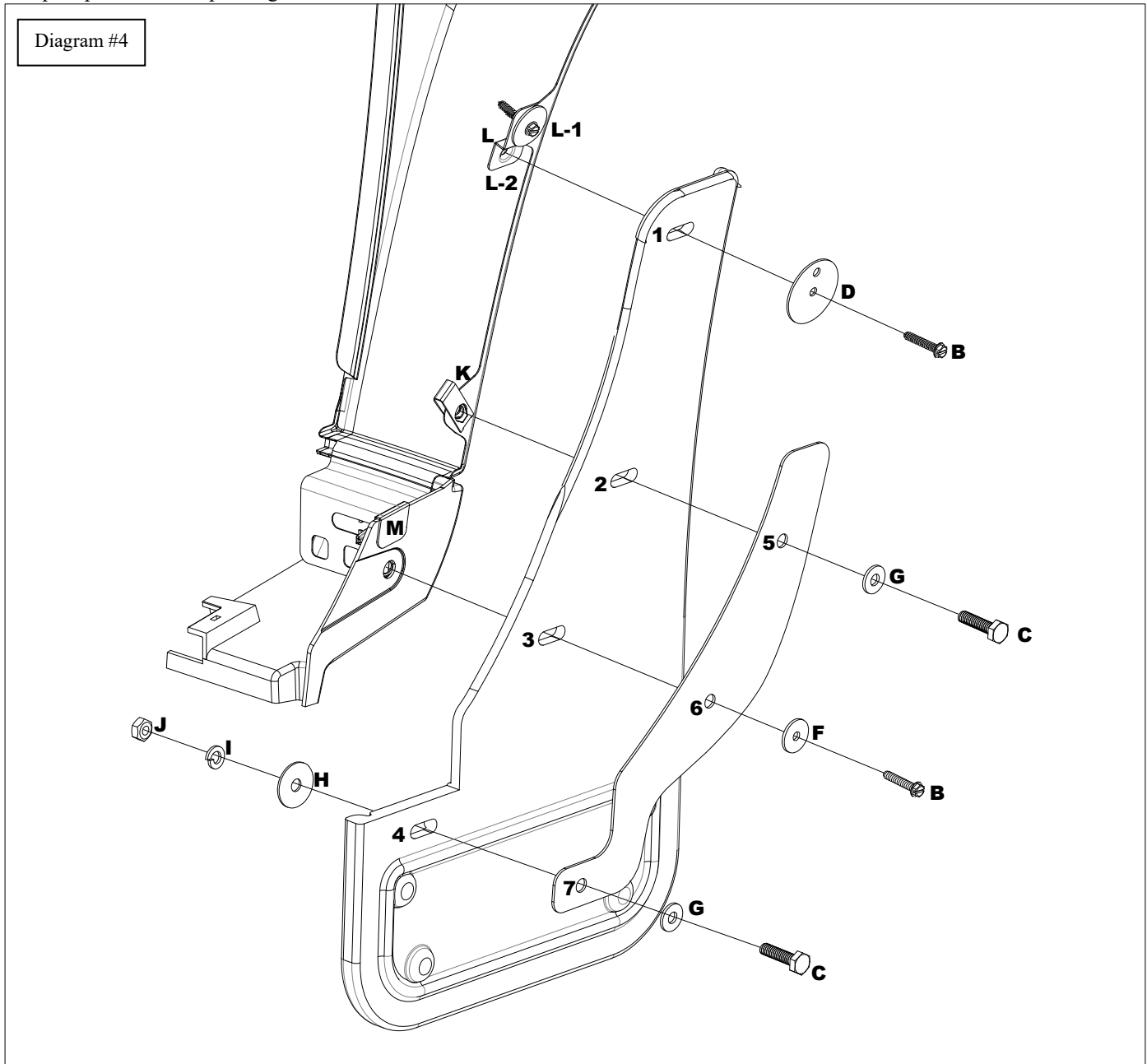

Please check out our YouTube channel to see an install video for this application. 



2022-C Maverick Mud Flap Set, Rear Mounting Diagram & Instructions GCR409R

IMPORTANT:

The manufacturer is not responsible for negligent use of vehicle with mud flaps installed, including over-tightening of screws and bolts causing damage to vehicle or mud flaps.

TOOLS REQUIRED:

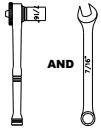

*1/4" open wrench
and socket wrench*

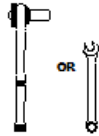

*7/16" open wrench
or socket wrench*

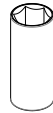

7mm Socket

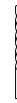

1/4" Drill Bit

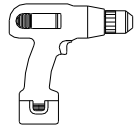

*Electric or
Rechargeable Drill*

BRACKETS AND FLAPS

*(1) Flap Assembly
Driver Side*

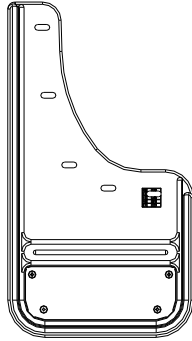

*(1) Flap Assembly
Passenger Side*

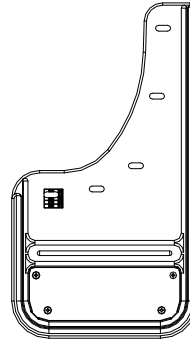

*(1) "L" Bracket
Driver Side
Part #770274*

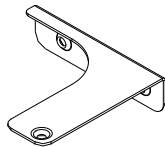

*(1) "T" Bracket
Passenger Side
Part #770275*

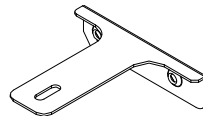

PARTS BAG #770277

*A) (2) Capscrew, Blk Oxid
SS, 1/4"-20UNC x 1"
Part #014073*

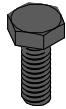

*B) (9) Screw, Sheet Metal
#8-18 x 1.25" SS, Blk Oxid.
Part #016061*



*C) (2) Washer, Offset
0.281" x 1.5" SS, Blk Ox.
Part #018087*

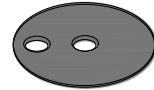

*D) (9) Washer, Flat
0.203" x 1" SS, Blk Ox.
Part #018070*

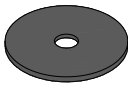

*E) (1) Washer, Nylon
0.203" x 0.885"
Part #054080*

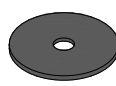

*F) (2) Spring Nut
1/4"-20 UNC 0.54" Reach
Part #028010*



Please check out our YouTube channel to see an install video for this application.



INSTALLATION

For ease of installation, it is suggested that the wheel be removed.

1. Before you install your Mud Flap set, see the diagram and parts list for all necessary parts. Start on the driver's side.
2. Remove 2 factory screws and 2 factory push pins from factory holes #6 to #9. Note: Factory push pin from hole #6 will be reinstalled in a later step. (See Diagram #1)
3. Install spring nut (f) on factory hole #7. (See Diagram #1)
4. Loosely install mud flap holes #4 & #5 to bracket holes #10 & #11 using a sheet metal screw (b) and a flat washer (d). (See Diagram #1)
5. Loosely install mud flap hole #1 to spring nut (f) on factory hole #7 using a capscrew (a) and offset washer (c). (See Diagram #1)
6. Loosely install mud flap holes #2 & #3 to factory holes #8 & #9 using a sheet metal screw (b) and flat washer (d). (See Diagram #1)

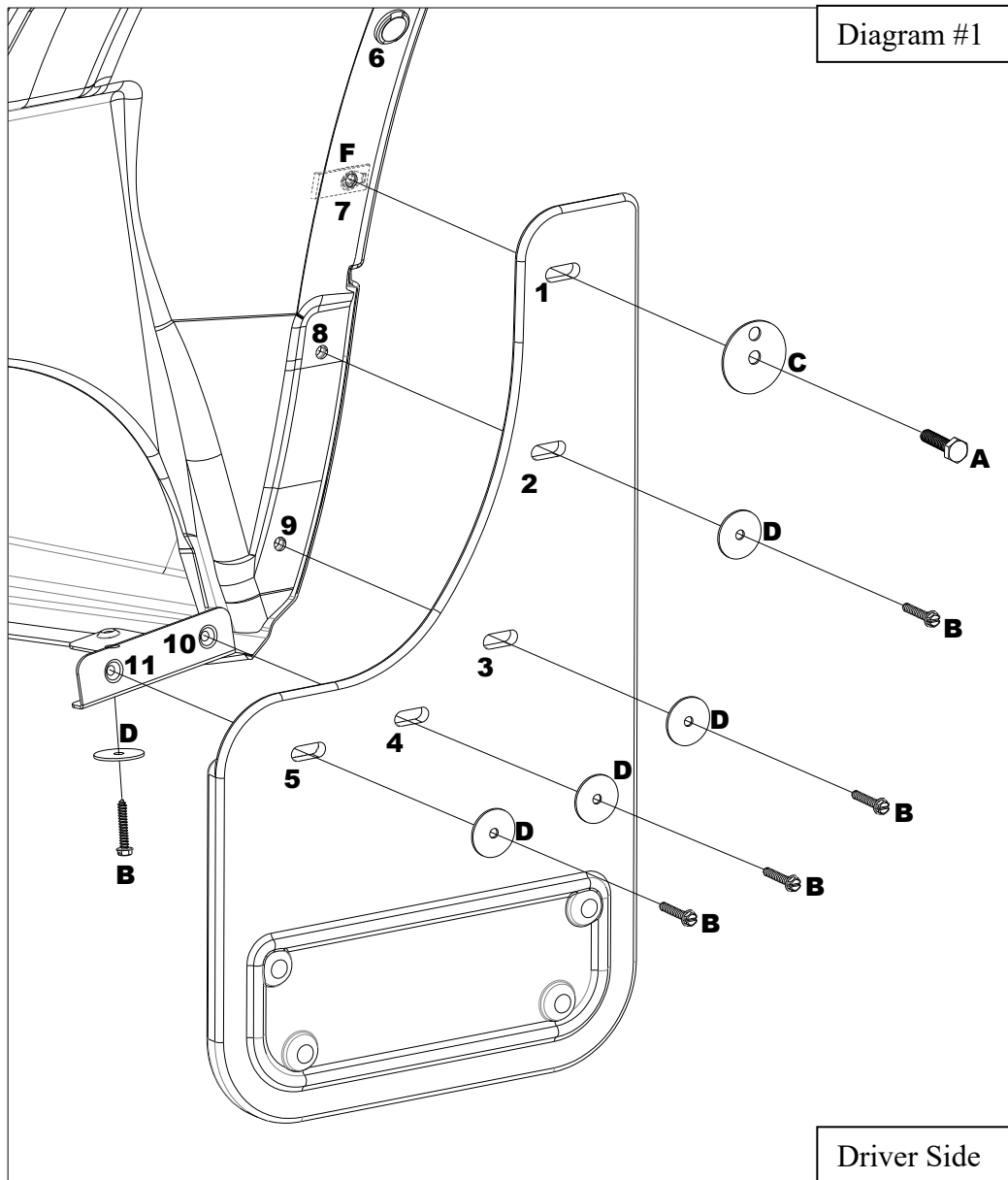

7. Tighten capscrew (a) on mud flap hole #1.
8. Using a square or other levelling tool, ensure that the flap is level.
9. Tighten fasteners on mud flap holes #2 & #3.

10a. For driver's side: Align bracket hole #12 on the plastic edge on the underside of the vehicle. Mark the plastic where bracket hole #12 sits, then drill a 1/4" hole through the marked spot on the plastic. Install bracket hole #12 to newly drilled hole using a sheet metal screw (b) and flat washer (d). (See Diagram #2a)

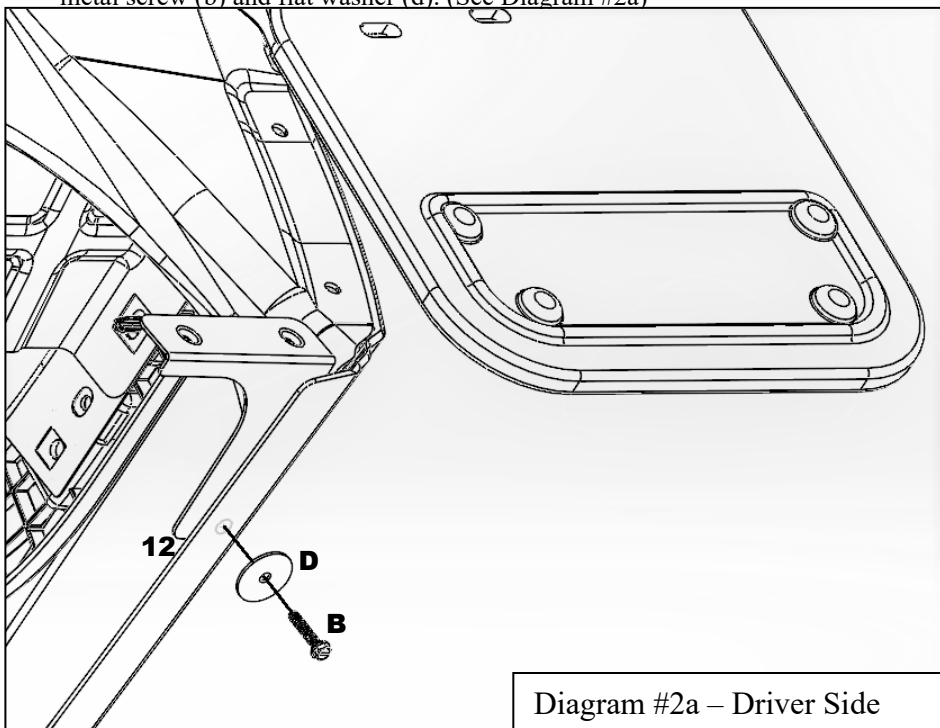

10b. For passenger side: Remove factory screw from underside of fender and install bracket hole #12 to factory hole using the factory screw and provided nylon washer (e). (See Diagram #2b)

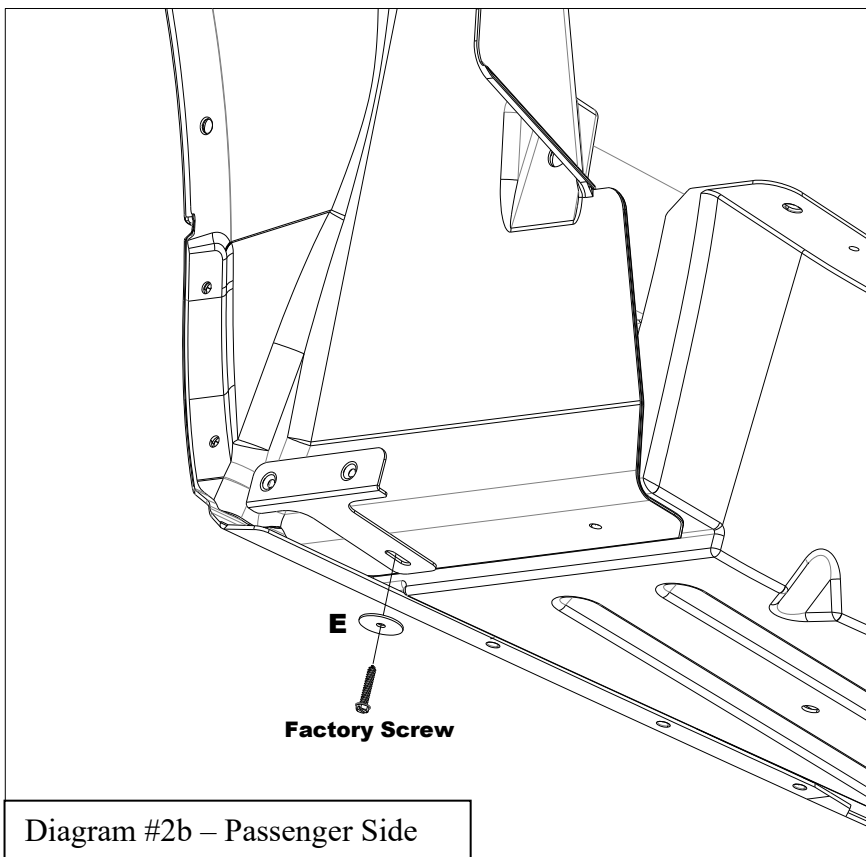

11. Tighten fasteners on mud flap holes #4 & #5, ensuring the mud flap remains level.
12. Reinstall factory push pin on factory hole #6.

Please check out our YouTube channel to see an install video for this application.

