



# 2022 Ford F-150 Lightning Mud Flap Set, Front Mounting Diagram & Instructions GCR411F

## IMPORTANT:

Manufacturer is not responsible for negligent use of vehicle with mud flaps installed, including over-tightening of screws and bolts causing damage to vehicle or mud flaps.



## TOOLS REQUIRED-



Push Pin  
Removal Tool

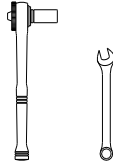

7/16" Open Wrench  
and Socket Wrench

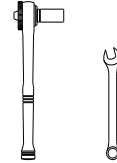

1/4" Open Wrench  
or Socket Wrench

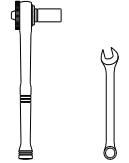

10mm Open Wrench  
or Socket Wrench

## FLAPS AND BRACKETS

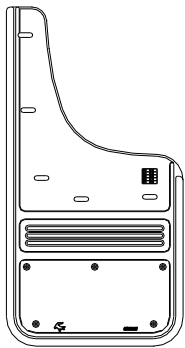

(1) Flap  
Front, DS

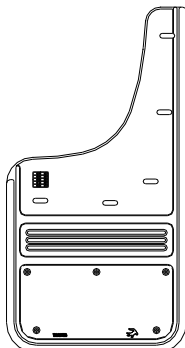

(1) Flap  
Front, PS

(1) Protective Tape  
Part #769914

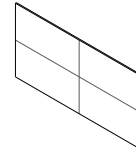

(1) Bracket  
Front, DS  
Part #769803

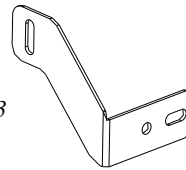

(1) Bracket  
Front, PS  
Part #769804

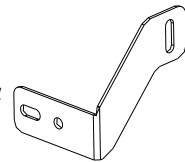

## PARTS BAG # 769808

a) (4) Capscrew, Blk Oxid.  
SS, 1/4"-20UNC x 3/8"  
Part #014069



b) (2) Capscrew, Blk Oxid.  
SS, 1/4"-20UNC x 1"  
Part #014073



c) (2) Capscrew, Blk  
SS, 1/4"-20UNC x 1.5  
Part #014074



d) (4) Screw, Sht Mtl.  
#8-18 x 1" Blk Ox.  
Part #016055

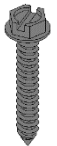

e) (6) Washer, Flat,  
1"OD, SS, Blk Ox.  
Part #018069

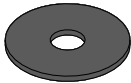

f) (2) Washer, Flat  
0.281" x 1" SS  
Part #018068

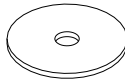

g) (4) Washer, Flat  
0.203" x 1" Blk Ox.  
Part #018070

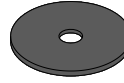

h) (4) Washer, Flat  
0.281" x 0.781", SS  
Part #018088

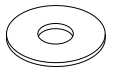

i) (4) Washer, Nylon  
0.318" x 1" x 0.04"  
Part #054061

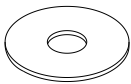

j) (2) Washer, Nylon  
0.265" x 0.625" x .06"  
Part #054071



k) (4) Washer, Nylon  
0.281" x 0.885" x 0.062"  
Part #054089

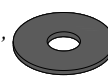

l) (2) Washer, Half  
5/16" x 1" x 1/4" HDPE  
Part # 054090



m) (6) Washer, lock  
1/4" Helicoil, SS  
Part #024000



n) (4) Hex Nut  
1/4"-20, SS  
Part #025000

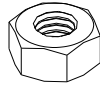

p) (2) Hex Nut  
M6-1, SS  
Part #025022



q) (4) Spring Nut  
1/4"-20UNC, 0.84" Reach  
Part #028010



r) (2) "J" Washer Strip  
Universal  
Part #769802

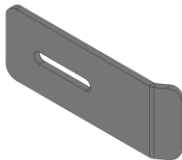

## INSTALLATION *(For ease of installation it is suggested that the wheel be removed)*

1. Before you install your Mud Flap Set, see the diagram and parts list for all necessary parts.
2. Remove the two factory screws from the factory guard in the wheel well.
3. Remove the push pin from the underside of the guard. This push pin is holding the portion of the guard protecting the push pin. It may be difficult to remove from the side facing you. We suggest going between the guard and the pinch weld to separate them so that you can push out the push pin from behind.
4. Once the push pin is removed, reinstall the guard into position with the existing tab.
5. Install capscrew (c) through a nylon washer (j) into factory hole #1 and insert a half washer (l) and the bracket hole #3 onto the protruding part of the screw, ensuring that bracket hole #2 is installed on factory bolt (see Diagrams #1 & #2).
6. Secure bracket hole #2 to factory bolt using a nylon washer (k), flat washer (h), lock washer (m), and M6-1 hex nut (p) (See Diagram #2).
7. Secure bracket hole #3 to capscrew (c) using a nylon washer (k), flat washer (h), lock washer (m), and hex nut (n) (See Diagram #2).

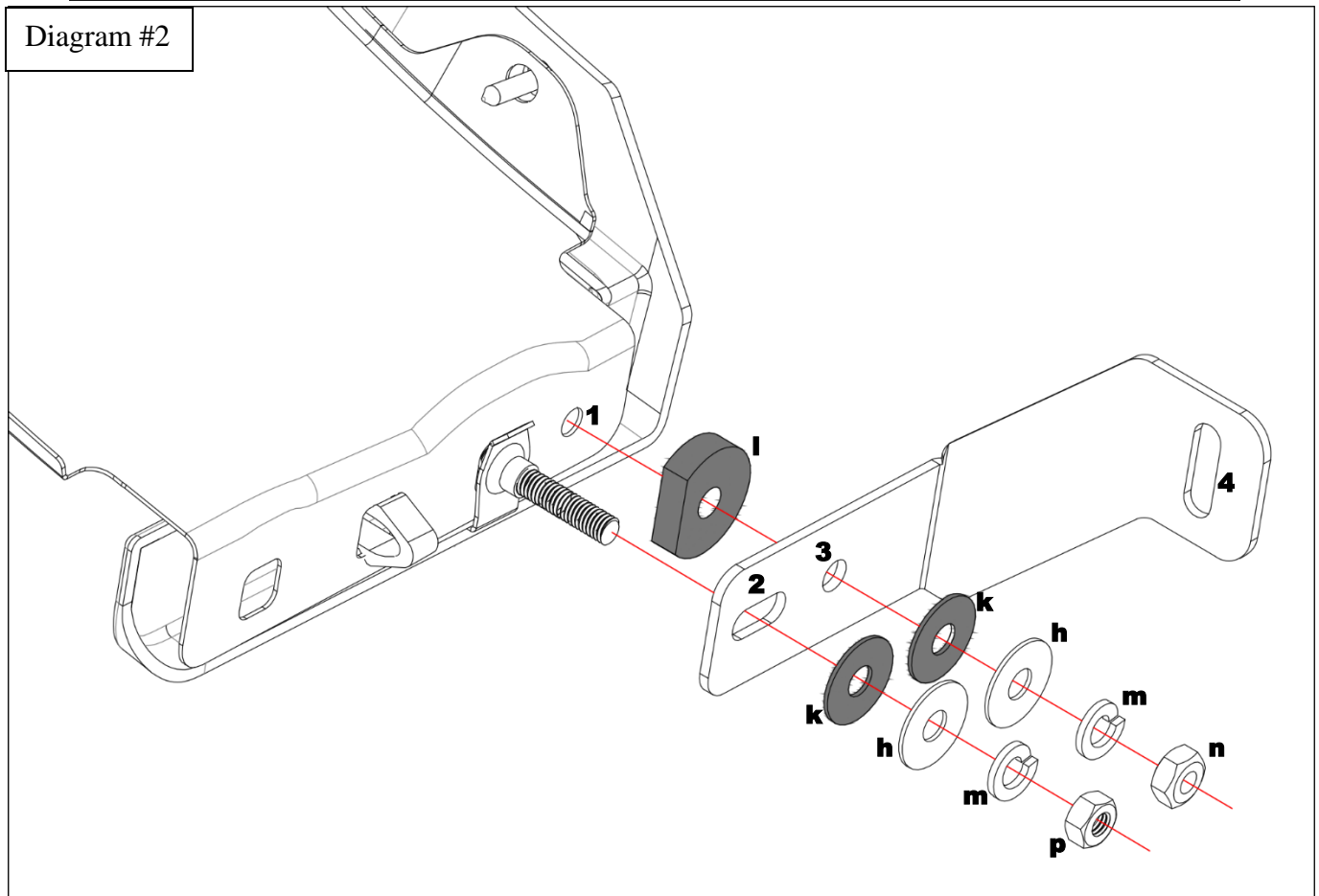
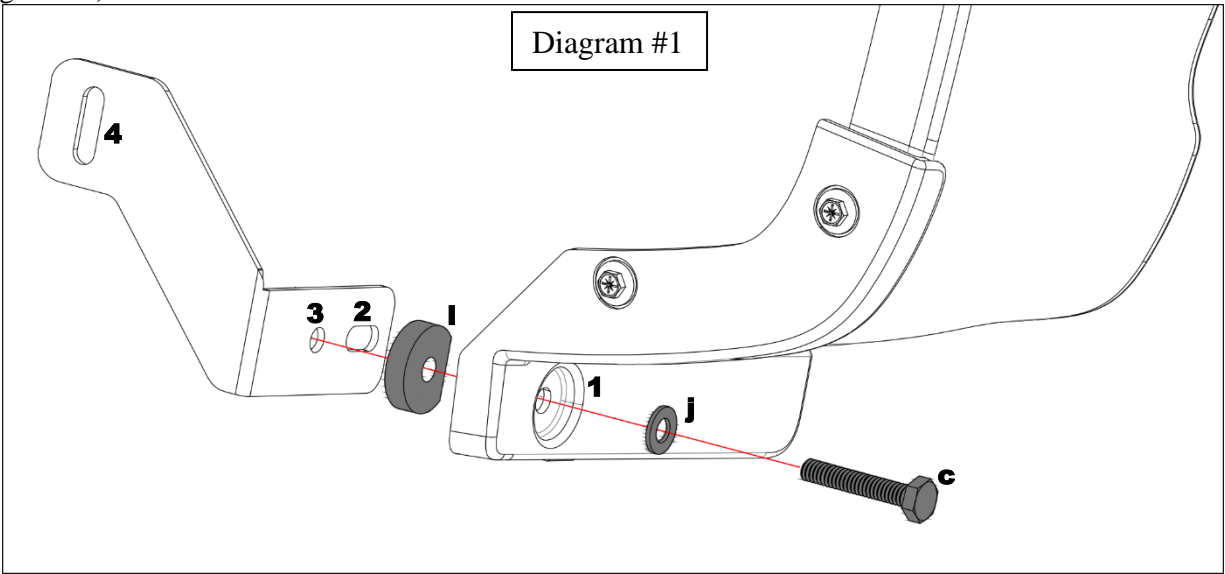

7. Secure mud flap holes #8 & #9 to factory holes #5 & #6 using a sheet metal screw (d) and flat washer (g).
8. Install mud flap hole #7 to bracket hole #7 using a capscrew (b), flat washer (e), nylon washer (i) and washer strip (r), and secure with a nylon washer (i), flat washer (f), lock washer (m) and hex nut (n).
- \*\*Note\*\*** Be sure to install the washer strip at approximately the 2:00 position so that it is putting pressure on the upper section to prevent debris from falling behind the mudflap (See Diagram #3 for washer strip position).
9. Using a square or bubble level, ensure that the mud flap is level. Tighten all fasteners.
10. Clean upper section of the wheel well with alcohol to prepare for protective tape.
11. Hold the upper section of the mud flap tight against the wheel well. Using a marker, make a small mark on the fender through mudflap holes #10 & #11 to determine where to install the spring nuts (q).
12. Pull the mudflap away from the fender and install/center the 3M tape protectors where you have marked your spring nuts (q) to be installed.
13. Install the spring nuts (q) with the extruding end facing out over the 3M tape protectors.
14. Secure mudflap holes #10 & #11 to spring nuts (q) using a capscrew (a) and flat washer (e)

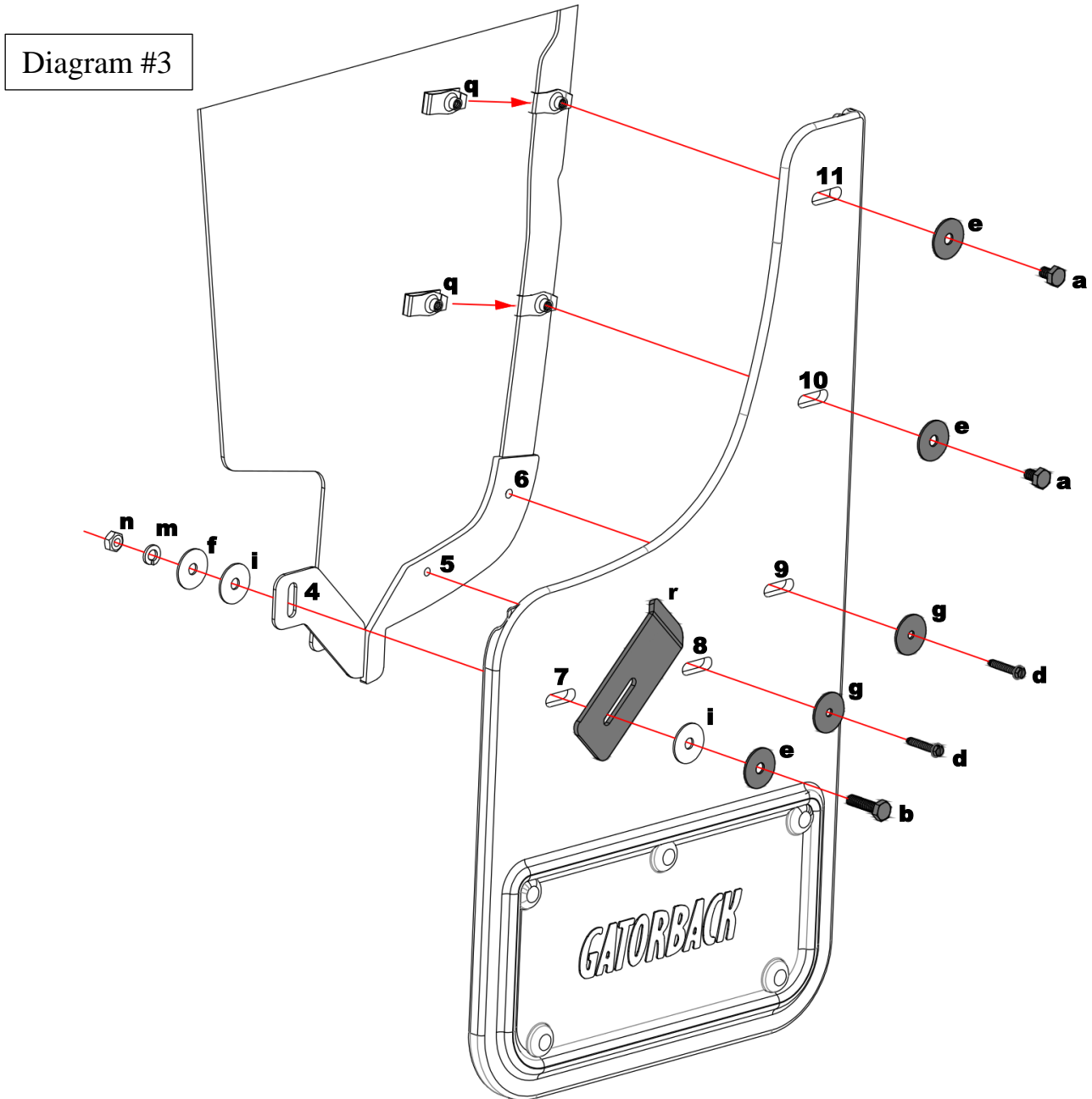

Please check out our YouTube channel to see an install video for this application.





# 2022 Ford F-150 Lightning Mud Flap Set, Rear Mounting Diagram & Instructions GCR411R

## IMPORTANT:

Manufacturer is not responsible for negligent use of vehicle with mud flaps installed, including over-tightening of screws and bolts causing damage to vehicle or mud flaps.



## TOOLS REQUIRED-



Push Pin  
Removal Tool

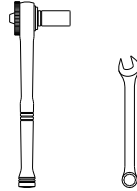

7/16" Open Wrench  
and Socket Wrench

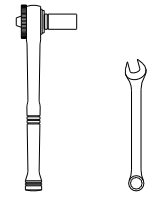

1/4" Open Wrench  
or Socket Wrench

## FLAPS AND BRACKETS

(1) Flap  
Rear, DS

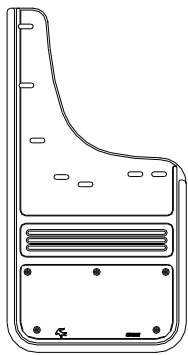

(1) Flap  
Rear, PS

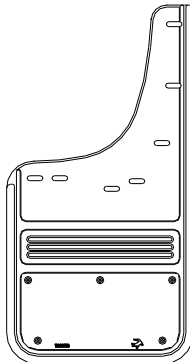

(1) Bracket  
Rear, DS  
Part# 770603

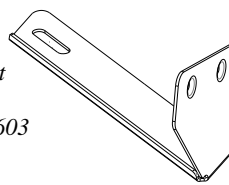

(1) Bracket  
Rear, PS  
Part# 770604

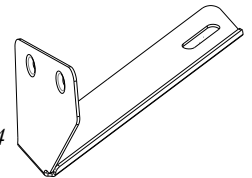

## PARTS BAG # 770531

a) (4) Capscrew, Blk Oxid.  
SS, 1/4"-20UNC x 3/8"  
Part #014069



b) (4) Cap Screw  
1/4"-20UNC x 1", SS, Blk. Oxid  
Part #014073



c) (8) Screw, Sht Mtl.  
#8-15 x 1" Blk Ox.  
Part #016057



d) (4) Washer, Flat  
0.281" x 1" SS  
Part #018068

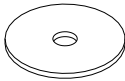

e) (8) Washer, Flat,  
0.281" x 1", SS, Blk Ox.  
Part #018069



f) (8) Washer, Flat  
0.203" x 1" Blk Ox.  
Part #018070

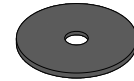

g) (4) Washer, Flat  
1/4" Helicoil, SS  
Part #024000



h) (4) Hex Nut  
1/4"-20, SS  
Part #025000



i) (4) Spring Nut  
1/4"-20UNC, 0.84" Reach  
Part #028010



j) (4) Washer, Nylon  
0.318" x 1" x 0.04"  
Part #054061

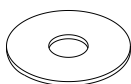

k) (2) Strip Nut  
2021 F-150 Rear  
Part #769807

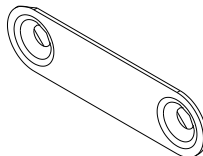

l) (1) Protective Tape  
Universal  
Part #769914

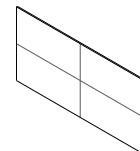

## INSTALLATION *(For ease of installation it is suggested that the wheel be removed)*

3. Before you install your Mud Flap Set, see the diagram and parts list for all necessary parts.
4. Hold up your mudflap aligning the three lower mud flap holes with the three lower factory holes and mark the fender through the upper mud two flap holes to indicate where the protective tape (l) and spring nuts (i) will be installed.
5. Pull flap away and install protective tape (l) over the locations you just marked, wrapping the tape around both sides of the fender.
6. Install spring nuts (i) over the protective tape on the marked locations.
7. Remove the three factory push pins from the lower front of factory guard inside the wheel well, and one factory push pin from the underside of the quarter panel, closest to the wheel well.
6. Install bracket to factory hole on underside of quarter panel using a cap screw (b) and flat washer (e), and secure using a nylon washer (j), flat washer (d), lock washer (g) and hex nut (h).

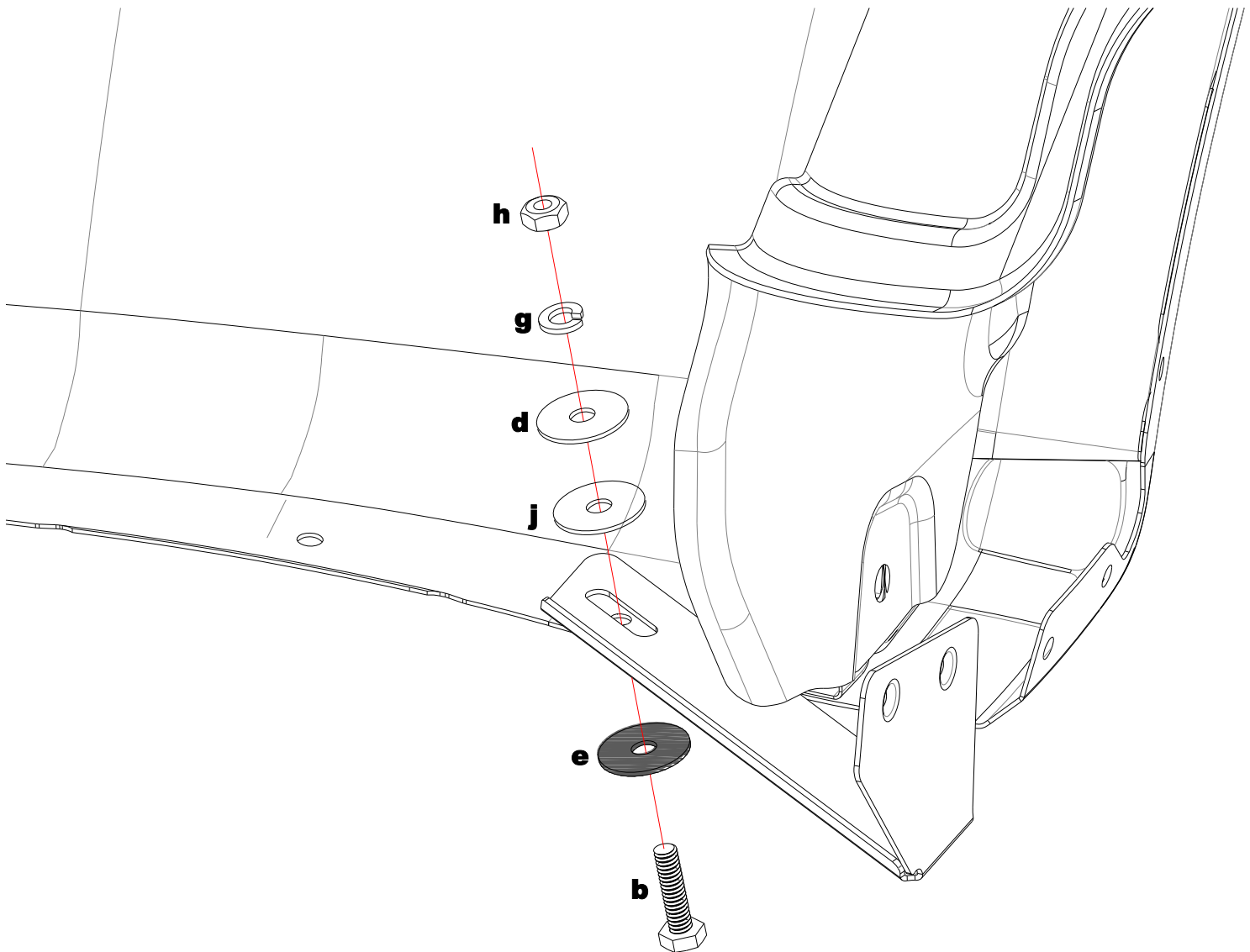

7. Place strip nut (k) behind factory holes #9 & #10 and install mud flap holes #4 & #5 through factory holes #9 & #10 into strip nut using a sheet metal screw (c) and flat washer (f). Ensure that you hold the strip nut in place while installing screws.
8. Loosely install mud flap hole #3 to factory hole #8 using a capscrew (b) and flat washer (e) and secure using a nylon washer (j), flat washer (d), lock washer (g), and hex nut (h).
9. Loosely install mud flap holes #1 & #2 to spring nuts (i) installed on fender lip using a cap screw (a) and flat washer (e).
10. Loosely install mud flap holes #6 & #7 through bracket holes #11 & #12 using a sheet metal screw (c) and flat washer (f).
11. Using a square or bubble level, ensure that the mud flap is square. Tighten all fasteners.
12. Repeat procedure on the passenger side.

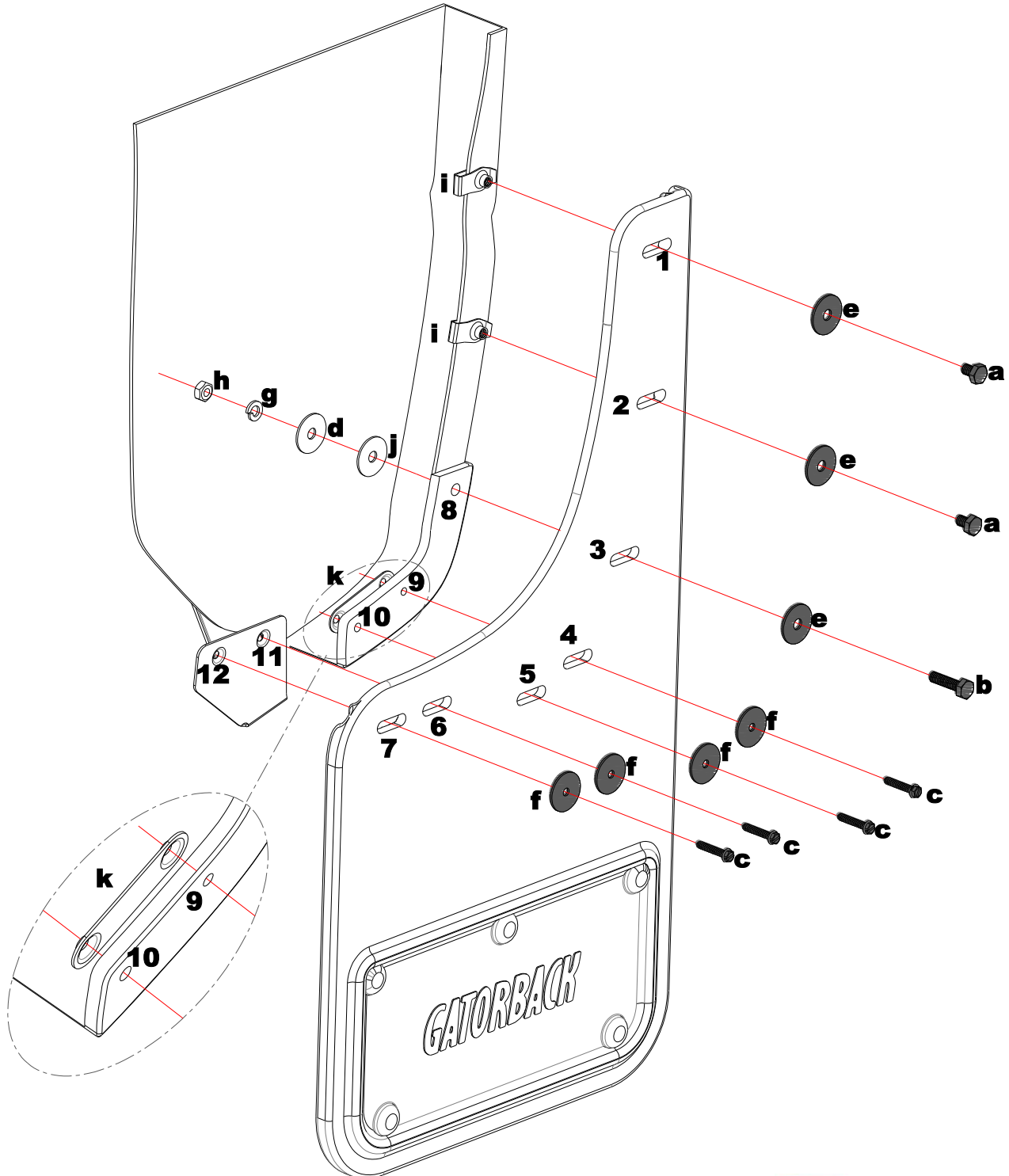

Please check out our YouTube channel to see an install video for this application.

