

**IMPORTANT:**

*Manufacturer is not responsible for negligent use of vehicle with mud flaps installed, including over-tightening of screws and bolts causing damage to vehicle or mud flaps.*

**NO-DRILL SYSTEM**

**TOOLS REQUIRED-**

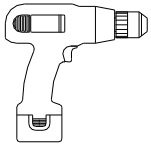

*Electric or Rechargeable Drill*



*1/4" Drill Bit*



*Push Pin Removal Tool*

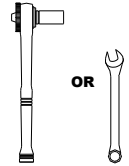

*10mm Open Wrench or Socket Wrench*

**FLAPS & BRACKETS**

*(1) Flap Assembly, Front, DS Part #766543*

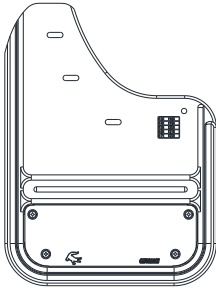

*(1) Flap Assembly, Front, PS Part #766544*

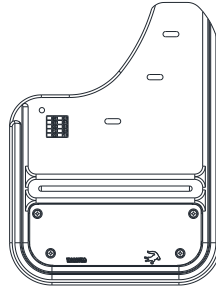

*(2) Front Washer Plate Part #766539*

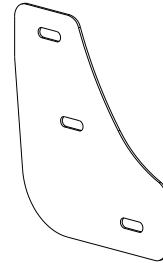

**PARTS BAG # 766540**

*a) (2) Screw, Machine SS, #18-8, 10-24 x 1" Hex Part #012022*



*b) (6) Screw, Sheet Metal SS, Blk, M4.2 x 1" Part #016041*



*c) (4) Washer, Flat 0.203" x 1", SS Part #018031*

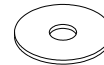

*d) (6) Washer, Flat 0.203" x 1", Alum. Part #018053*

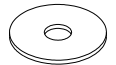

*e) (2) Washer, Lock 18-8SS, 10 Helicoil Part #024001*



*f) (2) Nut, Hex SS, #10-24 Part # 025003*



*g) (6) Spring Nut #28, 9/16" Reach Part # 028004*



## INSTALLATION *(For ease of installation it is suggested that the wheel be removed)*

1. Before you install your Mud Flap Set, see the diagram and parts list for all necessary parts.
2. Remove the (3) factory push pins on the inside of the fender and the (1) factory push pin on the underside of the fender.
3. Pull back the plastic guard and inner liner to reveal the factory holes that contained the factory push pins.
4. Install the (3) spring nuts onto each of the (3) factory holes #8 to #10. (See Diagram #2)
5. Move plastic guard back into place and reinstall the factory push pin on the underside of the fender.
6. Loosely install the mud flap and washer plate through holes #1 to #6 to the inner fender through holes # 8 to #10 using (3) sheet metal screws and (3) aluminum washers.
7. With a square or other levelling tool, ensure that the flap is level.
8. Carefully tighten all screws and double-check that the flap has remained level.
9. With a ¼" drill bit, drill through the inner mud flap hole #7 and through the plastic liner #11.
10. Install a machine screw through mud flap hole #7 into inner liner hole #11 using (2) stainless steel washers, (1) lock washer, and (1) hex nut.
11. Repeat procedure for the passenger side.

### Diagram #1

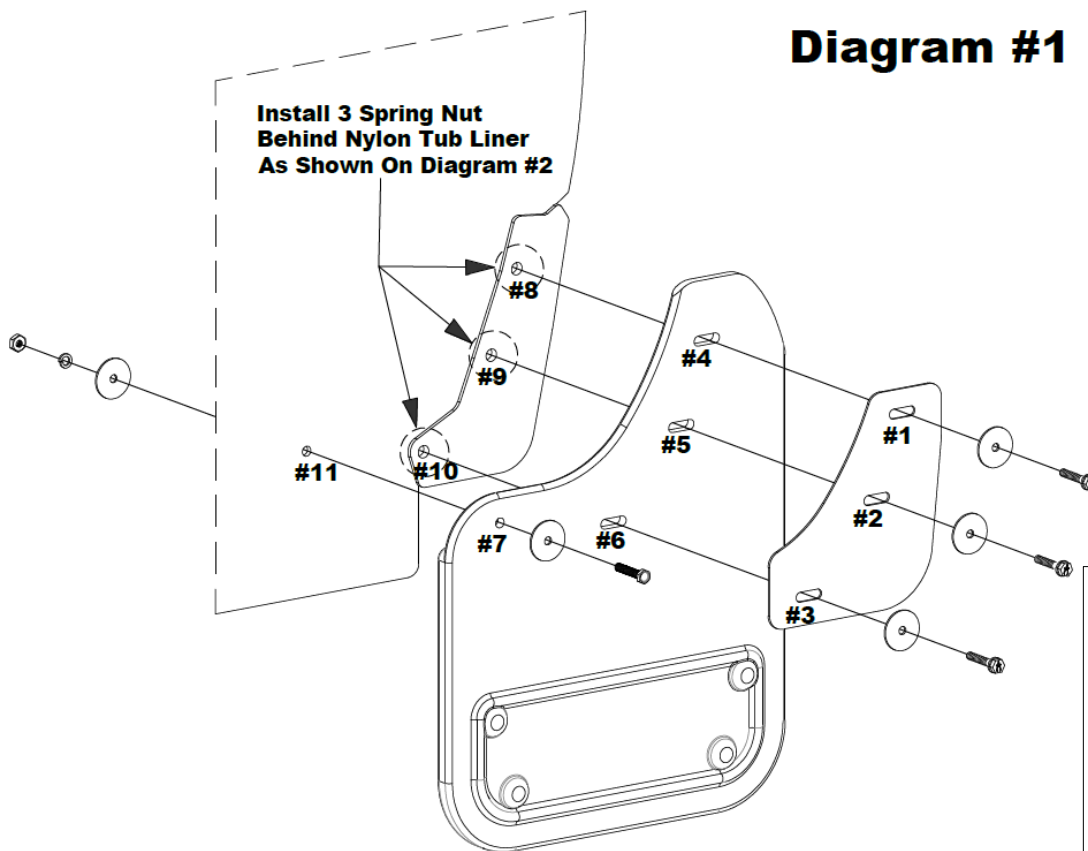

### Diagram #2

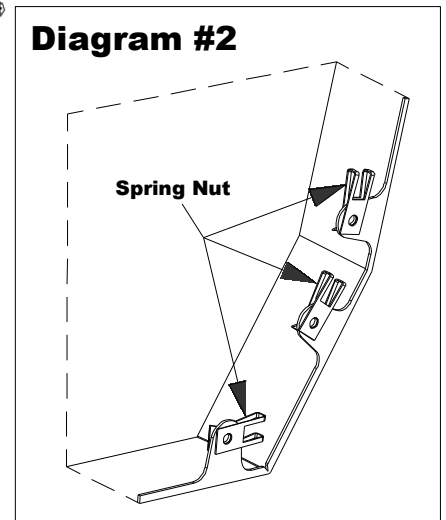

Please check out our YouTube channel to see an install video for this application.

