



2017-2022 Current Ford F-250/F-350 Front Mount Bracket w/ Mud Flap Mounting Diagram & Instructions

GCR48F

IMPORTANT:

The manufacturer is not responsible for negligent use of vehicle with mud flaps installed, including over-tightening of screws and bolts causing damage to vehicle or mud flaps.

TOOLS REQUIRED:

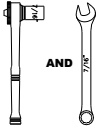

7/16" open wrench
and socket wrench

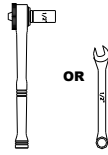

5/16" open wrench
or socket wrench



Slotted
Screw Driver

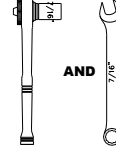

10mm open wrench
and socket wrench
(truck w/ flare only)

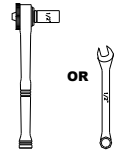

7/32" or 5.5mm open
or socket wrench
(truck w/o flare only)

BRACKETS

(2) Mount Bracket,
Front
Part #759843

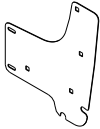

(1) Brace
Front, DS
Part #759844

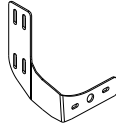

(1) Brace
Front, PS
Part #759845



(2) Strip Washer
Front
Part #759846

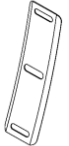

PARTS BAG #759853

a) (4) Capscrew, SS
1/4" - 20UNC x 3/4"
Part #014034



b) (8) Screw, Sheet Metal
SS, #12-11x1-1/2" HWH
Part # 010045



c) (4) Washer, Lock
SS, Helicoil
Part # 024000



e) (8) Washer, Flat
Aluminum, 0.281" x 1"
Part #018052

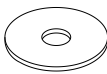

f) (8) Washer, Flat
SS, 0.281" x 1"
Part # 018028

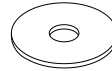

g) (4) Flange Nut,
Serrated, M6
Part # 025025



h) (6) Washer, Nylon
1" OD x 0.318" ID
Part # 054061



i) (4) Nut, Hex
SS, 1/4" - 20UNC
Part # 025000



j) (8) Nut, Expansion
Nylon, Natural #12
Part # 054059



k) (2) Nylon Spacer
1/2" x 1/2", ID 1/4"
Part #054063



Installation for trucks with Standard (Felt) Liner: *(For ease of installation it is suggested that the wheel be removed)*

Note: Please see “2017 Ford Superduty Gatorback Installation - Front” video on our YouTube page at <https://www.youtube.com/c/TruckHardwareLtd>



1. Install the 4 nylon expansion nuts, #054059 into the mount bracket. Make sure all nuts are seated properly.
2. Attach the mount bracket to the brace with supplied hardware. Use the inside holes on the brace for trucks with OEM flares and the outside holes for trucks without.
3. Turn wheels to get access to wheel well where the flap will be installed.
4. Loosen screws that secure the fender liner to the fender edge.
5. On trucks with flares; remove the lower front screw.
6. Slide the outside edge of the bracket between the plastic fender liner and the metal edge of the fender, on the non-flare trucks. Trucks with Flares: Install bracket between the flare and the aluminum fender lip.
7. Attach the back brace onto the two lower factory fender bolt using the supplied M6 flange nuts, #025025.
8. Reinstall lower front screw on trucks with flares.
9. All the loose fasteners can now be tightened.
10. Attach mud flap to bracket starting with the inside fasteners. Do not tighten completely, so you can still adjust / straighten the mud flap.
11. Position strip washer 759846 over top of flap and attach outside fasteners. Use nylon spacer #054041 on top position to fill void between mount bracket and strip washer. Move nylon spacer to desired location to distribute pressure of strip washer evenly on mud flap.
12. Make sure flap is mounted in the desired position and then hand tighten all the bolts. Make sure not to over tighten fasteners as the expansion nuts could be damaged.

Installation for trucks with Plastic Liner

Note: Please see “Ford Superduty with front Accessory Liner” video on our YouTube page at <https://www.youtube.com/c/TruckHardwareLtd>



1. Install the bracket using the provided M6 serrated nuts.
2. Using a paint pen or other marker, mark the two spots where the liner pushes against the bracket
3. Remove the bracket and set aside.
4. Using a box cutter, or other cutting tool, cut along the marks
5. Install the mounting plate by loosening the 2 factory screws and sliding the mounting plate in between the fender and the liner. Once in place, tighten the factory screws to secure.
6. There are spots where the fit is very tight to the liner, which does not allow the plastic inserts to be easily installed. To remedy this, using a 1/4” drill bit, drill through the effected plate holes to allow for more space for the inserts.
7. Remove the mounting plate.
8. Install the plastic clips to the mounting plate in reverse. This will allow the plate to sit flush to the liner.
9. Install the inner bracket to the mounting plate, and install the whole set up to the vehicle.

10. Install the mud flap and strip washer to the mounting plate.
- ✓ Check all fasteners for tightness. Repeat procedure on the passenger side.

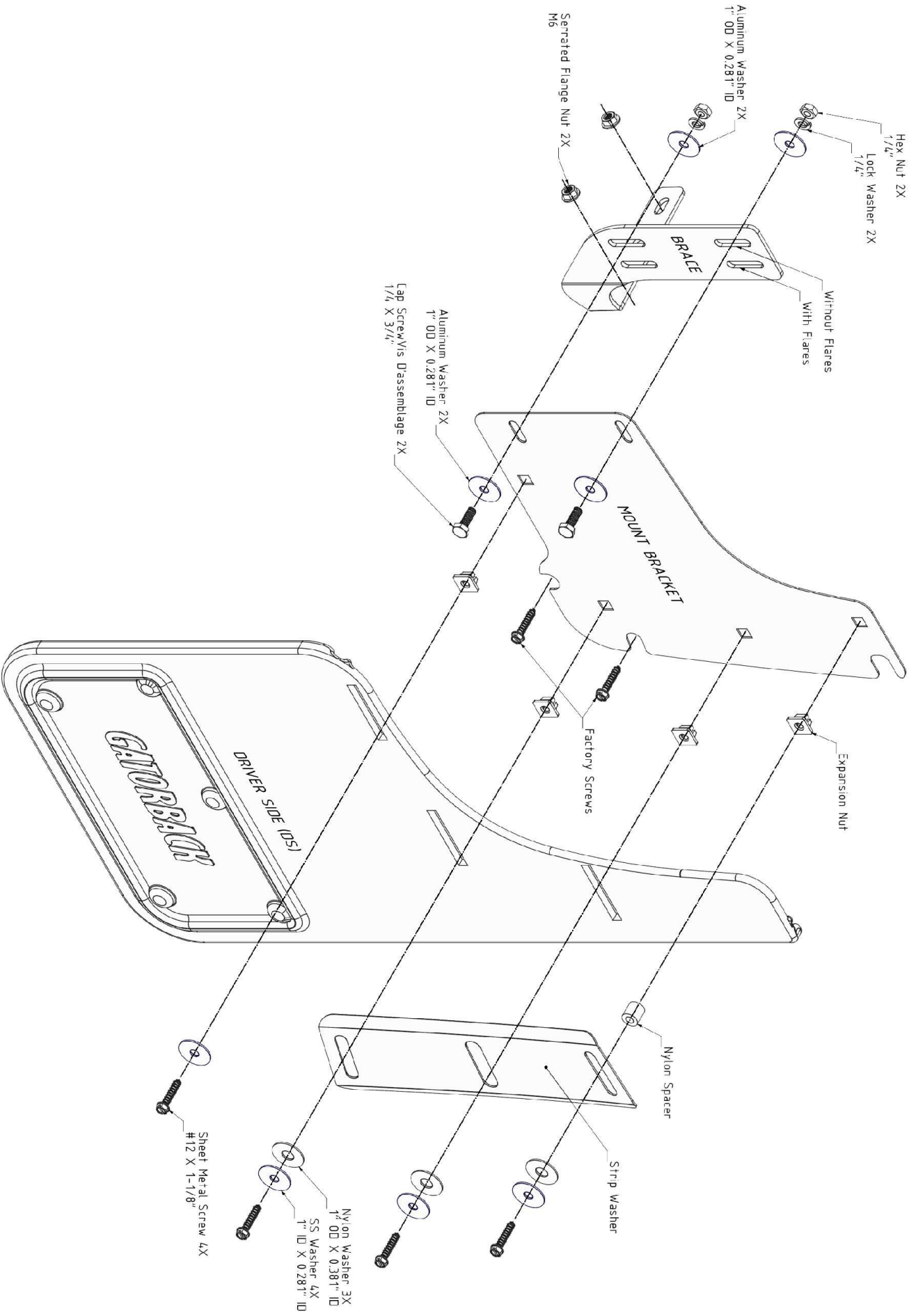

Installation Diagram