



2018 Chevy Colorado, ZR2 Mud Flap Set, 5/8" Offset, Front Mounting Diagram & Instructions

IMPORTANT:

Manufacturer is not responsible for negligent use of vehicle with mud flaps installed, including over-tightening of screws and bolts causing damage to vehicle or mud flaps.



TOOLS REQUIRED-

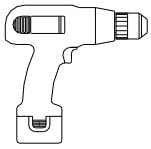

Electric or Rechargeable
Drill



1/4" Socket Driver

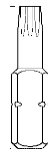

T15 Torx
Screwdriver or bit

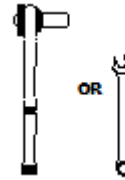

5/16" Open Wrench or
Socket Wrench

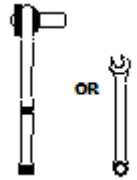

10mm Open Wrench or
Socket Wrench

FLAPS AND BRACES

(1) Brace
Front, DS
Part #766846

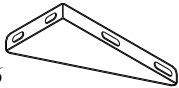

(1) Brace
Front, PS
Part #766847

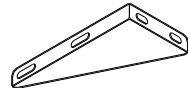

(1) Flap Assembly,
Front, DS

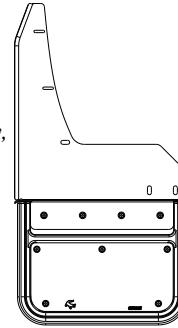

(1) Flap Assembly
Front, PS

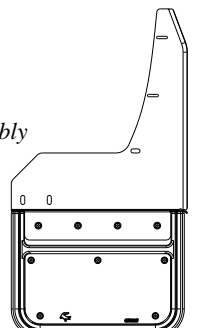

PARTS BAG #766850

a) (4) Screw, Tek, Plt
#8 x 3/4" Hex Head
Part #010049



b) (4) Screw, Mach.
M6-1 x 25mm, SS
Part #012036



c) (2) Screw, Sht Mtl
M4.2-1 x 28mm, SS
Part #016041



d) (8) Nut, Serrated Flange
Plated, M6-1
Part #025025



e) (4) Washer, Flat
0.281" x 1", Alum.
Part #018052



f) (6) Washer, Nylon
0.318" x 1" Black
Part #054071



g) (2) Washer, Flat
0.203" x 0.781", SS
Part #018018



h) (4) Washer, Flat
0.187" x 0.375", Nylon
Part #054041



INSTALLATION (For ease of installation it is suggested that the wheel be removed)

1. Before you install your Mud Flap Set, see the diagram and parts list for all necessary parts. Cut the protective plastic and peel away from the stainless steel. Start on the driver's side.
2. Loosely install the bracket through holes #6 & #7 to the inside of the flap through holes #4 & #5 using two machine screws (012036) and two aluminum washers (018052) and secure it with two black nylon washers (054071) and two serrated flange nuts (025025).
3. Remove the factory screw on the inner wheel well #10.

4. Loosely install mud flap by placing the bracket holes #8 & #9 over the factory screws #11 & #12 on the inward side of the wheel well. *Note* The bracket will sit in front of the existing factory nuts.
5. Install lower mud flap hole #3 through factory hole #10 with a sheet metal screw (016041), a stainless steel washer (018018) and a black nylon washer (054071).
6. Install the bracket as far back as possible, securing it with two serrated flange nuts (025025).
7. Using a bubble level or square, ensure that the mud flap is level. Viewing the vehicle from the back, the outer edge of the mud flap should appear parallel to the tires.
8. Carefully tighten all fasteners on bottom mud flap hole #3. Ensure the flap has remained level.
9. Using the provided Tek Screw (010049), install upper two mud flap holes #1 and #2 into the plastic liner. Be Careful not to over tighten the screws into the plastic liner.
10. Tighten the inner bracket bolts.
11. Repeat procedure on passenger side.

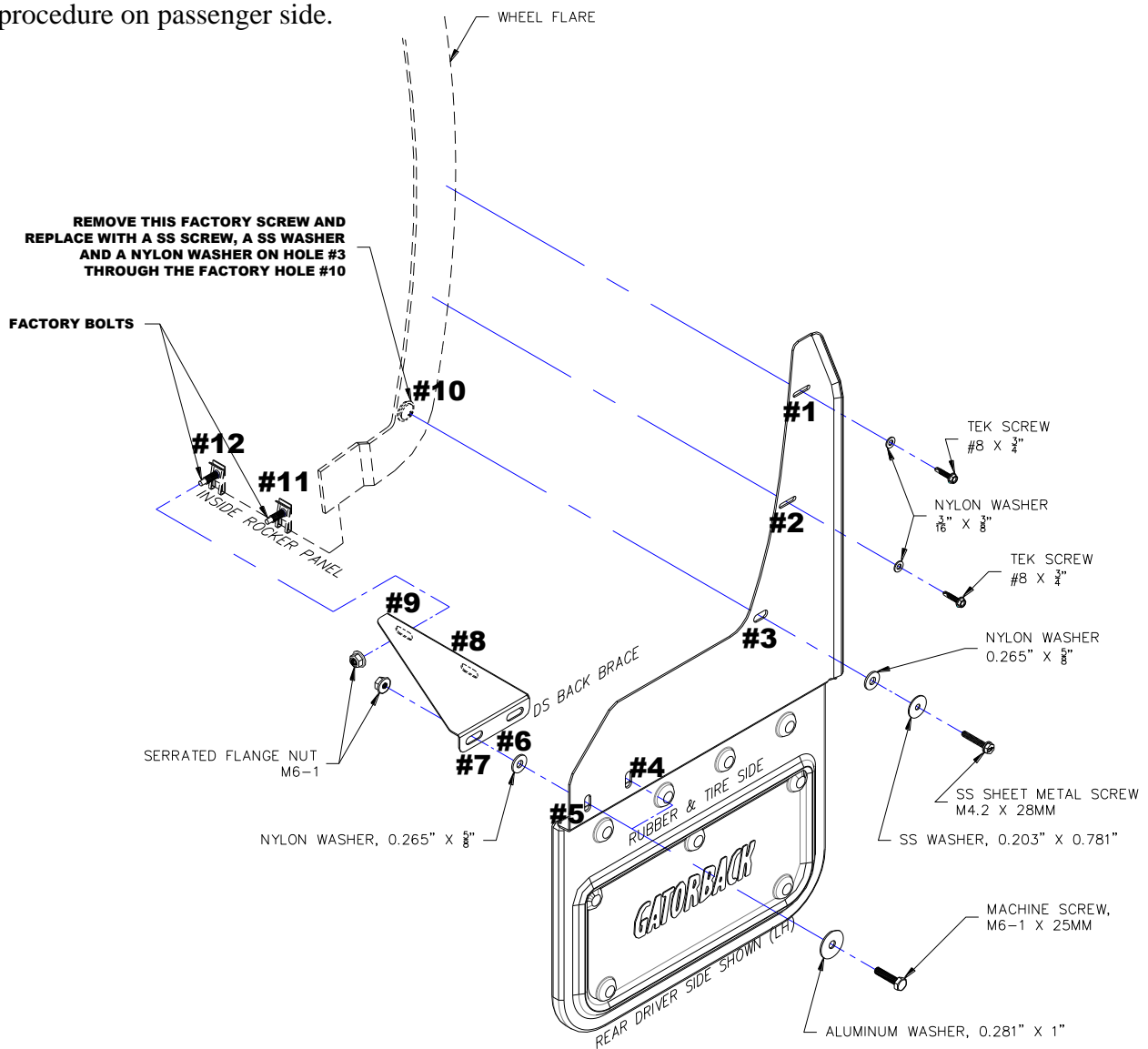

IMPORTANT:

Manufacturer is not responsible for negligent use of vehicle with mud flaps installed, including over-tightening of screws and bolts causing damage to vehicle or mud flaps.

NO-DRILL SYSTEM

TOOLS REQUIRED-



Phillips Screw Driver

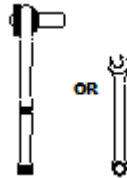

5/16" Open Wrench or
Socket Wrench

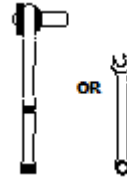

7/16" Open Wrench or
Socket Wrench

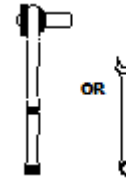

3/8" Open Wrench or
Socket Wrench

FLAPS AND BRACES

(1) Brace
Rear, DS
Part #766854

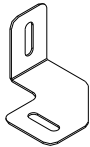

(1) Brace
Rear, PS
Part #766855

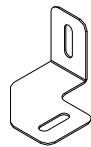

(1) Flap Assembly,
Rear, DS

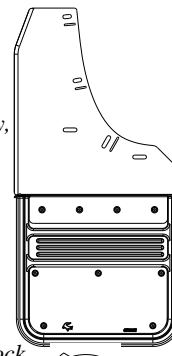

(1) Flap Assembly
Rear, PS

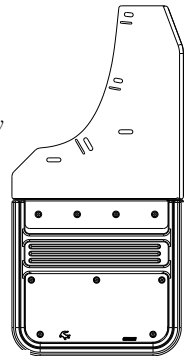

PARTS BAG #766858

a) (4) Screw, Mach.
#10 x 1", SS
Part #012022



b) (6) Capscrew
1/4"-20UNC x 1", SS
Part #014007



c) (4) Washer, Lock
18-8SS, #10 Helicoil
Part #024001



d) (4) Nut, Hex
#10, SS
Part #025003



d) (6) Washer, Flat
0.281" x 1", SS
Part #018028



e) (6) Washer, Flat
0.318" x 1", Nylon.
Part #054061



f) (8) Washer, Nylon
0.318" x 1" Black
Part #054071



g) (10) Washer, Flat
0.203" x 0.781", SS
Part #018018



i) (3) Mount Clip
Driver Side
Part #750582

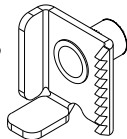

j) (3) Mount Clip
Passenger Side
Part #750584

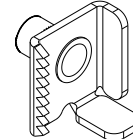

INSTALLATION (For ease of installation it is suggested that the wheel be removed)

- Before you install your Mud Flap Set, see the diagram and parts list for all necessary parts. If applicable, cut the protective plastic and peel away from the stainless steel. Start on the driver's side.
- Loosely install the brace through hole #6 to the inside of the flap through hole #5 using a machine screw (012036), a stainless steel flat washer (018018), and a black nylon washer (054071) and secure it with a black nylon washer (054071), stainless steel washer (018018) lock washer (024001), and hex nut (025003).

3. Install the mud flap clamps to the rear side of the flap through holes #1 to #3 using a capscrew (014007), stainless steel washer (018028) and white nylon washer (054061).
4. Remove the factory screw located on the inner wheel well hole #8, as well as the factory push pin located on the under side of the plastic flare #9.
5. Place clamps behind the lip of the plastic flare and pull into place.
6. Reinstall the factory screw with added stainless steel washer (018018) and black nylon washer (054071) through mud flap hole #4 into factory hole #8
7. Using a bubble level or square, ensure that the mud flap is level. Viewing the vehicle from the back, the outer edge of the mud flap should appear parallel to the tires.
8. Carefully tighten all fasteners. Ensure the flap has remained level.
9. Install the bracket to the underside of the fender flare through hole #9 using a machine screw (012022), stainless steel washer (018018), nylon washer (054071) and secure with stainless steel washer (018018), lock washer (024001) and hex nut (025003).
10. Repeat procedure on passenger side.

