

IMPORTANT:

Manufacturer is not responsible for negligent use of vehicle with mud flaps installed, including over-tightening of screws and bolts causing damage to vehicle or mud flaps.

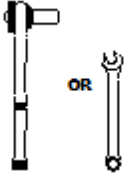

TOOLS REQUIRED-



7/16" Open Wrench or
Socket Wrench



1/4" Socket Driver
Bit



T15 Torx

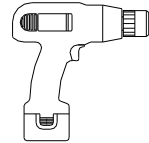

Electric or Rechargeable
Drill



Note These flaps are meant for use with the Factory Protector Only.

They are **NOT** meant for use with the Factory Splash Guard.

FLAPS

(1) Flap Assy
Front, DS

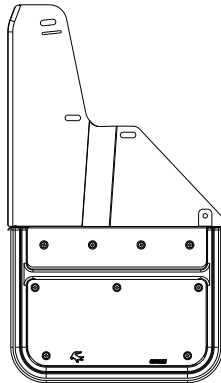

(1) Flap Assy
Front, PS

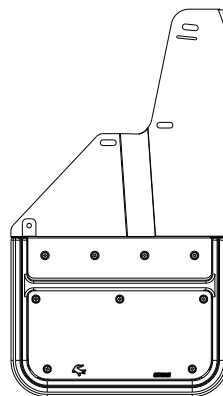

PARTS BAG # 768389

a) (2) Washer, Flat
0.281" x 1", 18g, SS,
Part #018028

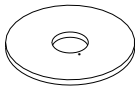

b) (4) Washer, Flat
0.203" x 1", 18g, SS,
Part #018081

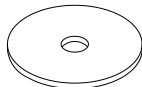

c) (2) Washer, Flat
0.437" x 1", Nylon
Part #054091

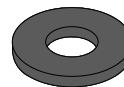

d) (2) Cap Screw, SS
1/4"-20UNC x 5/8"
Part #014006

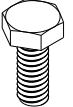

e) (4) Screw, Sheet Metal, SS
1/4" Hex Washer Head, #8-18x1"
Part # 016054

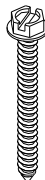

f) (1) Mud Flap Clip
Driver Side
Part # 768157

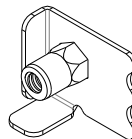

g) (1) Mud Flap Clip
Passenger Side
Part #768158

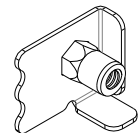

INSTALLATION *(For ease of installation it is suggested that the wheel be removed)*

1. Before you install your Mud Flap Set, see the diagram and parts list for all necessary parts. Start on the driver's side.
2. Remove factory screw from wheel well holes #5 & #6.
3. Loosely install mount clip (f) on mud flap hole #1 using a cap screw (d), stainless steel washer (a), and nylon washer (c).
4. Tuck the offset tab #4 underneath the factory plastic cap until the tab is fully engaged inside the factory plastic cap
5. Loosely secure mud flap through hole #2 into factory hole #5 using supplied sheet metal screw (e) and stainless steel washer (b).
6. Install mount clip (f) on hole #1 behind the fender lip.
7. Loosely secure mud flap through hole #3 into hole #6 using supplied screw (e) and washer (b).
8. Using a bubble level or other levelling tool, ensure that the mud flap is level. Tighten fasteners.
9. Repeat procedure for passenger side.

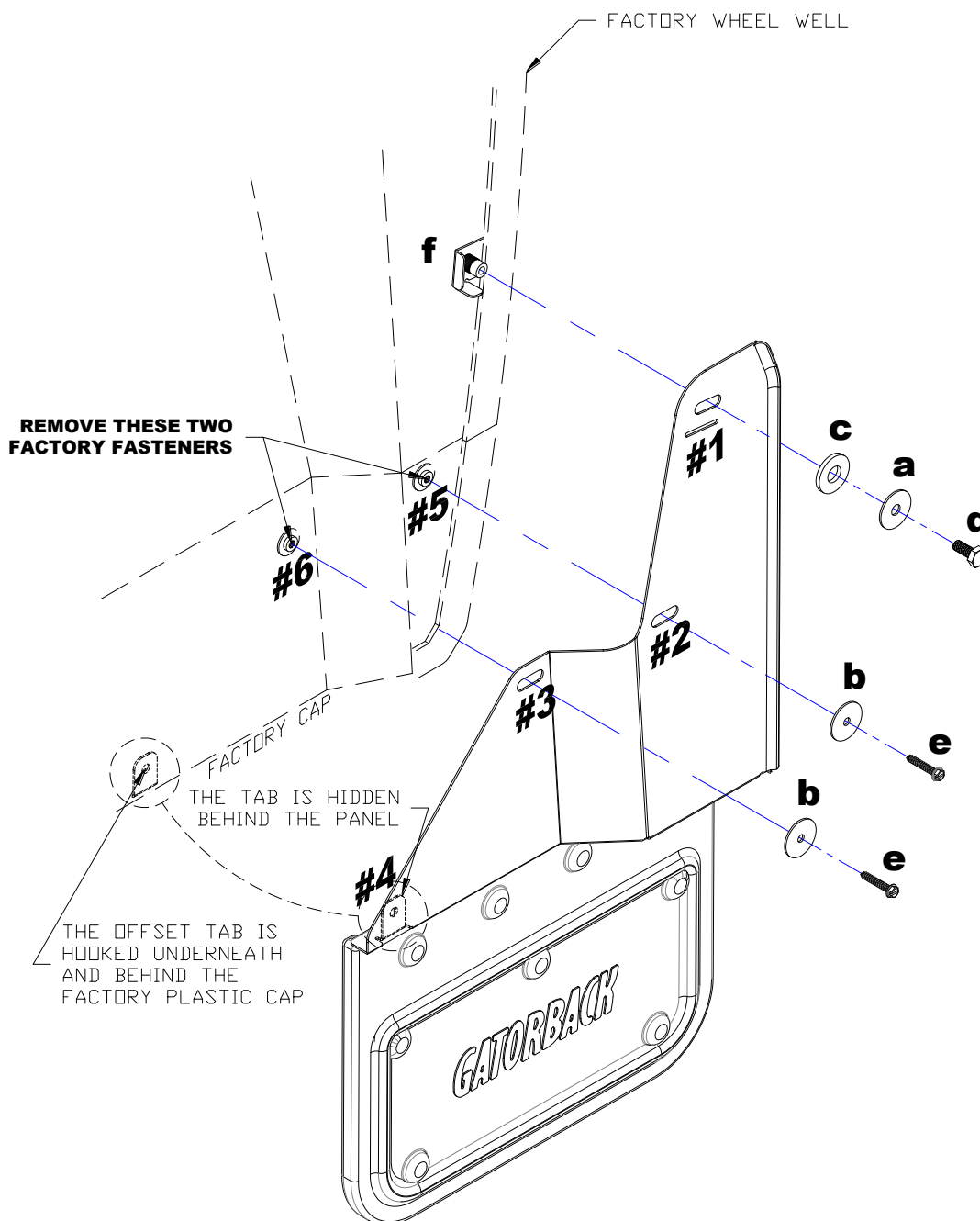

IMPORTANT:

Manufacturer is not responsible for negligent use of vehicle with mud flaps installed, including over-tightening of screws and bolts causing damage to vehicle or mud flaps.



TOOLS REQUIRED-

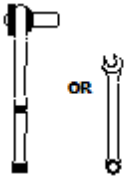

7/16" Open Wrench or
Socket Wrench

OR

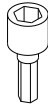

1/4" Socket Driver
Bit

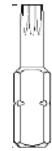

T15 Torx

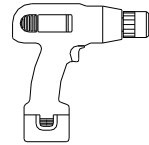

Electric or Rechargeable
Drill



Note These flaps are meant for use with the Factory Protector Only. They are **NOT** meant for use with the Factory Splash Guard.

FLAPS

(1) Flap Assy
Rear, DS

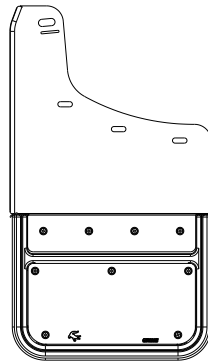

(1) Flap Assy
Rear, PS

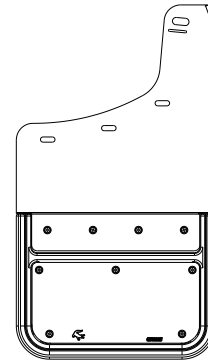

PARTS BAG # 768390

a) (2) Washer, Flat
0.281" x 1", 18g, SS,
Part #018028

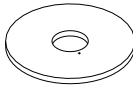

b) (6) Washer, Flat
0.203" x 1", 18g, SS,
Part #018081

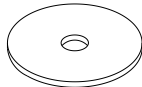

c) (2) Washer, Flat
0.437" x 1", Nylon
Part #054091

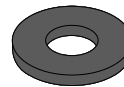

d) (2) Cap Screw, SS
1/4"-20UNC x 5/8"
Part #014006

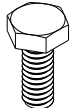

e) (6) Screw, Sheet Metal, SS
1/4" Hex Washer Head, #8-18x1"
Part # 016054

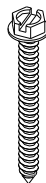

f) (1) Mud Flap Clip
Driver Side
Part # 768157

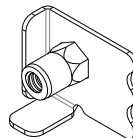

g) (1) Mud Flap Clip
Passenger Side
Part #768158

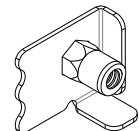

INSTALLATION *(For ease of installation it is suggested that the wheel be removed)*

2. Before you install your Mud Flap Set, see the diagram and parts list for all necessary parts. Start on the driver's side.
2. Remove factory screw from wheel well holes #5 to #7.
3. Loosely install mount clip (f) on mud flap hole #1 using a cap screw (d), stainless steel washer (a), and nylon washer (c).
4. Loosely secure mud flap through hole #2 into factory hole #5 using supplied sheet metal screw (e) and stainless steel washer (b).
5. Install mount clip (f) on hole #1 behind the fender lip.
6. Loosely secure mud flap through hole #3 into hole #6 and through hole #4 into hole #7 using supplied screws (e) and washers (b)
7. Using a bubble level or other levelling tool, ensure that the mud flap is level. Tighten fasteners.
8. Repeat procedure for passenger side.

