



## 19-C, GM 1500 CREW CAB, SHORT BOX - PART #NB760078

## 20-C GM HD CREW CAB 6.5' BOX – PART #NB760083

### KIT CONTAINS:

Qty	Part #	Description
1	761010	Front Driver Side Bracket
1	761011	Front Passenger Side Bracket
1	Assembled	Middle Driver Side Bracket
1	Assembled	Middle Passenger Side Bracket
1	Assembled	Rear Driver Side Bracket
1	Assembled	Rear Passenger Side Bracket
16.5'	080407	Bulb Seal (For Kit 760078)
18'	080407	Bulb Seal (For Kit 760083)

### PARTS BAG #760758 CONTAINS:

Qty	Part #	Description
8	014012	3/8"-16UNC x 1-1/2" Pltd Capscrew
2	014021	5/8"-11NC x 2" SS Capscrew
12	018046	3/8" Pltd Flat Washer
2	018045	5/8" Pltd Flat Washer
12	024006	3/8" Helicoil Pltd Lock Washer
2	024003	5/8" Helicoil SS Lock Washer
4	025015	Hex Nut, Plated, 3/8"-16UNC
4	762236	T-Bolt Welded Assembly, Universal

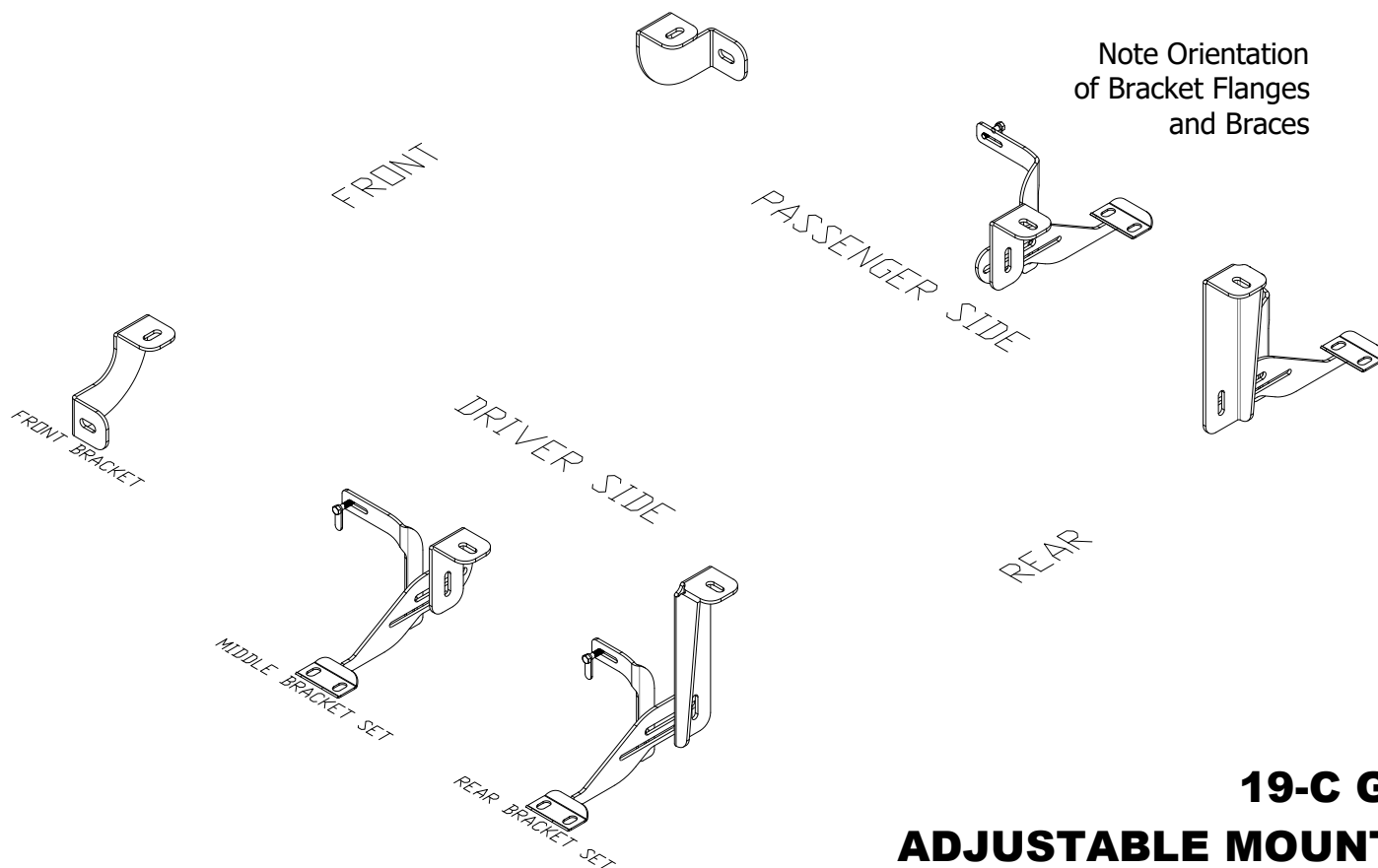

## 19-C GM ADJUSTABLE MOUNTS

- Step 1** Start on the driver's side.
- Step 2** Remove front cab mount bolt and install the front bracket loosely with the factory bolt. (See diagram for orientation).
- Step 3** Remove rear cab mount bolt and install preassembled rear bracket with the factory bolt. (See diagram for orientation). Set up the rear support strap using #762236 T-Bolt with #018046 3/8" flat washer, #024006 3/8" lock washer, and #025015 3/8" hex nut. Note: Some models have plastic plugs on the inner wall of the rocker panel where the t-bolt is installed. If your vehicle has this plug, it will need to be removed.
- Step 4** Lay pre-assembled board on the rear bracket and use a jack stand to support the front end of the board. Make sure the board is secure and will not fall. Line the board up with the front bracket and set up #014021 5/8" cap screw with #018045 flat washer and #024003 5/8" lock washer. Do not tighten bolts as you will need to level the board later.
- Step 5** Remove any plastic wrap around the bracket saddles.
- Step 6** Use #014012 3/8" cap screw with #018046 flat washer and #024006 lock washer to loosely install the board to the rear bracket saddle.
- Step 7** Remove the middle cab bolt and loosely install the pre-assembled middle bracket with the factory bolt (See diagram for orientation). Set up the middle bracket support strap using #762236 t-bolt with #018036 3/8" flat washer, #024006 3/8" lock washer, and #025015 3/8" hex nut. Install the board to the bracket saddle like you did with the rear bracket. Note: Some models have plastic plugs on the inner wall of the rocker panel where the t-bolt is installed. If your vehicle has this plug, it will need to be removed.
- Step 8** Level the board to the cab and tighten up the 4 x #014012 cap screws. Secure all other bolts.
- Step 9** Repeat on the passenger side.