

IMPORTANT:

The manufacturer is not responsible for negligent use of vehicle with mud flaps installed, including over-tightening of screws and bolts causing damage to vehicle or mud flaps.

TOOLS REQUIRED:

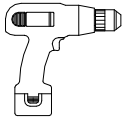

Electric or Re-Chargeable
1/2" or 3/8" Drill



9/32" Drill Bit



5/16" Socket
Driver

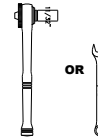

10 mm Open Wrench or
Socket Wrench

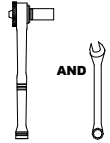

7/16" Open Wrench and
Socket Wrench

BRACKETS:

(1) Mount Bracket,
Rear, DS
Part #759476

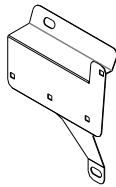

(1) Mount Bracket
Rear, PS
Part #759477

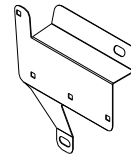

PARTS BAG #759965

a) (2) Capscrew,
1/4" x 1", Zinc Plated
Part #014010



c) (12) Washer, Flat
Aluminum, 0.281" x 1"
Part #018052

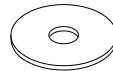

d) (6) Washer, Flat
Aluminum, 0.203" X 1"
Part # 018053



e) (2) Washer, "Z"
Aluminum, 0.281" x 1"
Part # 018055

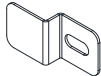

f) (2) Washer, Lock
Zinc, 1/4" Helicoil
Part # 024009



g) (2) Nut, Hex
Zinc, 1/4"
Part # 025021



h) (6) Tek Screw
#12 x 1.25" Alum.
Part # 010041



i) (8) Screw, Sheet Metal
#12 x 3/4" SMS, SS
Part # 010042



j) (8) Expansion Nut
Nylon #12
Part # 054059



OPTIONAL FLAP INSTALLATION:

1. Start on driver's side.
2. Fasten the mud flap to the bracket with three sheet metal screws, #014010, and three 1/4" aluminum washers, #018052, to holes #1 to #3 or if you prefer the flap mounted higher and further away from the ground, then use holes #4 to #6.
3. Square the flap with the tire while putting pressure against the wheel well and tighten the two bolts on #11 and #12.
4. Fasten the mud flap with three tek screws #10 x 1" and three #10 flat washers along the wheel well.
5. Repeat on passenger side.

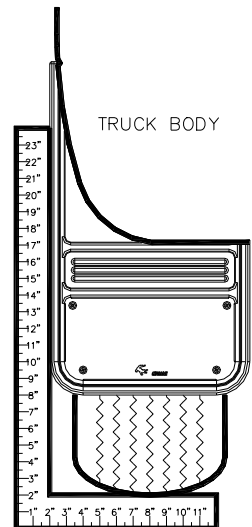

DRIVER SIDE (LEFT HAND) SHOWN
REAR VIEW OF THE VEHICLE



INSTALLATION:

For ease of installation, it is suggested that the wheel be removed.

1. Before you install your Mud Flap set, see the diagram and parts list for all necessary parts. Cut protective plastic and peel away from stainless steel. Start on the driver's side.
2. Install the four nylon expansion nuts #054059 into the mount bracket holes #7 to #10. Make sure all nuts are seated properly
3. Remove the factory bolt on #14 and reinstall with a 1/4" aluminum washer, #018054, on slotted hole #11 of the bracket through the factory hole #14. Loosely secure at this point.
4. Square the bracket and fasten the lower part of the bracket with a capscrew, #014010, two 1/4" aluminum washers, #018052, one 1/4" lock washer, #024009, and a 1/4" hex nut, #025021. Now tighten the factory bolt on hole #11.
NOTE If you install the mud flap at the same time, do not tighten these two bolts #11 and #12 until you square the flap.
5. Repeat on passenger side.

✓ Check all fasteners for tightness. Repeat procedure on the passenger side.

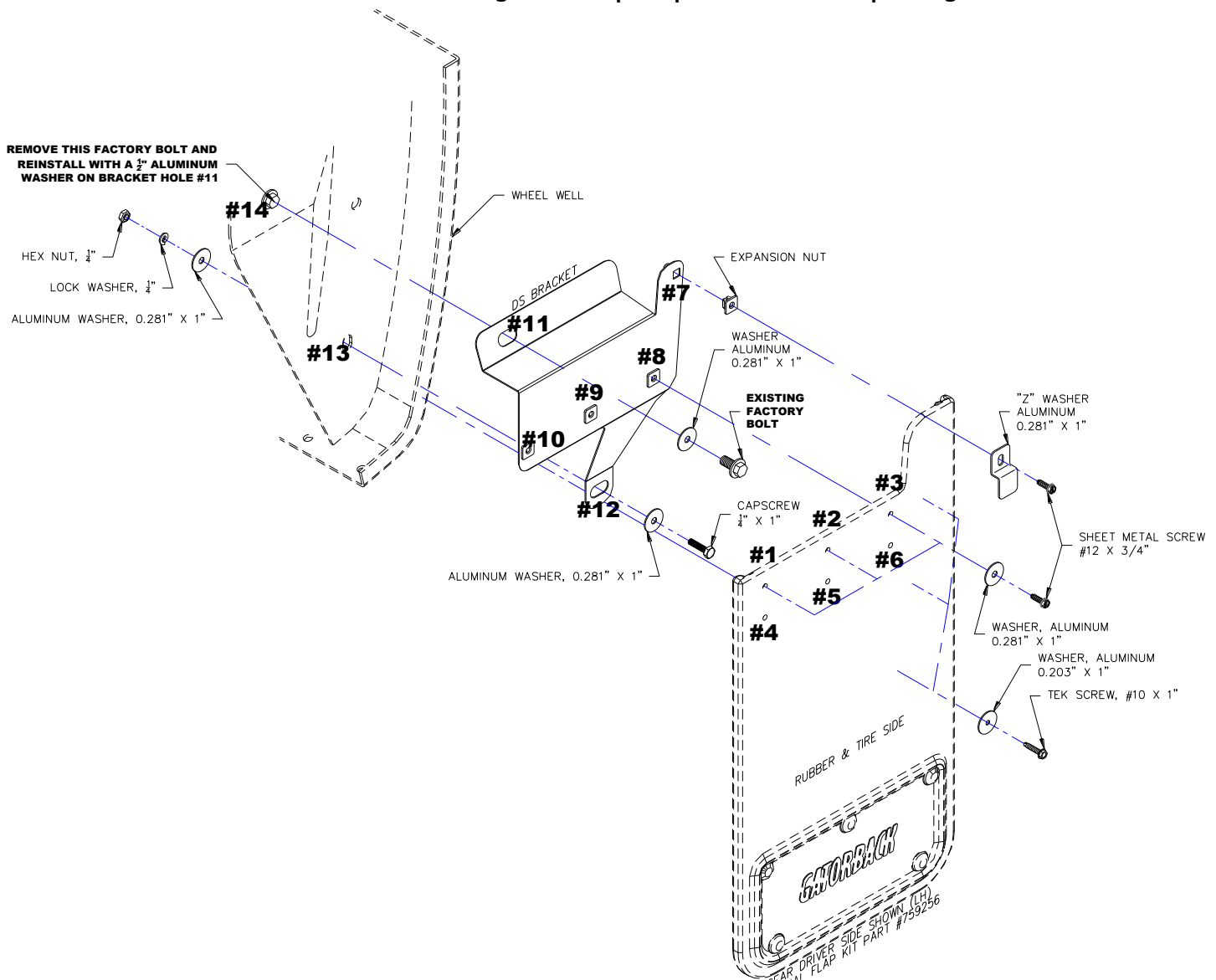

**** NOTICE ****

This Bracket requires drilling to square off the mud flaps. Please review the Ford F150 SVE Bulletin for proper procedures for drilling into the truck. Any drilling into the truck is the responsibility of the installer.

These instructions and enclosed parts have been provided in response to the Ford 2015 F150 SVE Bulletin. Any deviation of the installation and /or hardware may result in premature corrosion. The manufacturer and/or Dealer Distributor are not responsible for negligent use or installation.