



GATORBACK

MUDFLAPS

2014-18, CHEV 1500 Rear 2015-19 CHEV HD Rear Mud Flap Set, 5/8" Offset, Rear Mounting Diagram & Instructions

IMPORTANT:

The manufacturer is not responsible for negligent use of vehicle with mud flaps installed, including over-tightening of screws and bolts causing damage to vehicle or mud flaps.

TOOLS REQUIRED:



Electric or Chargeable
1/2" or 3/8" drill



3/8" Socket Driver

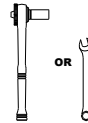

7/16" Open Wrench
or Socket Wrench

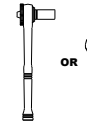

5/16" Open Wrench
or Socket Wrench



#15 Torque
Screwdriver

FLAPS:

(1) Flap Assembly,
Rear, PS

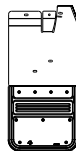

(1) Flap Assembly
Rear, DS

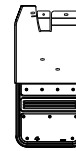

PARTS BAG #766019

a) (2) Screw, Tek
1/4" x 1-1/4"
Part #010011



b) (2) Capscrew, SS
1/4"-20UNC x 1"
Part #014007



c) (6) Screw, Sheet Metal
M4.2-1" x 28mm
Part #016041

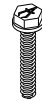

d) (1) Mount Clip, DS
w/ Clinch Nut
Part #750582

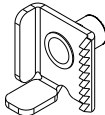

e) (1) Mount Clip, PS
w/ Clinch Nut
Part #750584

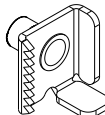

f) (4) Washer, Flat
0.281" x 1" SS
Part #018028



g) (6) Washer, Flat
0.203" x 1" SS
Part #018031



INSTALLATION: (For ease of installation, it is suggested that the wheel be removed)

1. Before you install your Mud Flap Set, see the Diagram and parts list for all necessary parts. Cut protective plastic and peel away from the stainless steel. Start on the Driver's Side.
2. Install the mud flap clip to the hole #1 with a 1/4" x 1-1/4" capscrew and a 0.281" x 1" flat washer then tighten the screw until the bottom tab of the mud flap clip just passes through the bottom slotted hole of hole #1.
3. Remove the two factory screws on the wheel well #6 & #7, and one factory screw on the wheel tub #8 as shown on the diagram and replace each screw with one M4.2 x 28mm screw, and one 0.203" x 1" flat washer on holes #2, #3 and #5 through the factory holes #6 to #8. Loosely secure at this point. Ensure that the installed mud flap clip is behind the factory wheel well.
4. Square the flap with the tire while putting pressure against the wheel well and tighten the three screws on holes #2, #3 and #5.

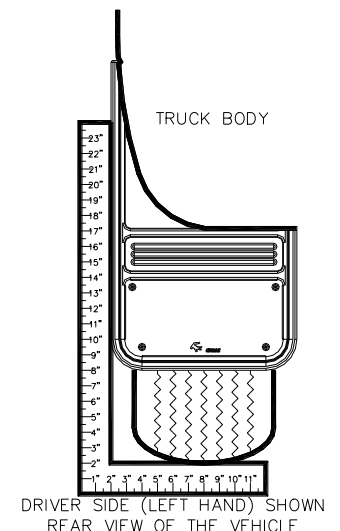

5. Now secure the flap with a flat washer and a 1/4" x 1-1/4" tek screw on hole #4 through the wheel tub.
6. Secure the upper tab of the mud flap by sliding the installed mud flap clip on hole #1 to the wheel well until the mud flap clip's teeth are gripped tight behind the wheel well and then tighten the screw.
7. Repeat the procedure for the passenger side.

