

IMPORTANT:

The manufacturer is not responsible for negligent use of vehicle with mud flaps installed, including over-tightening of screws and bolts causing damage to vehicle or mud flaps.

Before you install your Mud Flap Set, see the diagram and parts list for all necessary parts.

All hardware should be loosely installed until all mounting points have been installed and flap has been levelled. It is suggested that final tightening of hardware be done with hand tools to avoid over-tightening.

TOOLS REQUIRED:

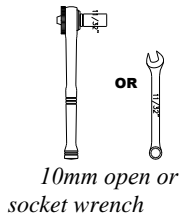

OR

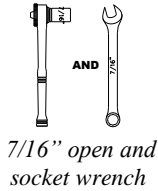

AND

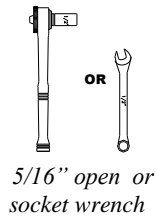

OR

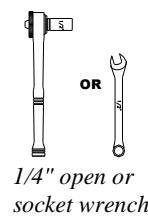
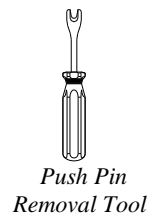

OR



FLAPS & BRACKETS

(1) Mud Flap Driver Side

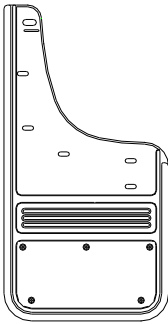

(1) Mud Flap Passenger Side

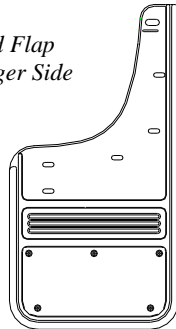

(1) Bracket Driver Side
Part #770741

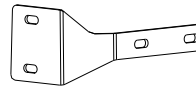

(1) Bracket Passenger Side
Part #770742

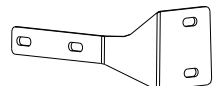

PARTS BAG #770760

a) (2) Capscrew, SS, Blk Ox.
1/4"-20UNC x 3/8"
Part # 014069



b) (2) Capscrew, SS, Blk Ox.
1/4" - 20UNC x 3/4"
Part # 014070



c) (4) Capscrew, SS, Blk Ox.
1/4"-20UNC x 1"
Part #014073



d) (4) Sht Mtl Screw
8-18 x 1.25" SS Blk Ox
Part #016061

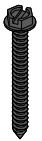

e) (4) Washer, Flat
0.281" x 1", SS
Part #018068

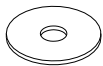

f) (6) Washer, Flat
0.281" x 1" SS Blk Ox.
Part # 018069

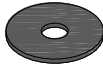

g) (4) Washer, Flat
0.203" x 1" SS Blk Ox
Part # 018070



h) (4) Washer, Lock
1/4" Helicoil, SS
Part # 024000



i) (4) Hex Nut
1/4"-20, SS
Part # 025000



j) (4) Flange Nut,
M6, Serrated
Part #025025



k) (2) Spring Nut
1/4"-20UNC, 0.54", SS
Part #028010



l) (4) Washer, Nylon
0.318" x 1"
Part #054061



m) (2) Washer, Nylon
0.38"x0.625" Blk
Part #054071



n) (2) Washer, Nylon
0.281" x 1" Blk
Part # 054084



o) (2) J-Clamp
1.5" x 2.5"
Part #767417

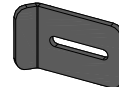

p) (1) Mount Clip
DS
Part # 769308

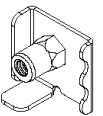

q) (1) Mount Clip
PS
Part #769309

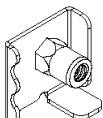

r) (1) Protective Tape
Universal, 2 pc
Part #770681

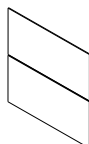

Installation

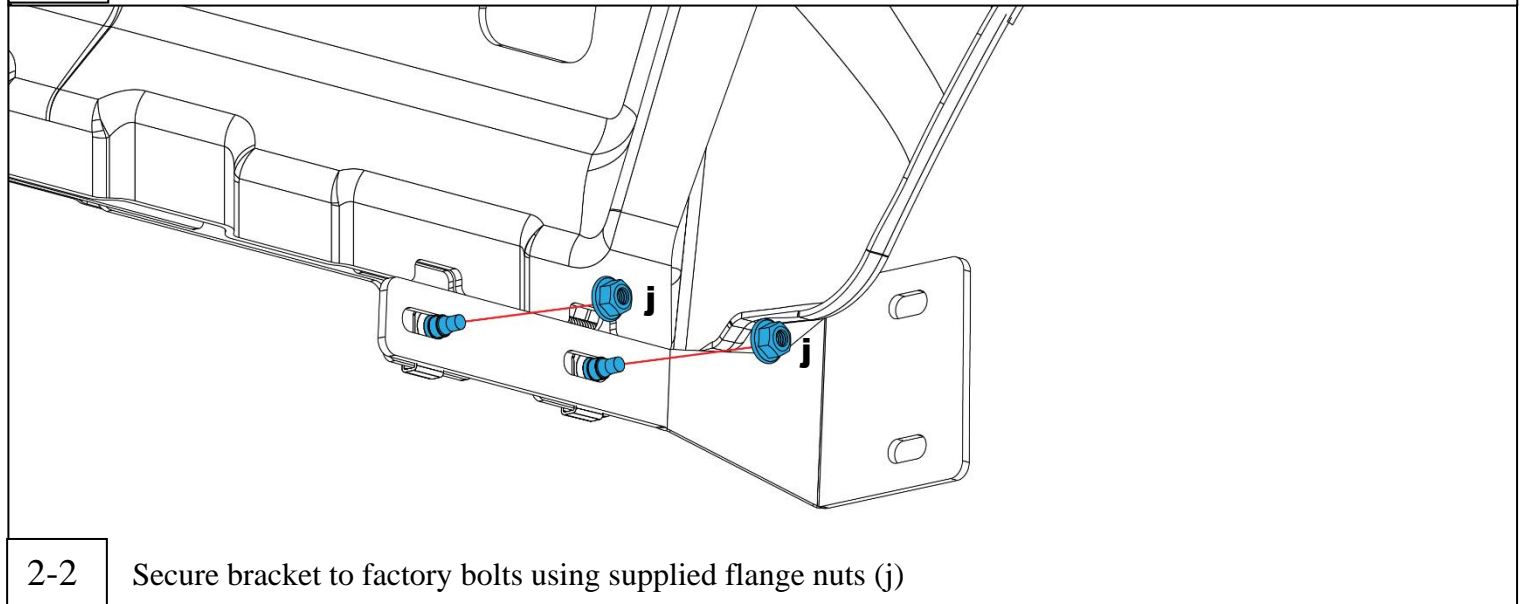
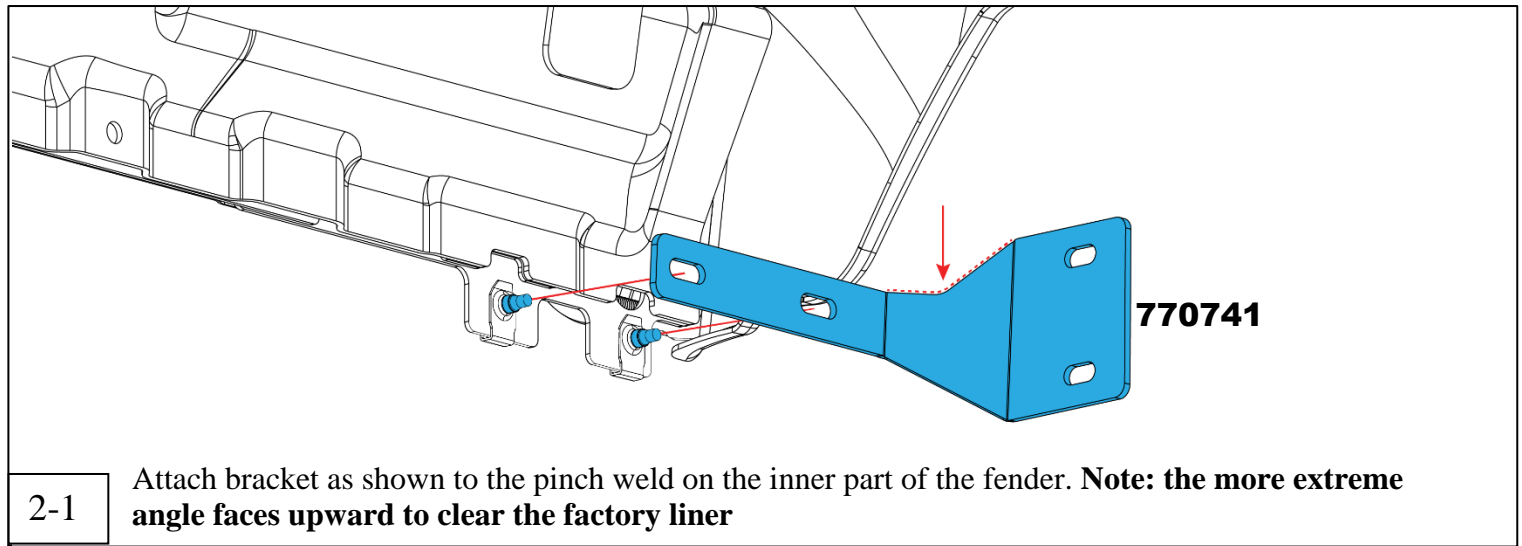
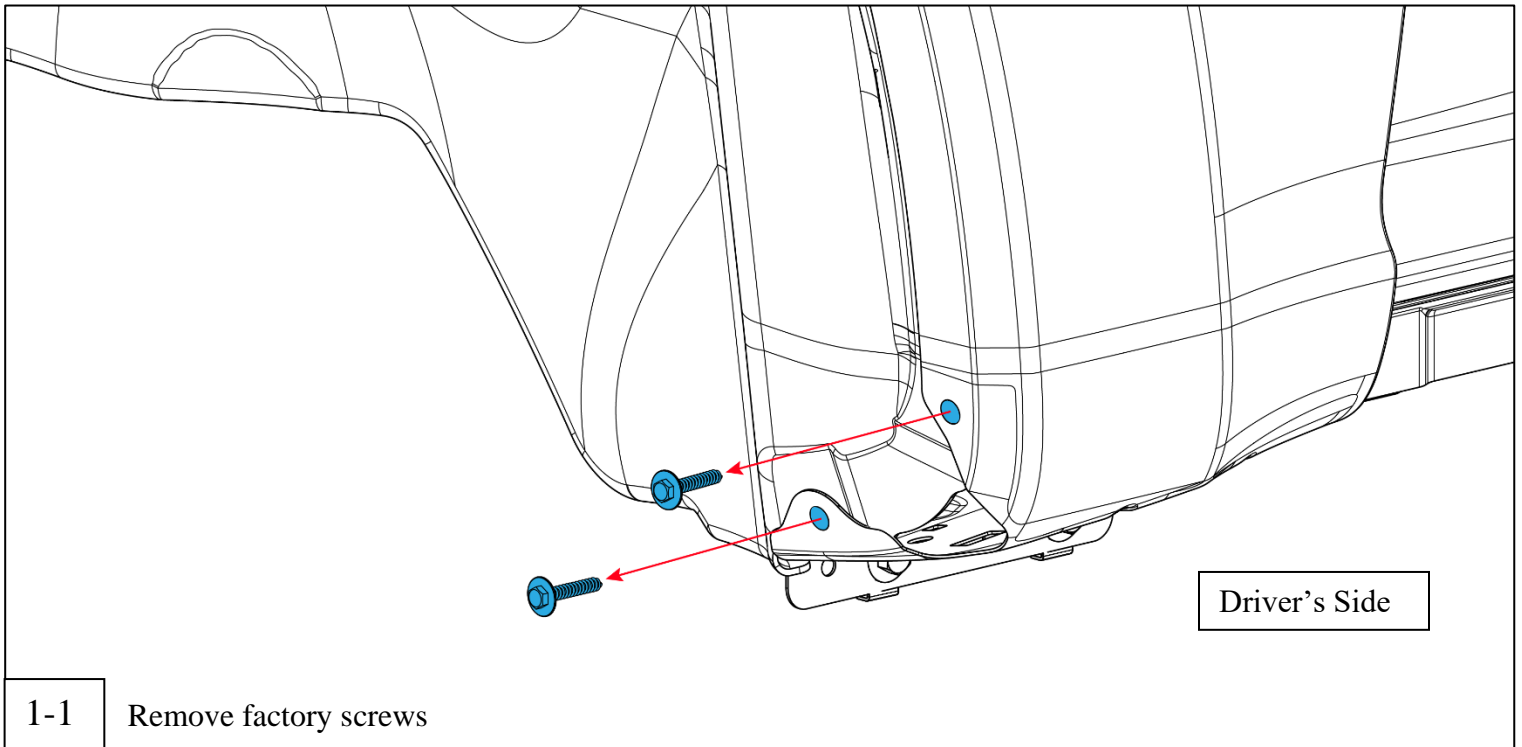

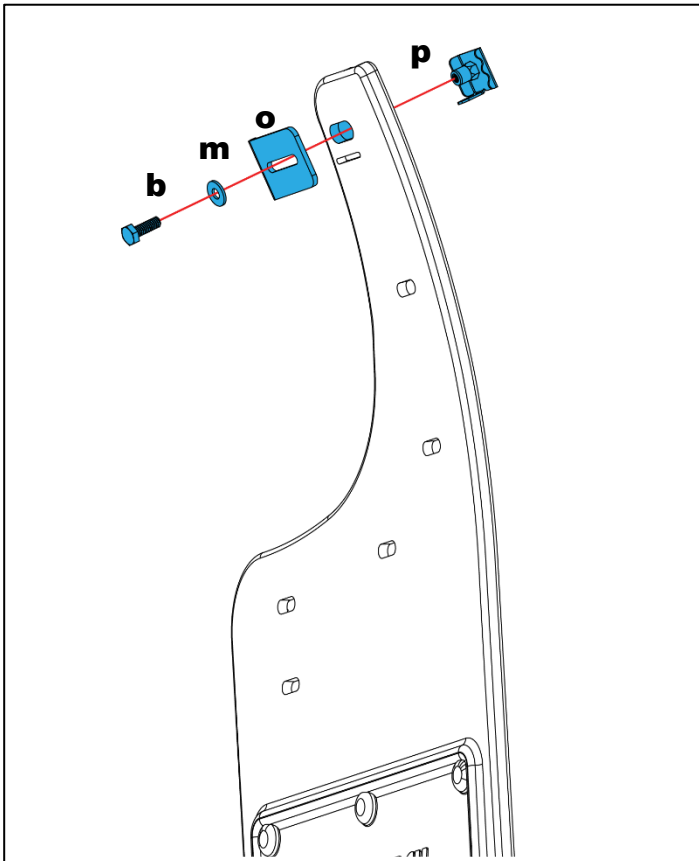

3-1

Loosely install mount clip to top mud flap hole. Do not install on the fender lip at this time.

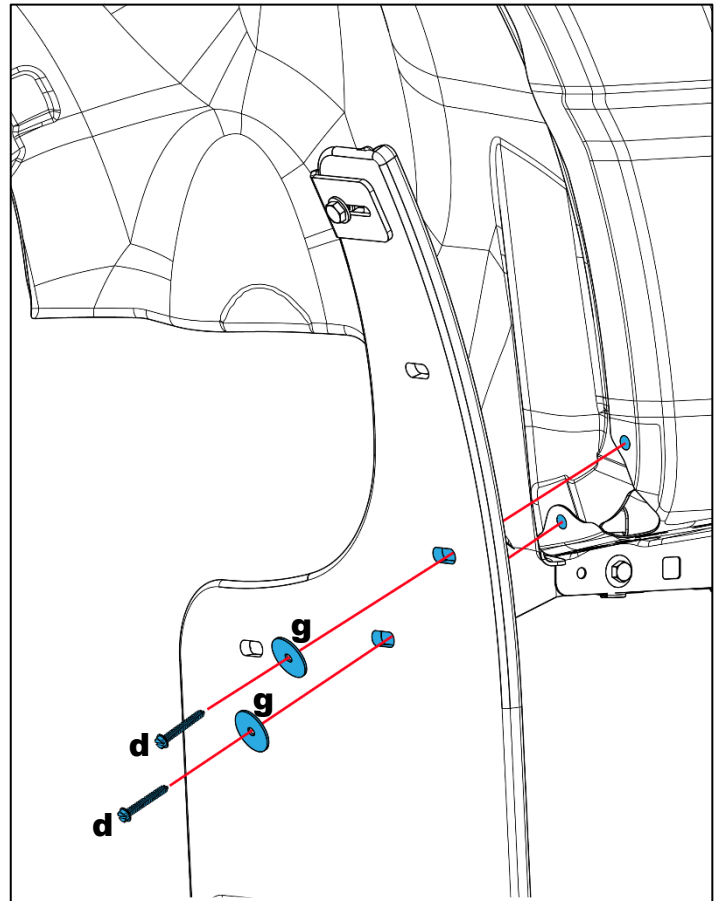

4-1

Install these two mud flap holes to the factory holes as shown

Install inner most mud flap holes to the previously installed bracket.

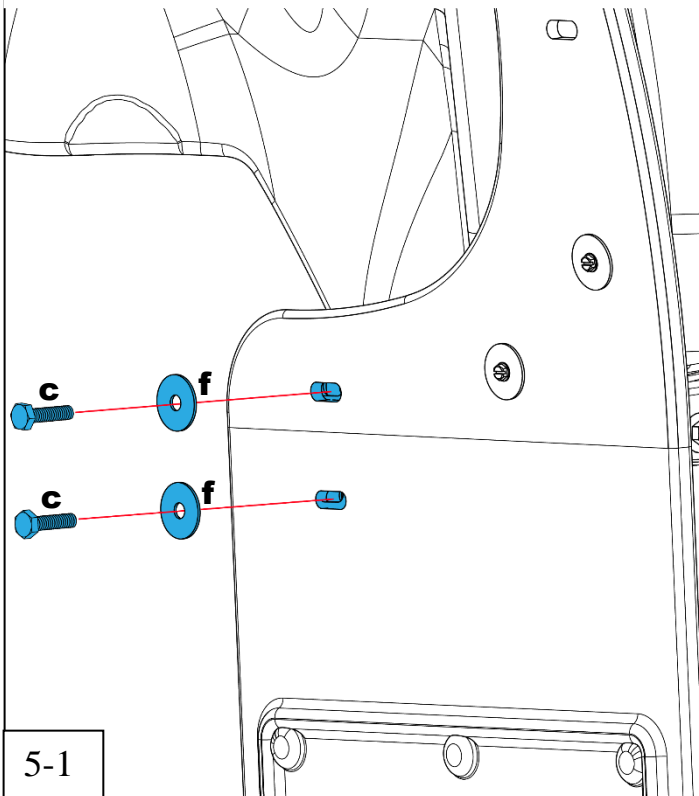

5-1

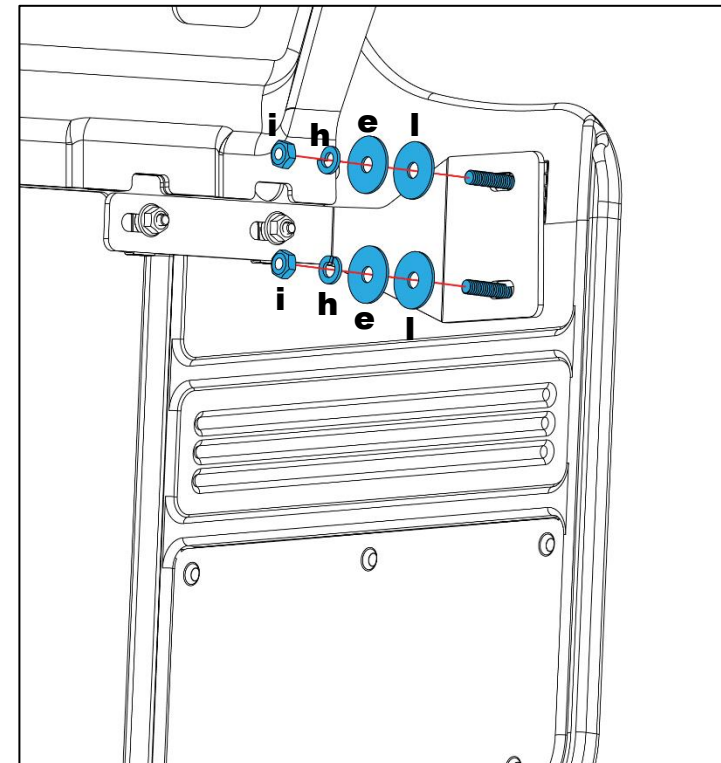

5-2

Secure the mud flap holes installed on the bracket in the previous step with the hardware shown here.

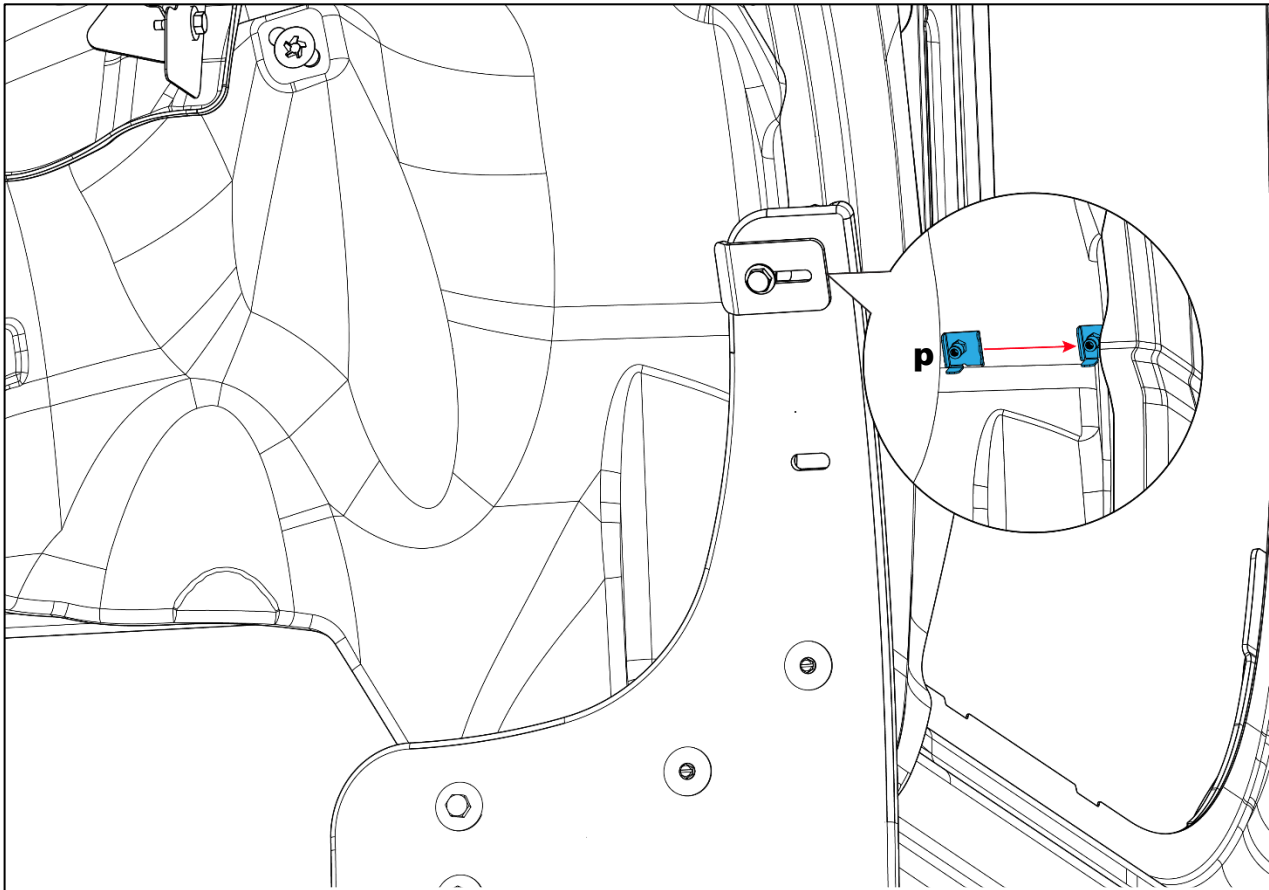

6-1

Slide the mount clip behind the fender lip as shown here to hold the mud flap in place while completing step 7-1

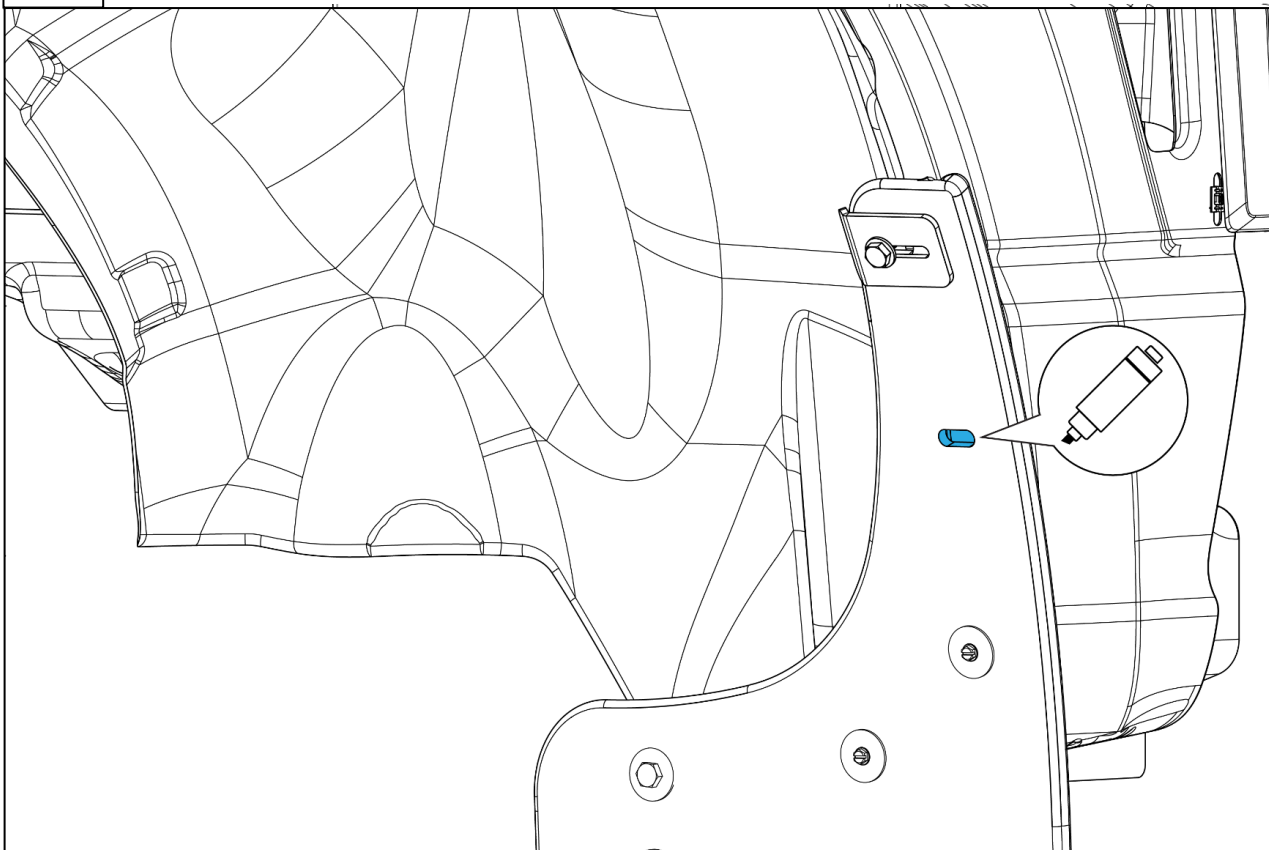

7-1

With the mud flap held tight to the fender lip, mark the fender through the remaining mud flap hole. This provides a guide for installing the protective tape and spring nut as shown in 7-2. Remove mount clip from fender lip.

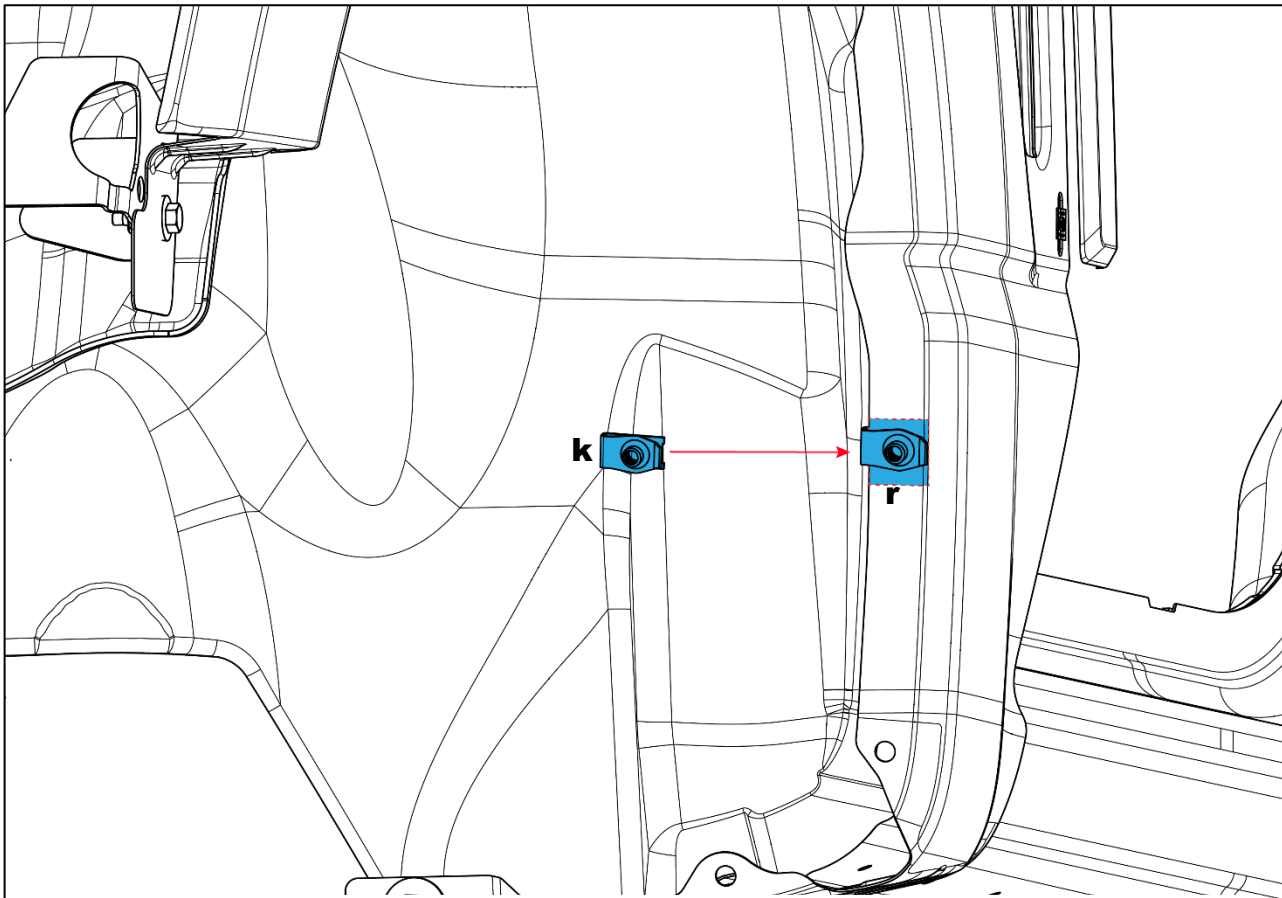

7-2

Install protective tape over the mark made in step 7-1, then install the spring nut over the tape.

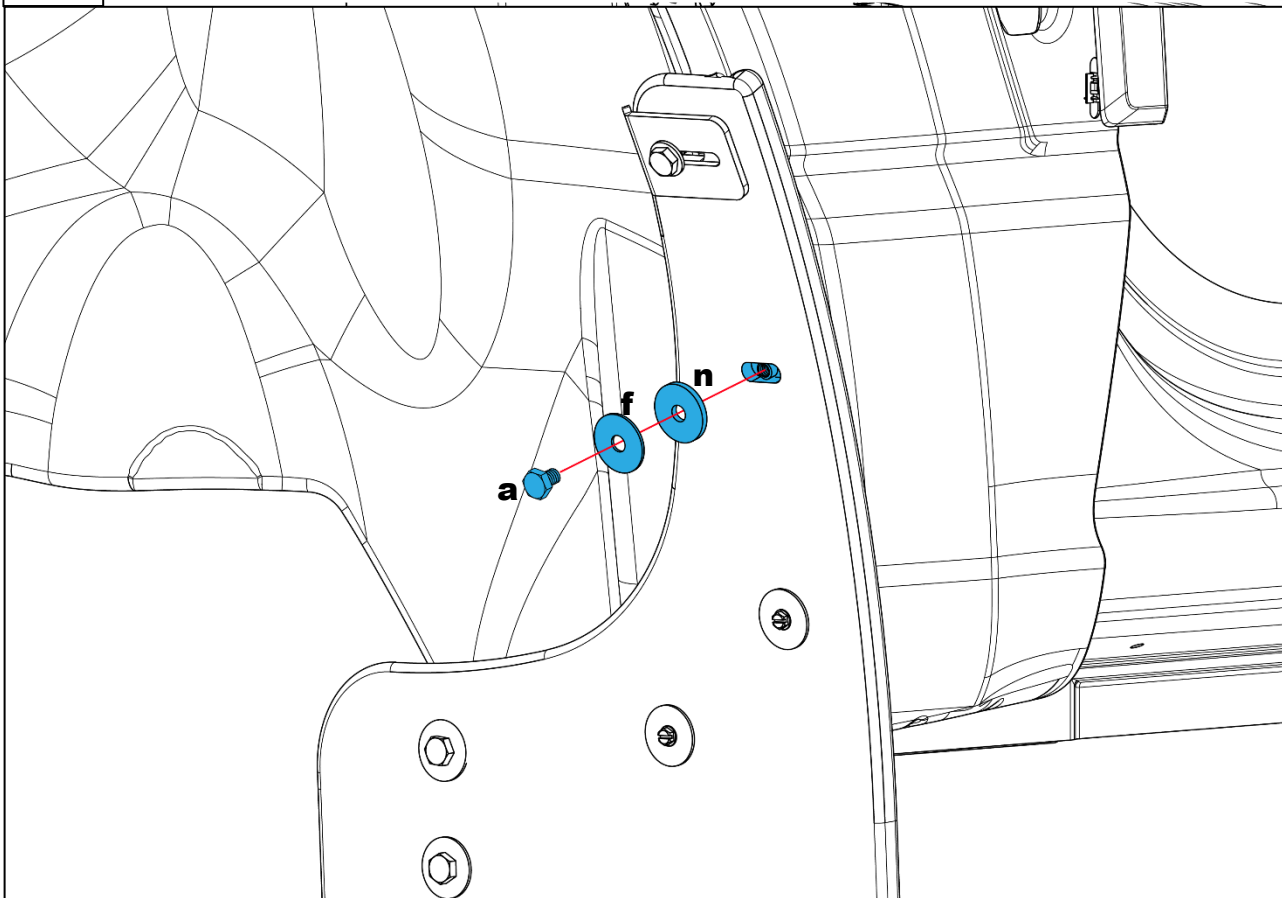

7-3

Slide the mount clip behind the fender lip and loosely secure. Next, install the hardware shown here into the spring nut installed in 7-2.

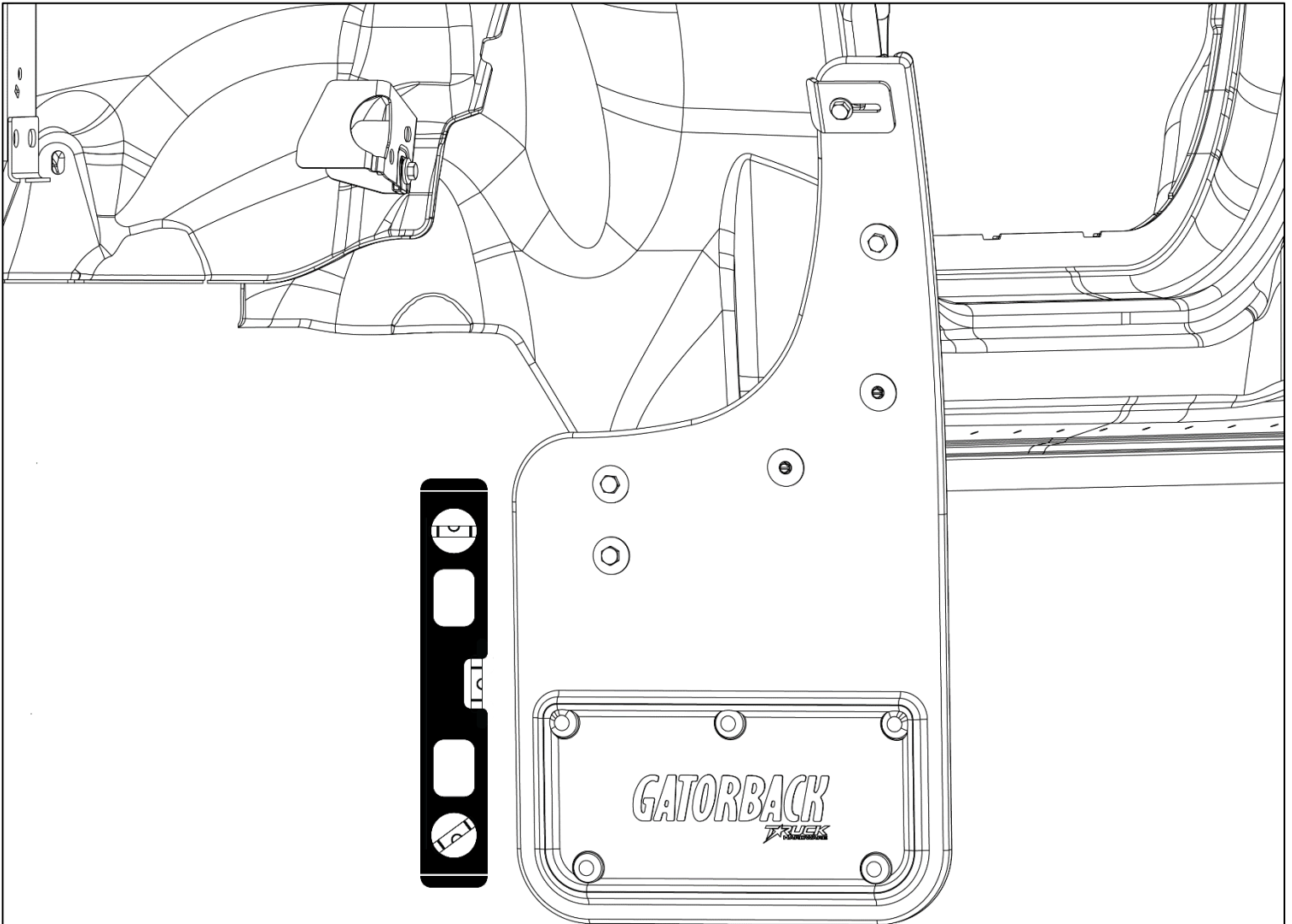

8-1 Use a level and visually determine your mud flap is straight. Gently tighten all fasteners.

Please check out our YouTube channel to see an install video for this application





Gatorback Mud Flaps by Truck Hardware Ltd.

LIMITED WARRANTY

All Ford part numbers provided by Truck Hardware Ltd. are warranted to be free from defects in materials or workmanship on products properly installed per the installation instructions provided with the product. This warranty covers repair or replacement of any defective product at no charge during the applicable warranty period listed below. Labor for replacement or service of defective product is not paid or reimbursed by Truck Hardware Ltd.

WARRANTY PERIOD		
	USA	Outside USA
Product which appears on New Vehicle Monroney Label (window sticker)	Coverage which matches new vehicle warranty---Ford - 3 years or 36,000 miles whichever comes first; Lincoln 4 years or 50,000 miles whichever comes first	Coverage which matches new vehicle warranty ---Ford - 3 years or 60,000 kilometers whichever comes first; Lincoln 4 years or 80,000 km whichever comes first
Part purchased and installed during or after the original vehicle warranty	Whichever of the following options provides the greater benefit to the customer: 1) 2 years / unlimited miles or 2) The remainder of the new vehicle warranty	Whichever of the following options provides the greater benefit to the customer: 1) 2 years / unlimited kilometers or 2) The remainder of the new vehicle warranty

This limited warranty does not cover any damage, defect or malfunction caused by misuse, abuse, accident, improper installation, modification or improper or lack of maintenance. Incidental and consequential damages are not recoverable under this warranty. This warranty offers you specific legal rights. You may have additional or other rights as which vary from state to state or province to province.

If you experience a warranty issue with this product please visit your Ford dealer. If the repair is covered by the warranty above and completed by the dealership, labor is also covered by Ford -- Ford Warranty and Policy – Section 3.

Please note that Truck Hardware Ltd. has replacement component parts available to assist consumers and dealers to resolve warranty and non-warranty issues as quickly as possible.

Note to dealer:

Ford dealers should contact Truck Hardware Ltd. by phone at 1-800-661-8208 and ask to speak to the warranty administrator or by email to: info@truckhardware.ca.