



GATORBACK

MUDFLAPS

2019-C Chevy Blazer

Mud Flap Set, Front

Mounting Diagram & Instructions

Kit# GCR201F

IMPORTANT:

Manufacturer is not responsible for negligent use of vehicle with mud flaps installed, including over-tightening of screws and bolts causing damage to vehicle or mud flaps.



TOOLS REQUIRED-

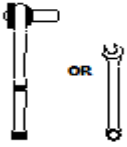

5/16" Open Wrench or
Socket Wrench

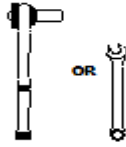

3/8" Open Wrench or
Socket Wrench

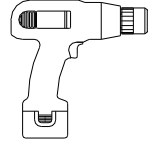

Electric or Rechargeable
Drill

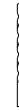

1/4" Drill
Bit

FLAPS

(1) Flap Assembly,
Front, DS

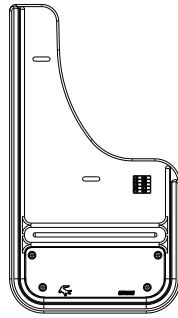

(1) Flap Assembly
Front, PS

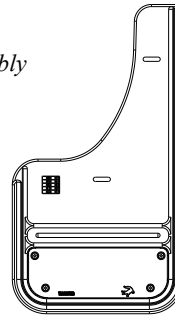

PARTS BAG # 768113

a) (4) Washer, Flat
0.203" x 1.5", 18GA, SS
Part #018066

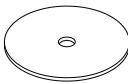

b) (4) Washer, Flat
0.203" x 0.781" 18ga, SS
Part #018018



c) (10) Washer, Flat
0.203" x 0.885" Nylon
Part # 054080



d) (2) Washer, Lock
18-8SS, Helicoil
Part #024001



e) (2) Screw, Mach.
18-8SS, 10-24x1, Hex Hd
Part # 012022



f) (2) Nut, Hex
#10-24, SS
Part # 025003



g) (4) Bolt, Hex Flange
M4.2 x 1" Black, SS
Part #016041

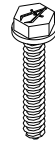

INSTALLATION (For ease of installation it is suggested that the wheel be removed)

1. Before you install your Mud Flap Set, see the diagram and parts list for all necessary parts. Start on the driver's side.
2. Remove 2 factory bolts from the fender
3. Secure flap through hole #2 to fender hole #5 using a stainless steel bolt (#016041), a stainless steel washer (#018066), and two nylon washers (#054080). Loosely secure at this point.

4. Secure flap through hole #1 to fender hole #4 using a stainless steel bolt (#016041), a stainless steel washer (#018066), and three nylon washers (#054080). Loosely secure at this point.
5. Using a bubble level or square, ensure that the mud flap is level. Viewing the vehicle from the back, the outer Edge of the mud flap should appear parallel to the tires.
6. Drill a 1/4" hole through the mud flap (#3) and liner (#6).
7. Secure the mud flap to the liner using a machine screw (#012022), two stainless steel washers (#018018), a lock washer (#024001) and a hex nut (#025003).
8. Carefully tighten all fasteners and ensure that the flap has remained level.
9. Repeat procedure for the passenger side.

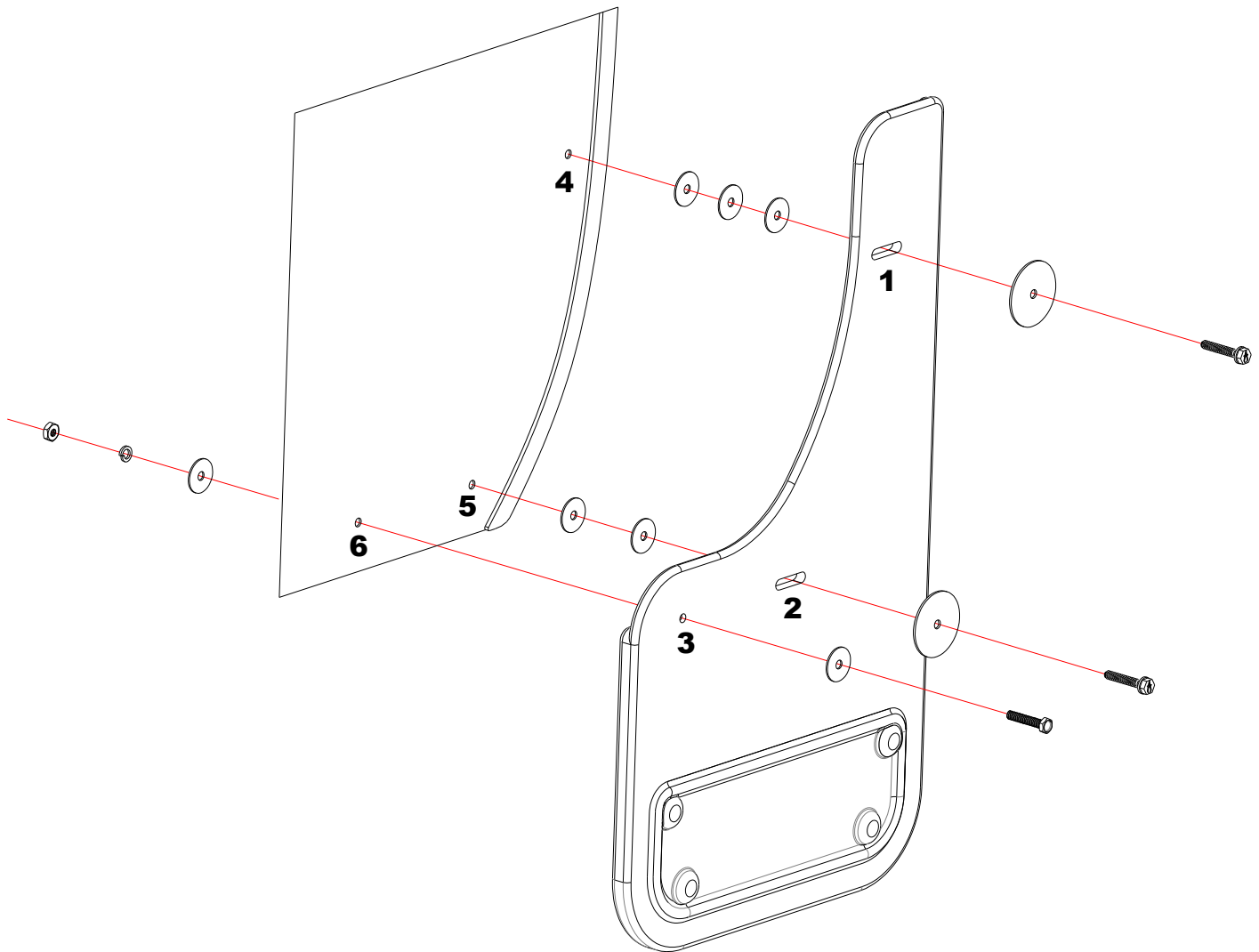

Please check out our YouTube channel to see an install video for this application.





2019-C Chevy Blazer

Mud Flap Set, Rear

Mounting Diagram & Instructions

Kit# GCR201R

IMPORTANT:

Manufacturer is not responsible for negligent use of vehicle with mud flaps installed, including over-tightening of screws and bolts causing damage to vehicle or mud flaps.



TOOLS REQUIRED-



5/16" Open Wrench or
Socket Wrench



3/8" Open Wrench or
Socket Wrench

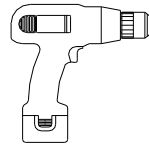

Electric or Rechargeable
Drill

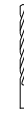

1/4" Drill
Bit

FLAPS

(1) Flap Assembly,
Front, DS

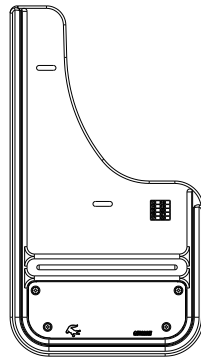

(1) Flap Assembly
Front, PS

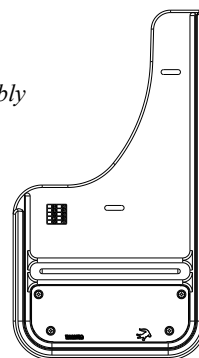

PARTS BAG # 768114

a) (2) Washer, Flat
0.203" x 1.5", 18GA, SS
Part #018066

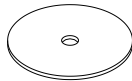

b) (4) Washer, Flat
0.203" x 0.781" 18ga, SS
Part #018018



c) (4) Washer, Flat
0.203" x 0.885" Nylon
Part # 054080



d) (2) Washer, Lock
18-8SS, Helicoil
Part #024001



e) (2) Screw, Mach.
18-8SS, 10-24x1, Hex Hd
Part # 012022

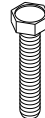

f) (2) Nut, Hex
#10-24, SS
Part # 025003

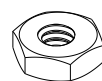

g) (4) Bolt, Hex Flange
M4.2 x 1" Black, SS
Part #016041

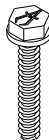

h) (2) Washer, Offset
0.203" x 1.5" SS
Part #018077

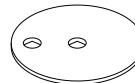

i) (2) Washer, Flat
5/16" x 1" x 1/4" HDPE
Part #018036



INSTALLATION (For ease of installation it is suggested that the wheel be removed)

- Before you install your Mud Flap Set, see the diagram and parts list for all necessary parts. Start on the driver's side.
- Remove 2 factory bolts from the fender holes #4 & #5.



3. Secure flap through hole #2 to fender hole #5 using a stainless steel bolt (#016041), a stainless steel washer (#018066), and a HDPE washer (#018036). Loosely secure at this point.
4. Secure flap through hole #1 to fender hole #4 using a stainless steel bolt (#016041), an offset washer (#018077), and two nylon washers. Loosely secure at this point.
5. Using a bubble level or square, ensure that the mud flap is level. Viewing the vehicle from the back, the outer Edge of the mud flap should appear parallel to the tires.
6. Drill a 1/4" hole through the mud flap (#3) and liner (#6).
7. Secure the mud flap to the liner using a machine screw (#012022), two stainless steel washers (#018018), a lock washer (#024001) and a hex nut (#025003).
8. Carefully tighten all fasteners and ensure that the flap has remained level.
9. Repeat procedure for the passenger side.

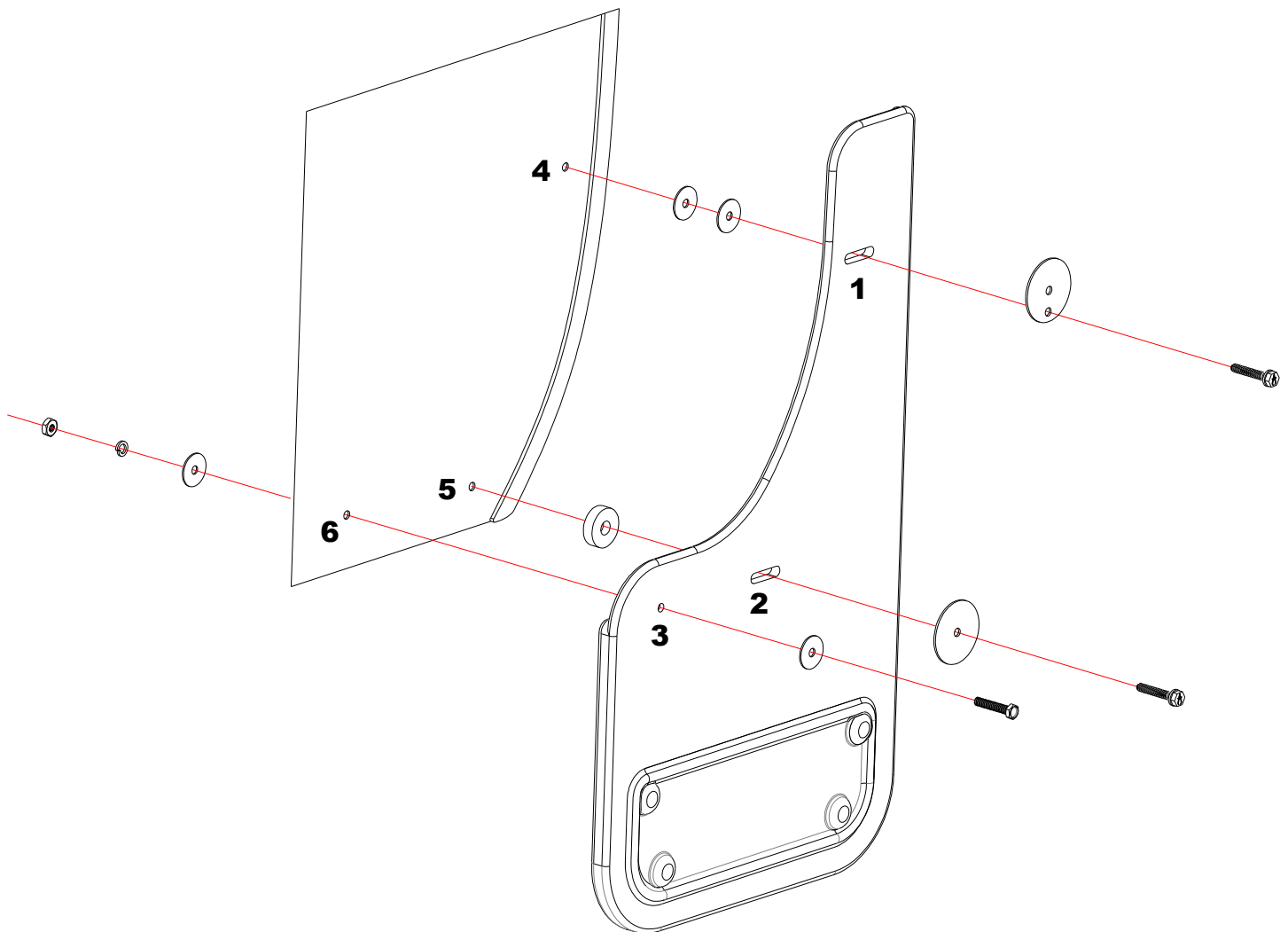

Please check out our YouTube channel to see an install video for this application.

