

IMPORTANT:

Manufacturer is not responsible for negligent use of vehicle with splash guard installed, including over-tightening of screws and bolts causing damage to vehicle or splash guards.

TOOLS REQUIRED-

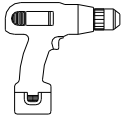

Electric or rechargeable
1/2" or 3/8" drill



3/8" Socket Driver

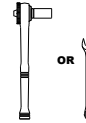

7/16" Open Wrench
or Socket Wrench



#15 Torque
Screwdriver

SPLASH GUARDS

a) (1) Splash Guard,
Rear, DS
Part #702229



b) (1) Splash Guard
Rear, PS
Part #702230



PARTS BAG # 750589

a) (6) Cap screw, SS
1/4" x 1"
Part #014007



b) (8) Washer, SS
0.281 x 1"
Part #018028



c) (2) Screw, Tek
1/4" x 1- 1/4"
Part # 010011



d) (3) Mount Clip, PS
w/ Clinch Nut
Part #750584
(to install on driver-side)

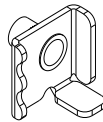

e) (3) Mount Clip, DS
w/ Clinch Nut
Part #750582
(to install on passenger-side)

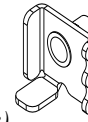

INSTALLATION (For ease of installation, it is suggested that the wheel be removed)

1. Before you install your Precision Splash Guard, see the diagram and parts list for all necessary parts. Cut the protective plastic and peel away from the stainless steel. Start on the driver's side.
2. Install each mount clip to the holes #1 to #3 with a cap screw and a flat washer, then tighten screws until the bottom tab of the mount clip just passes through the bottom of the slotted hole of holes #1 to #3.
3. Remove the factory screw on the wheel tub as shown on the diagram and reinstall the factory screw on holes #5 & #7, loosely secure at this point. Ensure the three installed mount clips are behind the factory wheel well
4. Square the splash guard with the tire while putting pressure against the wheel well. And tighten the factory screw on hole #5 & #7.

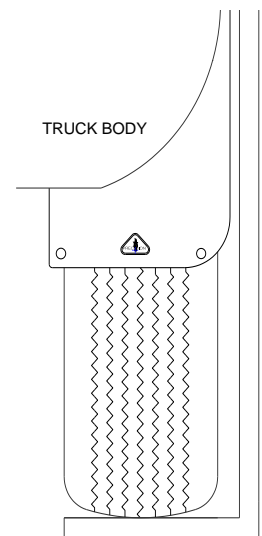

PASSENGER SIDE (RIGHT HAND) SHOWN
REAR VIEW OF THE VEHICLE

5. Secure the splash guard to the wheel by sliding each installed mount clip on hole #1 to #3 to the wheel well until mount clip's teeth are gripped behind the wheel well, then tighten the screws.
7. Repeat procedure for the passenger side.

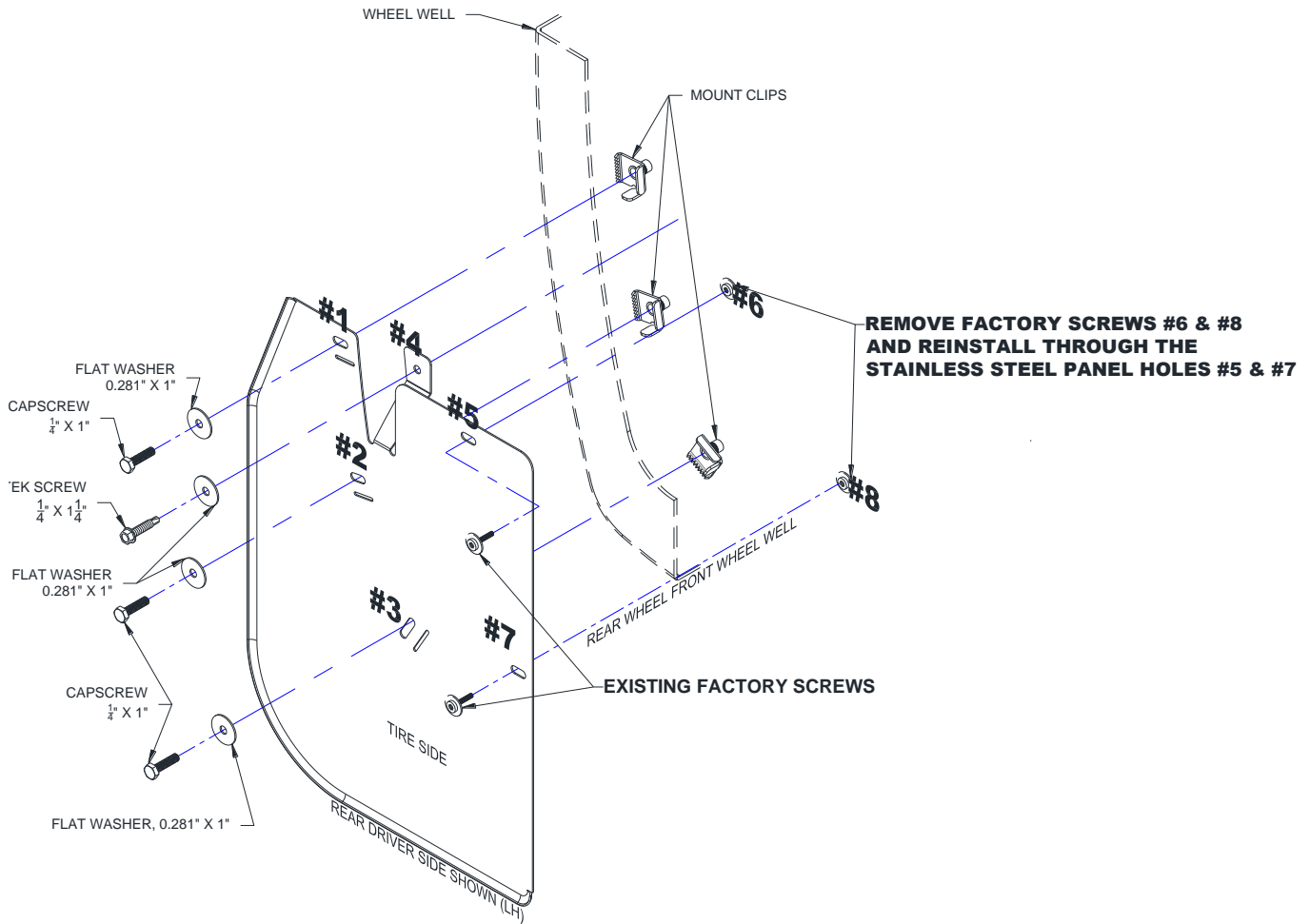

MAINTENANCE TIPS

Stainless Steel Care

Keeping your splash guards looking great requires proper care to be taken with your stainless steel - the same care that you would take to look after the paint on your truck. High amounts of salt will deteriorate even the finest stainless steel if it is continuously abused. Wash the stainless steel on your splash guards from time to time to remove any road grime or salt. To shine, use window cleaner to remove any spots or streaks.

***Precision Splash Guards
are manufactured with the finest stainless steel fasteners.***

With proper maintenance and cleaning, your splash guards will look great for years to come!