



# 2019-24 Ford Edge Mud Flap Set, Front Mounting Diagram & Instructions

## IMPORTANT:

**Manufacturer is not responsible for negligent use of vehicle with mud flaps installed, including over-tightening of screws and bolts causing damage to vehicle or mud flaps.**



## TOOLS REQUIRED-

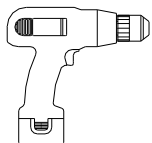

*Electric or Rechargeable  
Drill*



*1/4" Drill Bit*



*Push Pin Removal Tool*

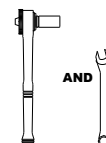

*5/16" and 3/8" Open and  
Socket Wrench*

## FLAPS & BRACKETS

*(1) Flap Assembly,  
Front, DS*

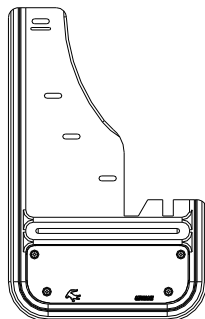

*(1) Flap Assembly  
Front, PS*

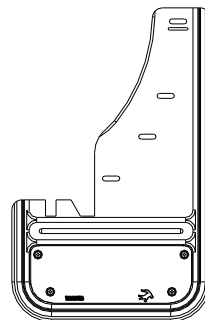

## PARTS BAG # 767571

**a)** (2) Screw, Machine  
SS, #18-8, 10-24 x 1" Hex  
Part #012022

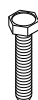

**b)** (8) Screw, Sht Metal  
1/4" Hex Washer Head #8-15 x 1" Blk  
Part #016057



**c)** (4) Washer, Flat  
0.203" x 0.781", SS  
Part #018018



**d)** (8) Washer, Flat  
0.203" x 1.5", Blk Ox. SS.  
Part #018072

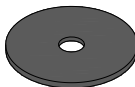

**e)** (2) Washer, Lock  
18-8SS, 10 Helicoil  
Part #024001



**f)** (2) Nut, Hex  
SS, #10-24  
Part # 025003



**g)** (6) Spring Nut  
#28, 9/16" Reach  
Part # 028004



**h)** (1) Mud Flap Clip  
Driver's Side  
Part #767324

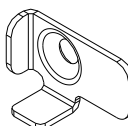

**i)** (1) Mud Flap Clip  
Passenger's Side  
Part #767325

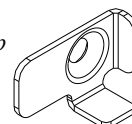

## INSTALLATION *(For ease of installation it is suggested that the wheel be removed)*

1. Before you install your Mud Flap Set, see the diagram and parts list for all necessary parts.
2. Remove the (3) factory push pins on the inside of the fender on holes #1 to #3.
3. Remove the factory push pin on the underside of the fender on hole #4 in order to pull back the plastic guard and inner liner to reveal the factory holes that contained the factory push pins.
4. Install the (3) spring nuts onto each of the (3) factory holes #1 to #3. (See Diagram #2).
5. Cut small rectangle out of fabric liner as shown in Diagram #1 to allow the mud flap to sit higher in the wheel well. (Cut parallel to the weld to ensure the metal body is not exposed).
6. Move plastic guard back into place and reinstall the factory push pin on the underside of the fender.
7. Ensuring that the mud flap ear is behind the liner (See Diagram #1), loosely install the mud flap through holes #1 to #3 to the inner fender through holes #5 to #7 using (3) black screws (016057) and (3) black washers (018072).
8. On the top mud flap hole #8, install mud flap clip using a black screw (016057) and a black washer (018072) so the clip pinches the fender and the flap together.
9. With a square or other levelling tool, ensure that the flap is level.
10. Carefully tighten all screws and double-check that the flap has remained level.
11. With a 1/4" drill bit, drill through mud flap and liner to create holes #9 & #10.
12. Install inner mud flap hole #9 to liner through hole #10 using a machine screw (012022) and stainless steel washer (018018). Secure using a stainless steel washer (018018), lock washer (024001), and hex nut (025003).
13. Repeat procedure for the passenger side.

**Diagram #1**

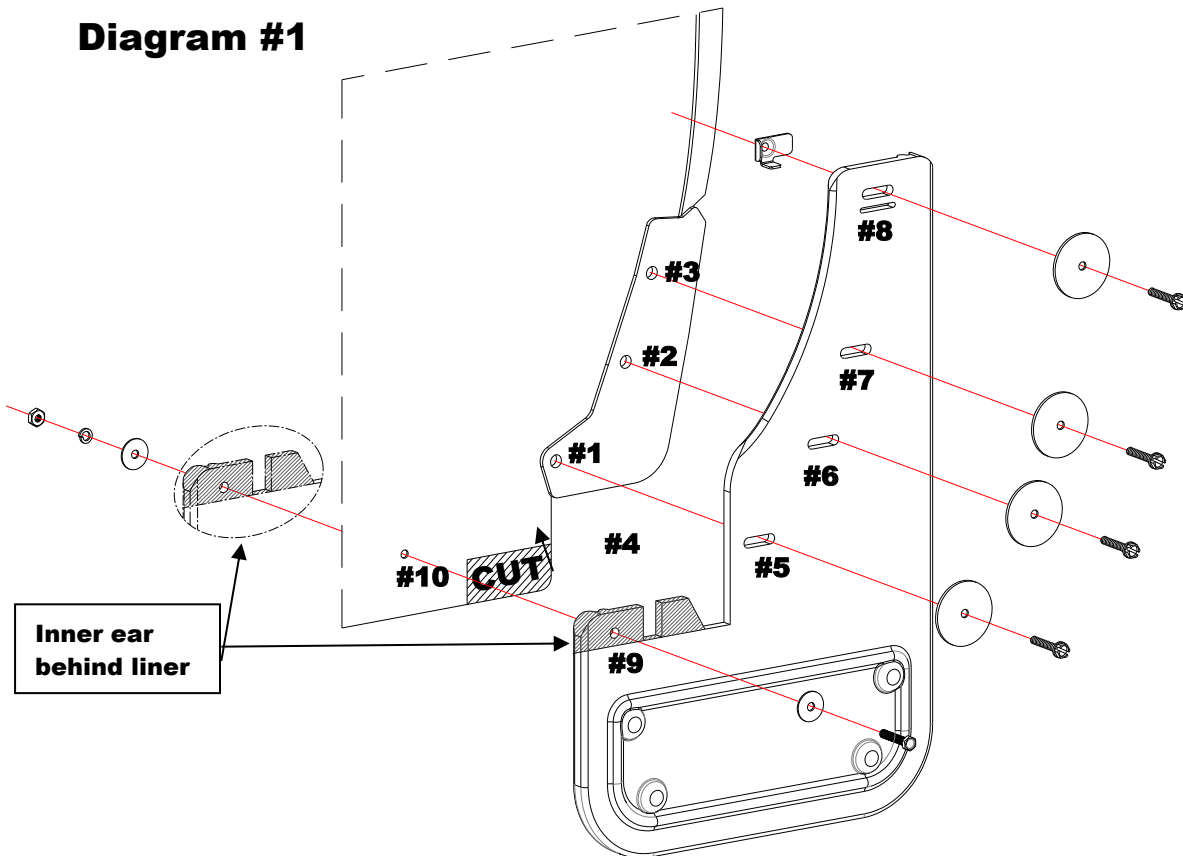

**Diagram #2**

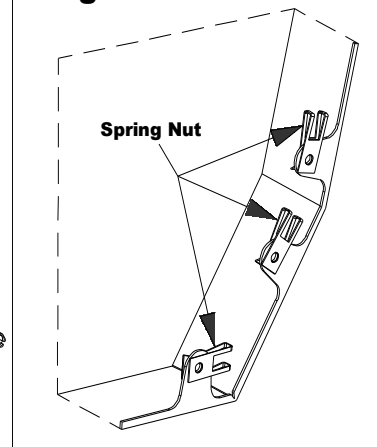

Please check out our YouTube channel to see an install video for this application





## 2019-24 Ford Edge Mud Flap Set, Rear Mounting Diagram & Instructions

### IMPORTANT:

**Manufacturer is not responsible for negligent use of vehicle with mud flaps installed, including over-tightening of screws and bolts causing damage to vehicle or mud flaps.**



### TOOLS REQUIRED-

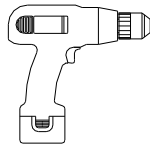

Electric or re-chargeable  
Drill



1/4" Drill Bit

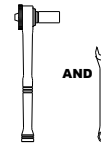

5/16" and 3/8" Socket  
and Open Wrench

### FLAPS

(1) Flap Assembly,  
Rear, DS

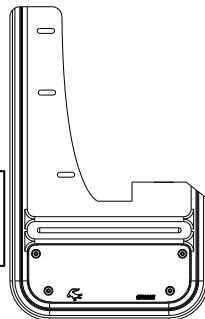

(1) Flap Assembly  
Rear, PS

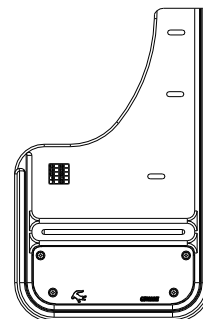

**\*Note\*** Driver side is cut  
differently to accommodate  
difference in wheel well liner

### PARTS BAG # 767572

**a)** (2) Screw, Machine SS  
#10-24 x 1.75" Hex  
Part #012047

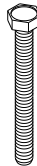

**b)** (6) Screw, Sht Metal  
1/4" Hex Washer Head, #8-18 x 1", Blk  
Part #016055

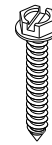

**c)** (4) Washer, Flat  
0.203" x 0.781" 20g SS  
Part #018018



**d)** (6) Washer Flat  
0.203" x 1.5" Blk Ox.  
Part #018072



**e)** (2) Washer, Lock  
18-8SS, 10 Helicoil  
Part #024001



**f)** (2) Nut, Hex  
SS, #10-24  
Part #025003



**g)** (8) Washer, Flat  
0.203" x 0.885, Nylon, Blk  
Part #054080



**h)** (2) Spacer, Nylon  
1/4" x 1/2" x 7/8"  
Part #054082



**i)** (2) Washer, Flat, HDPE  
5/16" x 1" x 1/4"  
Part #018036



### INSTALLATION (For ease of installation it is suggested that the wheel be removed)

- Before you install your Mud Flap Set, see the diagram and parts list for all necessary parts. Start on the driver's side.
- Remove the 3 factory screws on the inner fender from holes #1 to #3

3. Determine the size of spacer required to allow flap to sit flush with fender (either HDPE spacer 018036 or the thinner nylon spacer 054080).
4. Loosely install the mud flap through holes #4 to #6 into the factory holes #1 to #3 using (3) black screws (016055) and (3) black washers (018072). (See Diagram)  
**\*\*Note\*\*** On driver's side, ensure that the mud flap ear is behind the liner
5. With a square or other levelling tool, ensure that the flap is level.
6. Carefully tighten all screws and double-check that the flap has remained level.
7. Drill a 1/4" hole through mud flap and liner to create holes #7 and #8.
8. Install mud flap through hole #7 to liner hole #8 using a screw (012047) and washer (018018), installing a spacer (054082) between the flap and liner. Secure to liner with a washer (018018), lock washer (024001), and hex nut (025003).
9. Repeat the procedure on the passenger side.

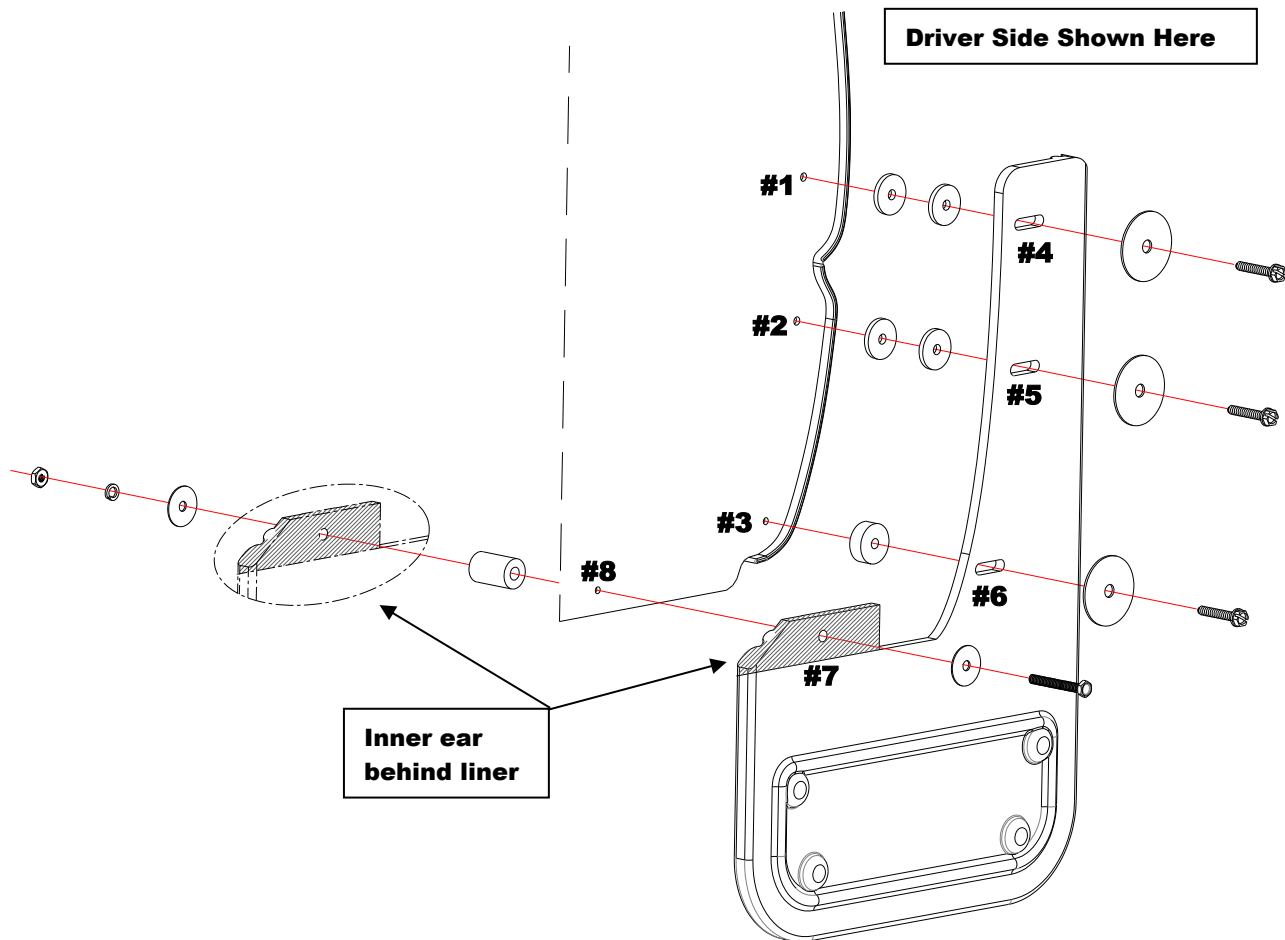

Please check out our YouTube channel to see an install video for this application.





## Gatorback Mud Flaps by Truck Hardware Ltd.

# LIMITED WARRANTY

All Ford part numbers provided by Truck Hardware Ltd. are warranted to be free from defects in materials or workmanship on products properly installed per the installation instructions provided with the product. This warranty covers repair or replacement of any defective product at no charge during the applicable warranty period listed below. Labor for replacement or service of defective product is not paid or reimbursed by Truck Hardware Ltd.

| WARRANTY PERIOD  |  |   |
|--|--|---|
|  | USA  | Outside USA   |
| Product which appears on New Vehicle Monroney Label (window sticker)       | Coverage which matches new vehicle warranty---Ford - 3 years or 36,000 miles whichever comes first; Lincoln 4 years or 50,000 miles whichever comes first              | Coverage which matches new vehicle warranty ---Ford - 3 years or 60,000 kilometers whichever comes first; Lincoln 4 years or 80,000 km whichever comes first                |
| Part purchased and installed during or after the original vehicle warranty | Whichever of the following options provides the greater benefit to the customer:<br>1) 2 years / unlimited miles<br>or<br>2) The remainder of the new vehicle warranty | Whichever of the following options provides the greater benefit to the customer:<br>1) 2 years / unlimited kilometers<br>or<br>2) The remainder of the new vehicle warranty |

This limited warranty does not cover any damage, defect or malfunction caused by misuse, abuse, accident, improper installation, modification or improper or lack of maintenance. Incidental and consequential damages are not recoverable under this warranty. This warranty offers you specific legal rights. You may have additional or other rights as which vary from state to state or province to province.

If you experience a warranty issue with this product please visit your Ford dealer. If the repair is covered by the warranty above and completed by the dealership, labor is also covered by Ford -- Ford Warranty and Policy – Section 3.

Please note that Truck Hardware Ltd. has replacement component parts available to assist consumers and dealers to resolve warranty and non-warranty issues as quickly as possible.

Note to dealer:

Ford dealers should contact Truck Hardware Ltd. by phone at 1-800-661-8208 and ask to speak to the warranty administrator or by email to: [info@truckhardware.ca](mailto:info@truckhardware.ca)