



2019-C Ford Edge Mud Flap Set, Front Mounting Diagram & Instructions Kit# GCR401F

IMPORTANT:

Manufacturer is not responsible for negligent use of vehicle with mud flaps installed, including over-tightening of screws and bolts causing damage to vehicle or mud flaps.



TOOLS REQUIRED-



Push Pin Removal Tool
Socket Wrench

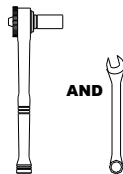

5/16" and 3/8" Open and
Drill

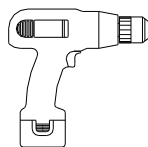

Electric or Rechargeable
Drill



1/4" Drill Bit

FLAPS & BRACKETS

(1) Flap Assembly,
Front, DS

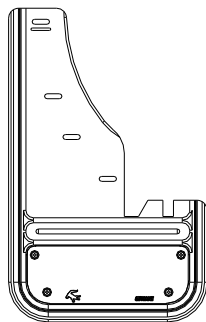

(1) Flap Assembly
Front, PS

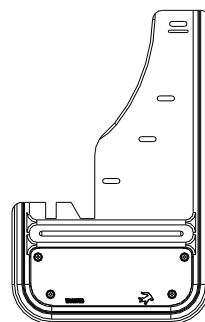

PARTS BAG # 767571

a) (2) Screw, Machine
SS, #18-8, 10-24 x 1" Hex
Part #012022



b) (8) Screw, Sht Metal
1/4" Hex Washer Head #8-15 x 1" Blk
Part #016057



c) (4) Washer, Flat
0.203" x 0.781", SS
Part #018018



d) (8) Washer, Flat
0.203" x 1.5", Blk Ox. SS.
Part #018072

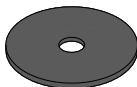

e) (2) Washer, Lock
18-8SS, 10 Helicoil
Part #024001



f) (2) Nut, Hex
SS, #10-24
Part #025003



g) (6) Spring Nut
#28, 9/16" Reach
Part #028004

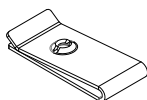

h) (1) Mud Flap Clip
Driver's Side
Part #767324

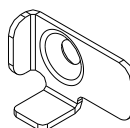

i) (1) Mud Flap Clip
Passenger's Side
Part #767325

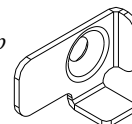

INSTALLATION *(For ease of installation it is suggested that the wheel be removed)*

1. Before you install your Mud Flap Set, see the diagram and parts list for all necessary parts.
2. Remove the (3) factory push pins on the inside of the fender on holes #1 to #3.
3. Remove the factory push pin on the underside of the fender on hole #4 in order to pull back the plastic guard and inner liner to reveal the factory holes that contained the factory push pins.
4. Install the (3) spring nuts onto each of the (3) factory holes #1 to #3. (See Diagram #2).
5. Cut small rectangle out of fabric liner as shown in Diagram #1 to allow the mud flap to sit higher in the wheel well. (Cut parallel to the weld to ensure the metal body is not exposed).
6. Move plastic guard back into place and reinstall the factory push pin on the underside of the fender.
7. Ensuring that the mud flap ear is behind the liner (See Diagram #1), loosely install the mud flap through holes #1 to #3 to the inner fender through holes #5 to #7 using (3) black screws (016057) and (3) black washers (018072).
8. On the top mud flap hole #8, install mud flap clip using a black screw (016057) and a black washer (018072) so the clip pinches the fender and the flap together.
9. With a square or other levelling tool, ensure that the flap is level.
10. Carefully tighten all screws and double-check that the flap has remained level.
11. With a 1/4" drill bit, drill through mud flap and liner to create holes #9 & #10.
12. Install inner mud flap hole #9 to liner through hole #10 using a machine screw (012022) and stainless steel washer (018018). Secure using a stainless steel washer (018018), lock washer (024001), and hex nut (025003).
13. Repeat procedure for the passenger side.

Diagram #1

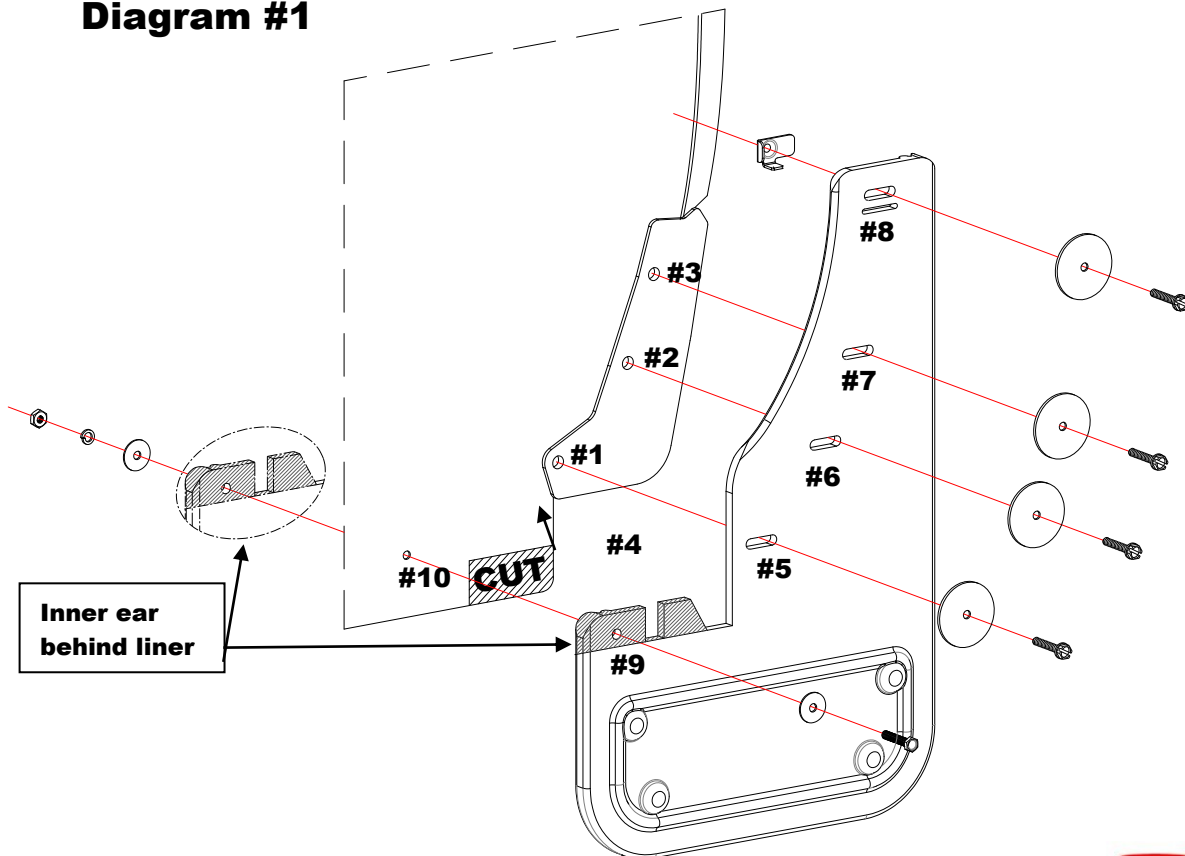
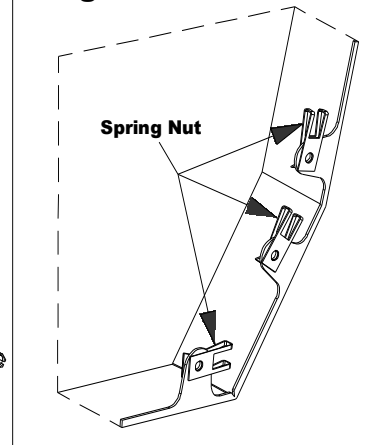

Diagram #2



Please check out our YouTube channel to see an install video for this application



1520 - 33 St N • Lethbridge, AB T1H 5H3 • Canada
Toll free: 1-800-661-8208 • Email: info@truckhardware.ca • www.truckhardware.ca



IMPORTANT:

Manufacturer is not responsible for negligent use of vehicle with mud flaps installed, including over-tightening of screws and bolts causing damage to vehicle or mud flaps.

TOOLS REQUIRED-

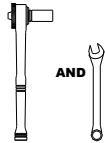

5/16" and 3/8" Socket
and Open Wrench

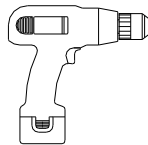

Electric or re-chargeable
Drill



1/4" Drill Bit

FLAPS

(1) Flap Assembly,
Front, DS

Note Driver side is cut
differently to accommodate
difference in wheel well liner

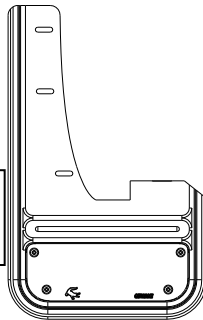

(1) Flap Assembly
Front, PS

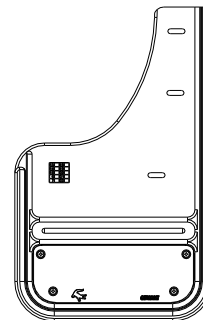

PARTS BAG # 767572

a) (2) Screw, Machine SS
#10-24 x 1.75" Hex
Part #012047

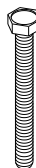

b) (6) Screw, Sht Metal
1/4" Hex Washer Head, #8-18 x 1", Blk
Part #016055

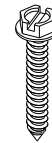

c) (4) Washer, Flat
0.203" x 0.781" 20g SS
Part #018018



d) (6) Washer Flat
0.203" x 1.5" Blk Ox.
Part #018072

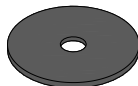

e) (2) Washer, Lock
18-8SS, 10 Helicoil
Part #024001



f) (2) Nut, Hex
SS, #10-24
Part #025003



g) (8) Washer, Flat
0.203" x 0.885, Nylon, Blk
Part #054080

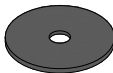

h) (2) Spacer, Nylon
1/4" x 1/2" x 7/8"
Part #054082



i) (2) Washer, Flat, HDPE
5/16" x 1" x 1/4"
Part #018036



INSTALLATION (For ease of installation it is suggested that the wheel be removed)

- Before you install your Mud Flap Set, see the diagram and parts list for all necessary parts. Start on the driver's side.
- Remove the 3 factory screws on the inner fender from holes #1 to #3

3. Determine the size of spacer required to allow flap to sit flush with fender (either HDPE spacer 018036 or the thinner nylon spacer 054080).
4. Loosely install the mud flap through holes #4 to #6 into the factory holes #1 to #3 using (3) black screws (016055) and (3) black washers (018072). (See Diagram)
****Note**** On driver's side, ensure that the mud flap ear is behind the liner
5. With a square or other levelling tool, ensure that the flap is level.
6. Carefully tighten all screws and double-check that the flap has remained level.
7. Drill a 1/4" hole through mud flap and liner to create holes #7 and #8.
8. Install mud flap through hole #7 to liner hole #8 using a screw (012047) and washer (018018), installing a spacer (054082) between the flap and liner. Secure to liner with a washer (018018), lock washer (024001), and hex nut (025003).
9. Repeat the procedure on the passenger side.

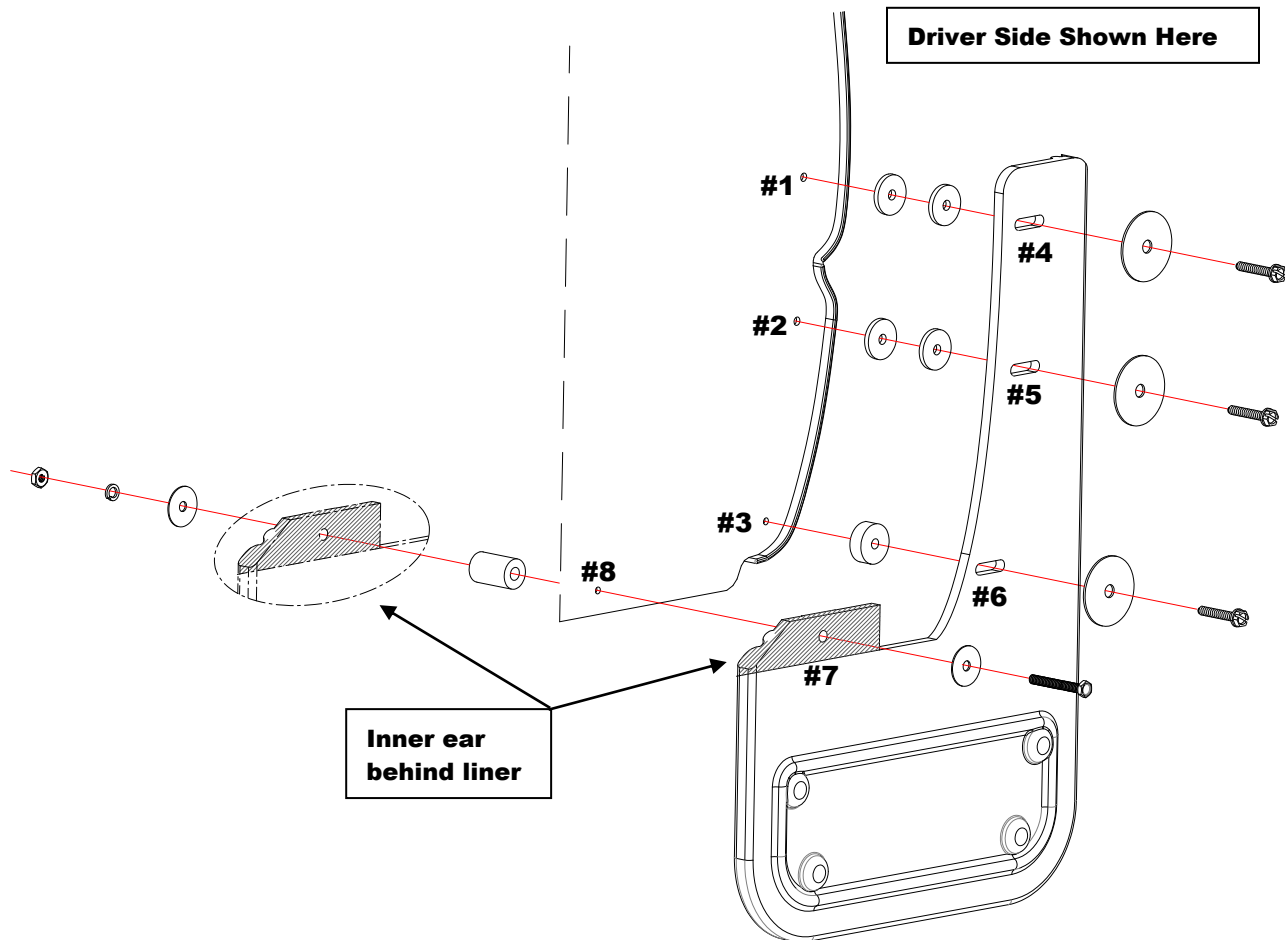

Please check out our YouTube channel to see an install video for this application.



1520 - 33 St N • Lethbridge, AB T1H 5H3 • Canada
Toll free: 1-800-661-8208 • Email: info@truckhardware.ca • www.truckhardware.ca

