

Optional 4th piece available for Transfer Case  
(Sold Separately) - P700390

**\*will not fit Powerboost/Hybrid/Lightning**

**FRONT:**

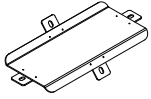

(1) Access Door  
Part #702523

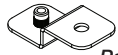

(2) Z Bracket  
Part #702244

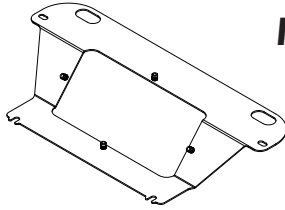

(1) Front Skid Plate  
Part #702521

**MIDDLE:**

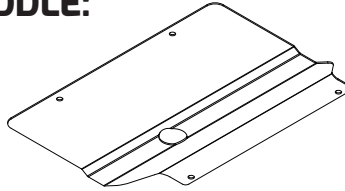

(1) Middle Skid Plate  
Part #702524

**REAR:**

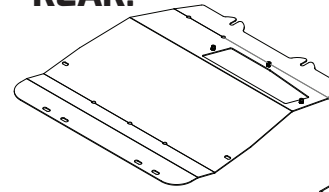

(1) Rear Skid Plate  
Part #702478

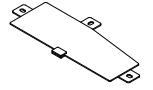

(1) Access Door  
Part #702480

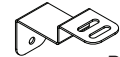

(2) Z Bracket  
Part #702468

**PARTS BAG 1: #702525**



(2) Spring Nut  
3/8"

Part #028007



(2) Capscrew  
3/8" x 1.5"

Part #014012



(6) Capscrew  
3/8" x 1"

Part #014042



(8) Lock Washer  
3/8"

Part #024006



(8) Flat Washer  
3/8"

Part #018046

**PARTS BAG 2: #702475**



(4) Capscrew  
3/8" x 1"

Part #014042



(4) Lock Washer  
3/8"

Part #24006



(4) Flat Washer  
3/8"

Part #18046



(4) Spring Nut  
3/8"

Part #028007

**PARTS BAG 3: #702482**



(2) Capscrew  
3/8" x 1.5"

Part #014012



(1) T-Bolt

Part #762236



(2) Spring Nut  
3/8"

Part #028007



(3) Capscrew  
3/8" x 1"

Part #014042



(6) Lock Washer  
3/8"

Part #024006



(6) Flat Washer  
3/8"

Part #018046



(1) Hex Nut  
3/8"

Part #025015



(3) Capscrew  
5/16" x 1"

Part #014022



(3) Spring Nut  
5/16"

Part #028005



(3) Flat Washer  
5/16"

Part #018047



(3) Lock Washer  
5/16"

Part #024002

**INSTALLATION INSTRUCTIONS**

1. Before getting started, please see above information & ensure all of the parts are accounted for. If parts are missing, please contact your supplier immediately.

## INSTALLATION INSTRUCTIONS

\*Please note that there is an optional 4th piece that covers the Transfer Case. This item is sold separately but must be used in conjunction with this kit (Part # P700390).

1. Before you install your F150 Skid Plate, see diagram & parts list to ensure all parts are accounted for.
2. Remove all factory felt liners & metal skid plates that are attached to the 1st & 2nd cross members. Depending on the engine your truck has, there will be different covers.

For the 2.7L, 3.3L & 3.5L engine, please remove these:

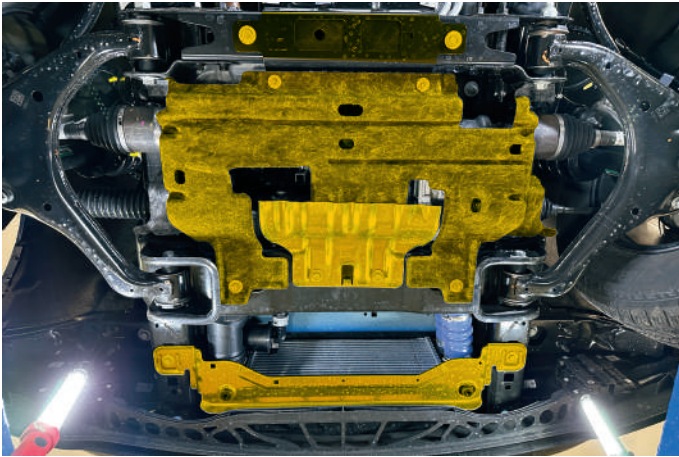

For the 5.0L V8 - please remove these:



\* Please note: Due to these differences, additional hardware has been included so that the installation is the same. This means that you may have extra hardware when the install is complete.

3. With the guards removed, you should see this...

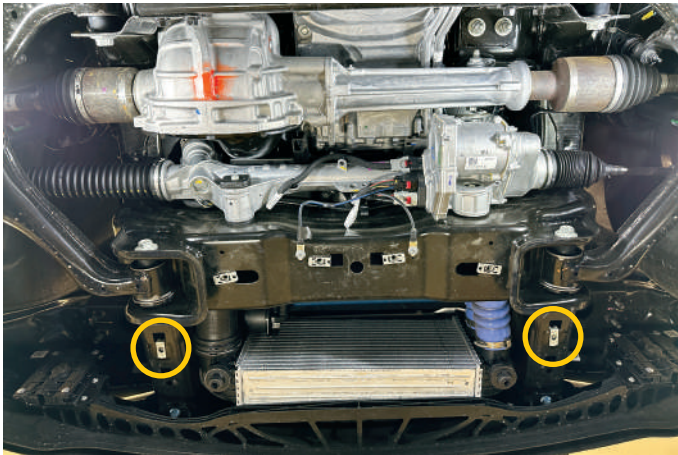

**2.7L, 3.3L & 3.5L**

\*Use existing factory spring nuts



**5.0L**

\*You will need to add provided spring nuts here



4. Install the "Z" brackets (702244) to the spring nuts highlighted in Step 3 using 3/8" x 1" capscrew, lock washer & flat washer.

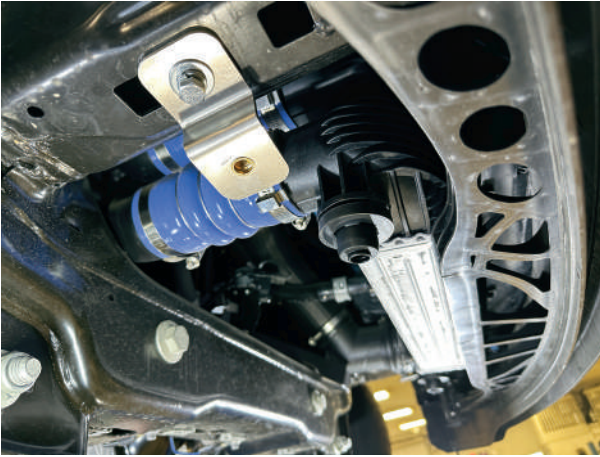

5. Position the front piece so that the holes on the skid plate line up with the clinch nuts on the previously installed "Z" bracket. Secure the plate using 3/8" x 1.5" cap screw, lock washer & flat washer.



6. Next, slide the 2nd skid plate piece above the rear of the front piece. Using the front to hold up the 2nd piece, move to the back of the 2nd piece & use a 3/8" x 1" cap screw, lock washer & flat washer to secure it to the factory spring nuts in the middle cross member. *\*Reminder - install loosely so the 3rd piece can slide above the 2nd piece.*





7. Next, ensure the holes on the front of plate #2 line up with the rear of the first piece. Loosely secure these pieces together using a 3/8" x 1" cap screw, lock washer & flat washer.

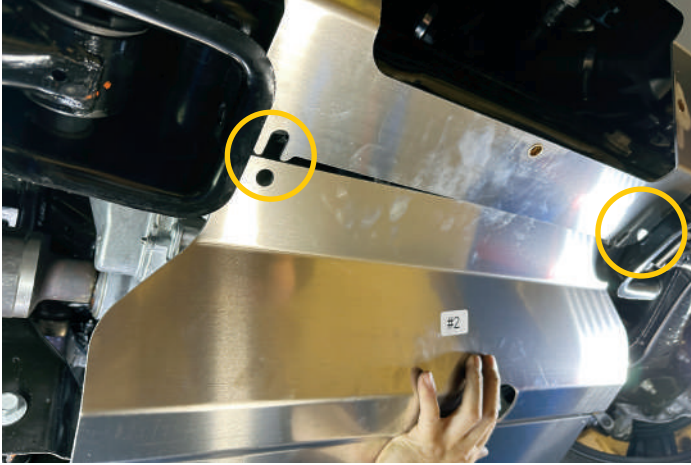

8. There is a little preparation that needs to be done for the 3rd piece. First, you will need to install 2 x 5/16" spring nuts on to the sides of the skid plate. \*This is easier to do before the piece is installed.

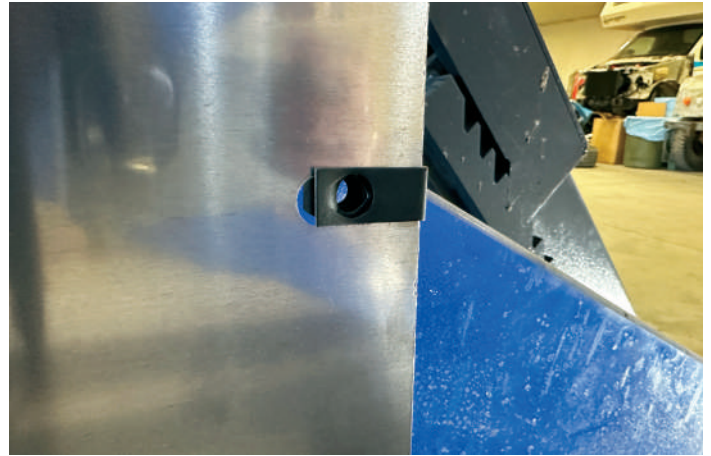
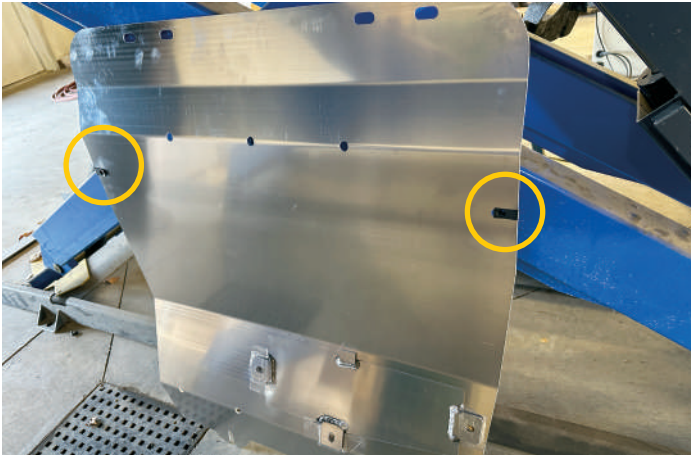

9. Next, install a 5/16" spring nut & T-bolt into the rear cross member as shown below. The spring nut goes on the drivers side & the T-bolt goes on the passenger side.

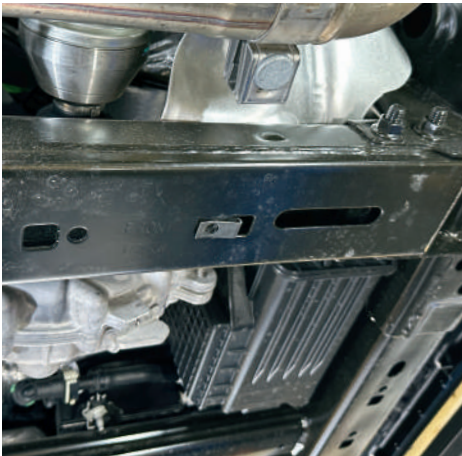

DRIVER SIDE



PASSENGER SIDE



PASSENGER SIDE



10. Finally, slide the 3rd piece in above the rear of the 2nd piece & loosely secure the rear by installing 5/16" x 1" cap screw, lock washer & flat washer into the spring nut installed in Step 9. Secure the skid plate to the previously installed T-bolt using 3/8" flat washer, lock washer & hex nut.



11. Next, install 3/8" spring nuts on each side of the frame as shown.



12. Loosely install "Z" bracket (702468) to the spring nuts installed in Step 11 using 3/8" x 1 1/2" cap screw, lock washer & flat washer. Leave everything slightly loose to allow for adjustment once install is complete.



Check out our YouTube channel for install video

[www.truckhardware.ca](http://www.truckhardware.ca)





13. Loosely install the skid plate to the support brackets using 5/16" cap screw, lock washer & flat washer.

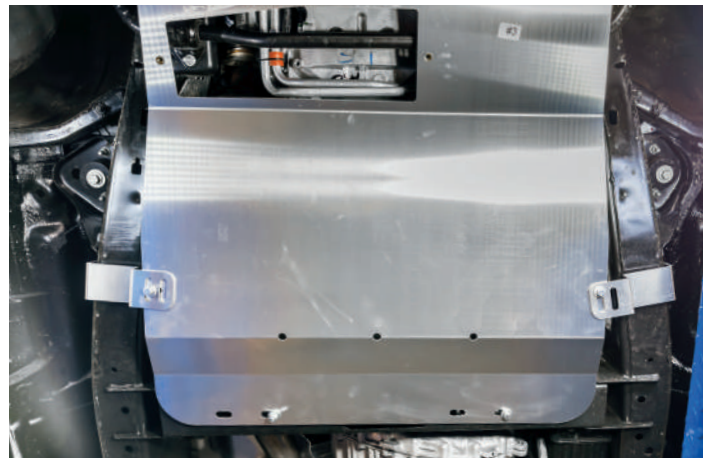

14. Once completed, go through all attachment points & tighten all fasteners.

15. Lastly, fasten the mount tabs on the access doors to the clinch nuts on the skid plate on pieces 1 & 3 with the 3/8" cap screws, lock washer & flat washer.

