



**2017-2022 Nissan Titan
Mud Flap Set, Front
Mounting Diagram & Instructions
GCR51F**

766033 / 766035 / 766037 / 766039 / 766468 / 766472 / 766474

IMPORTANT:

Manufacturer is not responsible for negligent use of vehicle with mud flaps installed, including over-tightening of screws and bolts causing damage to vehicle or mud flaps.



TOOLS REQUIRED-



Phillips Screw Driver



#2 Robertson Screw Driver

FLAPS

*(1) Flap Assembly,
Front, DS*

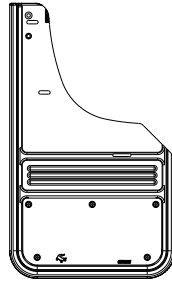

*(1) Flap Assembly
Front, PS*

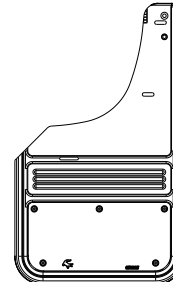

PARTS BAG # 766023

a) (4) Washer, Flat
0.281" x 1" x 18ga, SS
Part #018028



b) (2) Washer, Nylon
0.318" x 1" x 0.04"
Part #054061



c) (4) Screw, SS
#10-12 x 1-1/4"
Part #010017



c) (2) Front Brace
Part #766020

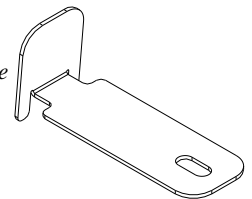

INSTALLATION *(For ease of installation it is suggested that the wheel be removed)*

1. Before you install your Mud Flap Set, see the diagram and parts list for all necessary parts. Cut the protective plastic and peel away from the stainless steel. Start on the driver's side.
2. Remove the factory splash guard.
3. Install the stainless steel brace through the rubber mud flap hole #3 (see diagram).
4. Install the rubber mud flap and brace using the included fasteners (see diagram). Loosely secure at this point.

5. Push the brace up against the flap until the bottom of the flap is paralleled to the tire, then tighten the factory screw on hole #7.
6. Square the mud flap with the tire, and tighten all fasteners.
7. Repeat the procedure on the passenger side.

Please note that the screws provided with this kit are intended for use on vehicles with flares. While they can be utilized for vehicles without flares as well, the original factory screws can also be used in this case.

REMOVE THESE TWO FACTORY SCREWS AND REPLACE WITH THE SUPPLIED SS SCREWS & SS WASHERS THROUGH THE RUBBER MUD FLAP ON HOLES #1 & #2

REMOVE THIS FACTORY SCREW UNDERNEATH THE WHEEL FENDER AND REINSTALL WITH A NYLON WASHER THROUGH THE SS BRACE ON HOLE #7

